

ITEM 14. GEORGE STREET SYDNEY - REQUEST FOR TEMPORARY FULL ROAD CLOSURE – CRANE OPERATION**FILE NO: S056209****RECOMMENDATION**

It is recommended that the Committee raise no objection to the proposed temporary full road closure of George Street between King Street and Market Street between the hours of 9pm-5am on:-

- Sunday 20 January 2008 and Wednesday 23 January 2008
- Sunday 03 February 2008 and Wednesday 6 Feb 2008
- Sunday 10 February 2008 and Wednesday 13 February 2008
- Sunday 17 February 2008 and Wednesday 20 February 2008

These dates are subject to the following:-

- (A) The applicant complying with Schedule C and the following special conditions:
- (B) Any variation on the approved date will require the matter to be submitted to the City's Traffic Operations Management for resolution.
- (C) The applicant shall obtain a separate approval from The Rocks Police for the above road closure and standing of mobile crane in the street.
- (D) The applicant must discuss with the State Transit Authority to determine detour route of Sydney buses;
- (E) The applicant shall organise the user-pay police through The Rocks Police.
- (F) A sub-committee be formed to consult with the applicant to resolve operational matters and report resolutions back to this Committee.

DECISION**BACKGROUND**

An application has been received from Kell & Rigby Pty Ltd seeking approval for the temporary full road closure of George Street between Market Street and King Street on several evenings between Sunday 20 January and Wednesday 20 February from 9pm to 5am.

COMMENTS

The proposed closure is required to stand a 90 tonne mobile crane in the street to lift help install a glass façade to the premises at 77 King Street, Sydney.

The applicant has provided a Traffic Management Plan that includes details of the placement of barricades, signs, flagmen and other traffic control devices to affect the proposed road closure.

The closure of George Street will require significant coordination by various Authorities and it is recommend that a sub committee be formed to investigate and resolve operational matters and report these findings back to this committee.

The proposed closure does not clash with any other road events or approved road closures in the vicinity.

ATTACHMENTS

A - George Street Sydney – TMP Southbound Traffic

B- George Street Sydney – TMP Northbound Traffic

Rodney King, Area Traffic Engineer

KAYD D TRAFFIC MANAGEMENT
 DATE: 30/05/07
 PLAN No: 357001
 LOCATION: GEORGE ST SYDNEY
 DRAWN BY PETER TURNER DESIGNED BY JESSICA BROWN
 TO BE READ IN CONJUNCTION WITH T.A
 TRAFFIC CONTROL AT WORKSITES MANUAL

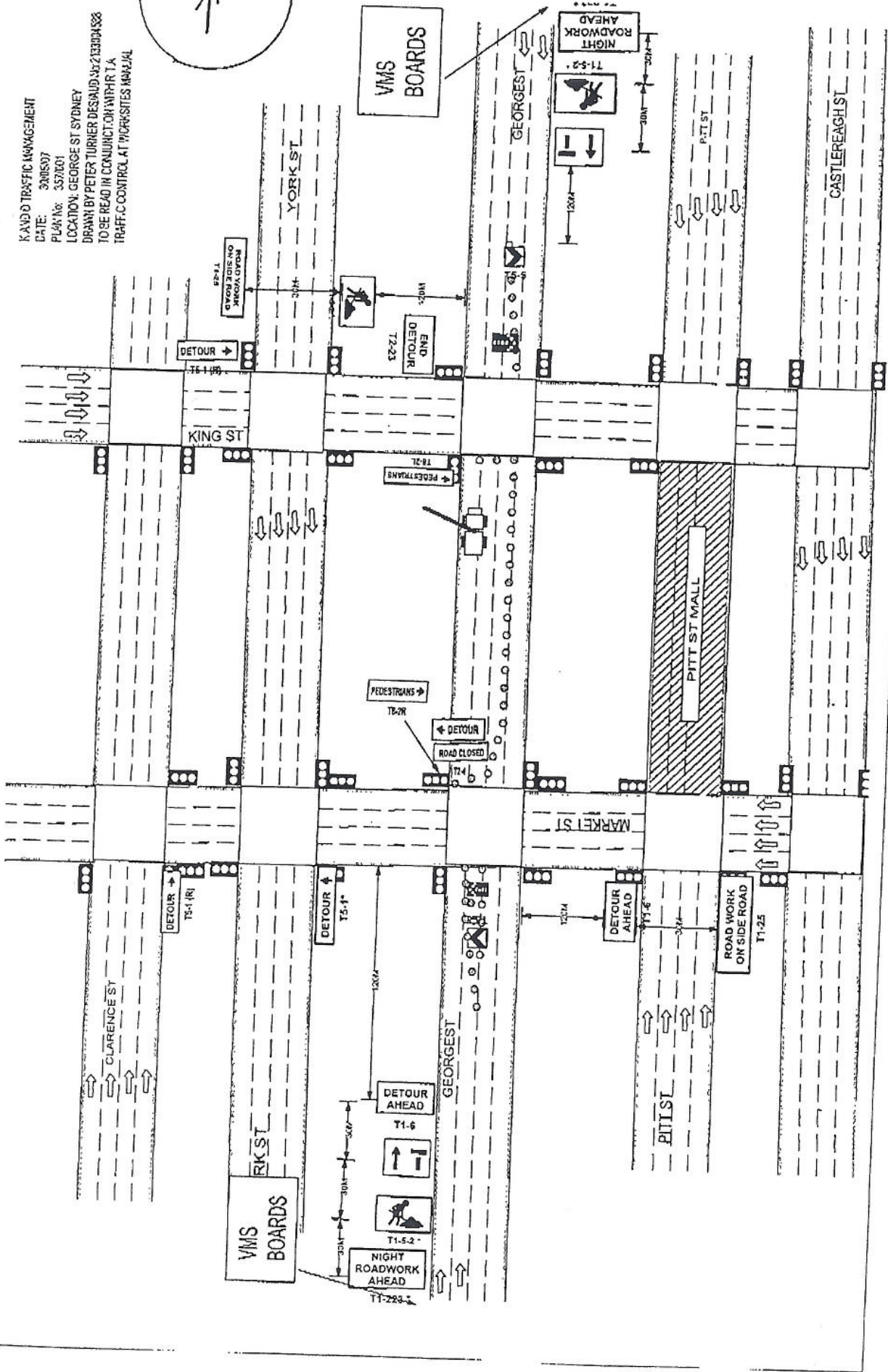
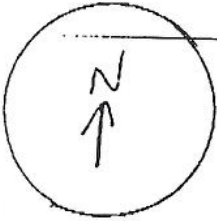

K AND D TRAFFIC MANAGEMENT
 DATE: 30/03/07
 PLAN No: 3573031
 LOCATION: GEORGE ST SYDNEY
 DRAWN BY: PETER TURNER DES/UID No: 2133004688
 TO BE READ IN CONJUNCTION WITH R.T.A
 TRAFFIC CONTROL AT WORKSITES/MANUAL

