



National Indigenous Development Centre



Australian Government
Indigenous Land Corporation



We build strong **PEOPLE**
strong **FAMILIES** strong **COMMUNITIES**



AIMS AND OBJECTIVES

- **To create a centre of excellence for social, educational, cultural and sporting programs**
- **Long term benefits for young Indigenous people in the key program areas of sport, art, education and culture.**
- **Creation of a national model for Indigenous development and program delivery**
- **Employment and training opportunities through the development and implementation of an Indigenous Employment Participation Plan**



MASTER PLAN

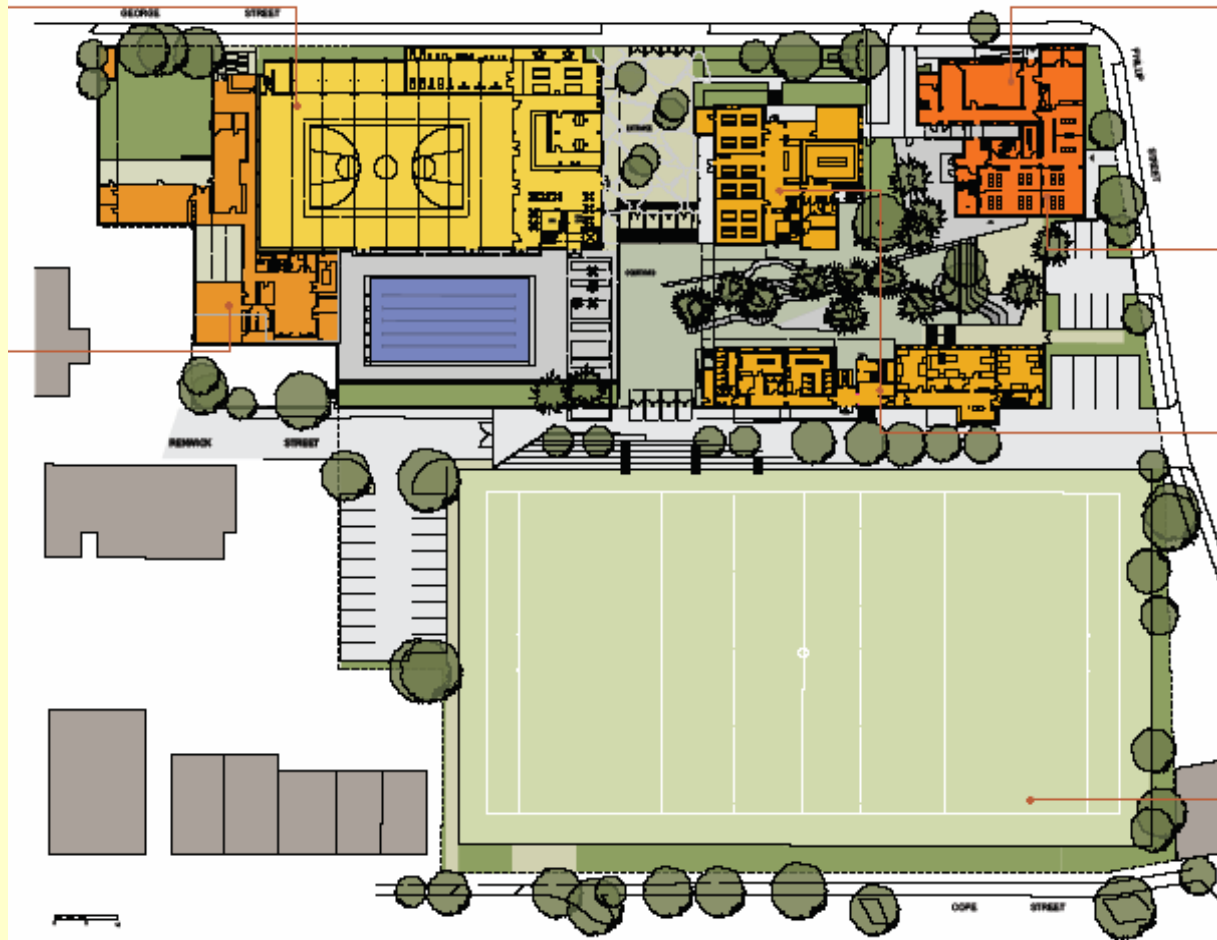



ABOUT THE INDIGENOUS LAND CORPORATION

- Commonwealth Statutory Authority created in 1995
- Established to deliver benefits to Indigenous people through access to, and ownership of land
- Delivery of social, cultural, environmental and economic benefits
- Other Redfern projects include:
 - Building purchased for Wyanga Aboriginal Aged Care (2005)
 - Black Theatre Building – new home of Koori Radio (2008)
 - Purchased building for Mudgin-Gal Aboriginal Women's Centre (refurbishment due for completion by 2010)



GEORGE STREET VIEW





NIDC FACILITIES

- **George St Sport and Fitness Centre** comprising multi-purpose sports court, gym, arts & crafts, computer and other activity rooms
- Intensive literacy tutorial centre for 60 primary school students
- Sports playing field
- Outdoor 25 metre heated swimming pool
- **Sydney Urban Camp Accommodation** catering for short stays for 130 people
- Kitchen, Dining & Conference facilities
- Community and Commercial Office Accommodation





MANAGEMENT STRUCTURE OF THE NIDC

- Indigenous Land Corporation as landowner
- NIDC Ltd as operating company
- YMCA as manager of key facilities and program operator
- Expert program partners to deliver targeted benefits to young Indigenous people:
 - ❖ Exodus Foundation Tutorial Centre
 - ❖ National Aboriginal Sporting Chance Academy
 - ❖ Lloyd McDermott Rugby Development Team



UNIQUE MIX OF NIDC USERS

1. Local Community
2. Indigenous Groups visiting NIDC from across Australia
3. General Groups (Schools, Clubs) visiting NIDC



COURT YARD



ABOUT THE YMCA

- The YMCA is the largest manager of Sport, Recreation and Aquatic Facilities in Australia
- The YMCA is the largest manager of Camp style accommodation in Australia
- The YMCA is the operator of choice because it has the expertise to maximise the potential of the National Indigenous Development Centre and ensure benefits are delivered to the local community

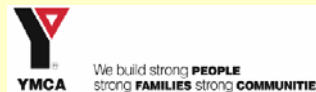

Australian Government
Indigenous Land Corporation

YMCA PROGRAMS AT THE NIDC

Traditional

- Health & Fitness
- Accommodation
- Sports Competitions
- OSHC
- Aquatics
- Gymnastics
- Youth Leadership

New opportunities

- Indigenous Training & Employment Strategy
- Tutorial & educational programs
- Midnight Basketball
- Oasis Program
- Social Touch Football
- Indigenous Mentoring and leadership programs

TRADITIONAL YMCA PROGRAMS CUSTOMISED FOR THE NIDC

- YMCA Teen Gym
- YMCA Pryme movers
- YMCA Homework Club
- Youth Parliament

A SYDNEY INDIGENOUS EXPERIENCE

- NIDC
- The Black Theatre
- Tribal Warrior
- Exodus Tutorial Centre
- Aboriginal Medical Service Redfern
- Aboriginal Job Ready Centre
- Yaama Dhiyaan Hospitality Training College



A Thursday night at 5pm....

4 Futsal Sports teams
2 being Indigenous

50 Fitness Members with
20 to 25 Indigenous Members

35 Children's and Adults Swimming
with 12 to 20 Indigenous

25 Indigenous Rugby Players at a Lloyd McDermott Camp

20 NASCA Indigenous Athletes at a training Camp

30 OSCHC and homework Children with 10 to 15 Indigenous

20 Indigenous Children from NSW North Coast Visiting Sydney

50 Children from Bathurst Primary visiting Sydney

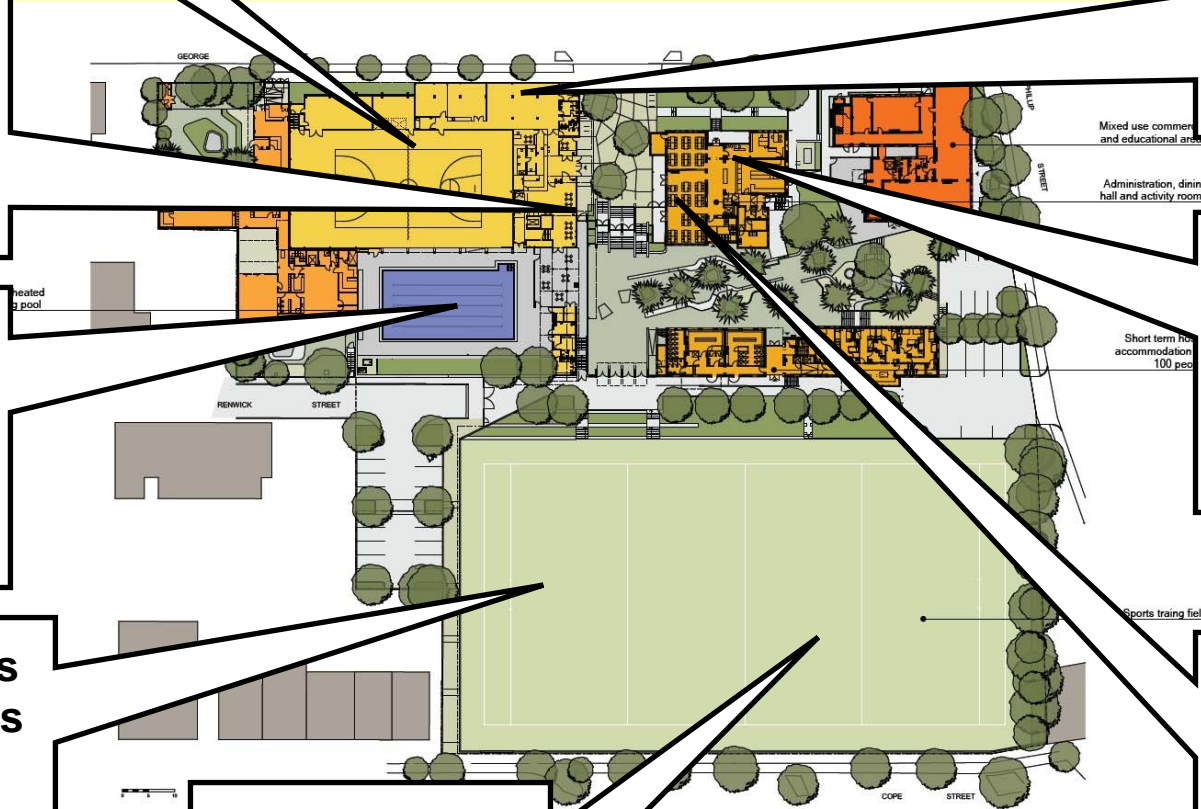

And at 5pm there could also be...

- ✓ Employment Training Programs
- ✓ Community Groups meeting
- ✓ Youth Counseling / mentoring sessions
- ✓ Groups sitting relaxing, and enjoying the café and outdoor environment

- ✓ Supported by up to 10 Indigenous staff members

STRATEGIES TO ENGAGE AND FACILITATE INDIGENOUS PARTICIPATION

- Staff recruitment and Leadership roles (30%)
- Dedicated Youth Programs Coordinator
- Membership Fee Assistance 30% of all users pay 20% of the market rates
- Scholarships (5%)

***A centre that celebrates the culture of
Indigenous leadership in Sport, Recreation
and Arts.***

OUR JOURNEY AHEAD...

- Communicate and build awareness of the NIDC
- Form partnerships with key local and regional community groups
- Work to ensure an efficient, effective and professional final product
- Recruitment, training and staff inductions
- Foundation Membership drive
- Sydney Urban Camp bookings
- Grant seeking and Funding to support programs