

Part C - Precinct Plans

24. Moore Park and Paddington

The Moore Park Precinct covers the entire Moore Park, Centennial Park and Showground area, as well as Paddington between Centennial Square and Victoria Park Barracks, and the suburb of Centennial Park.

24.1 Precinct objectives

General

- To enhance the streetscape with street trees of appropriate scale and form.
- To respect established street tree character.
- To reinforce the residential character through a mix of deciduous and evergreen tree planting.

Special

- Where appropriate, provide plantings that are sympathetic to the heritage values of the Centennial Park/ Moore Park environs.

24.2 Precinct conditions

Existing street trees

The precinct has a combination of established exotic and native trees with plantings of mature *Ficus* providing memorable high quality streetscapes. Many streets have significant borrowed landscape from the surrounding parklands. Mature Poplar and Paperbark tree plantings have been progressively removed due to disease and structural instability.

Current dominant species

<i>Ficus hillii</i>	Hills Weeping Fig
<i>Flindersia australis</i>	Crows Ash
<i>Lophostemon confertus</i>	Brush Box
<i>Tristaniaopsis laurina</i>	Water Gum

Built form and road widths

The precinct is dominated by the open space of Centennial/ Moore Park, the historical areas of the Showground and the Victoria Barracks. In these large areas of open space the established landscape style is strongly Victorian with grand avenues and mature late 19th century plantings. The topography consists of gently undulating slopes rising to the Oxford Street ridge line.

Geological conditions

The deep windblown sands with occasional Hawkesbury Sandstone intrusions, mainly towards the northern areas.

Soil conditions

The soils of the area are dominated by the sandstone and windblown sand derived soils typical of the gentle slopes leading south to Botany Bay.

24.3 Proposed Primary Tree Species Palette

Common Name	Species
Brush Box	<i>Lophostemon confertus</i>
Smooth Barked Apple	<i>Angophora costata</i>
Hills Weeping Fig	<i>Ficus microcarpa var hillii</i>
Tuckeroo	<i>Cupaniopsis anacardioides</i>
Weeping Lillypilly	<i>Waterhousia floribunda</i>
Cabbage Tree Palm	<i>Livistona australis</i>
London Plane	<i>Platanus acerifolia</i>
Golden Robinia	<i>Robinia pseudoacacia 'Frisia'</i>
Crows Ash	<i>Flindersia australis</i>
Green Ash	<i>Fraxinus pennsylvanica</i>
Jacaranda	<i>Jacaranda mimosifolia</i>
Lemon Scented Myrtle	<i>Backhousia citriodora</i>
Chinese Pistachio	<i>Pistacia chinensis</i>
Southern Hackberry	<i>Celtis australis</i>
Blueberry Ash	<i>Elaeocarpus reticulatus</i>



Figure 77- Borrowed landscape from Moore Park. (Photo Arterra)

Moore Park & Paddington

SPECIES LEGEND

Evergreen

- Ac *Angophora costata* (Smooth-barked Apple)
- Bc *Backhousia citriodora* (Lemon-scented Myrtle)
- Bi *Banksia integrifolia* (Coast Banksia)
- Ce *Corymbia eximia* (Yellow Bloodwood)
- Cp *Cupaniopsis anacardioides* (Tuckeroo)
- Er *Elaeocarpus reticulatus* (Blueberry Ash)
- Em *Eucalyptus microcorys* (Tallowood)
- Fm *Ficus microcarpa* var. *hillii* (Hill's Weeping Fig)
- Fa *Flindersia australis* (Crows Ash)
- Lc *Lophostemon confertus* (Brush Box)
- Mq *Melaleuca quinquenervia* (Broad-Leaf Paperbark)
- Ti *Tristaniopsis laurina* (Water Gum)
- Wf *Waterhousea floribunda* 'Green Avenue' (Weeping Lilly Pilly)

Deciduous

- Ca *Celtis australis* (Southern Hackberry)
 - Fp *Fraxinus pennsylvanica* (Green Ash)
 - Jm *Jacaranda mimosifolia* (Jacaranda)
 - Kp *Koelreuteria paniculata* (Golden Rain Tree)
 - Pch *Pistacia chinensis* (Chinese Pistachio)
 - Pa *Platanus acerifolia* (London Plane)
 - Pd *Populus deltoides* (Cottonwood)
 - Pc *Pyrus calleryana* (Callery Pear)
 - Rf *Robinia pseudoacacia* 'Frisia' (Golden Robinia)
 - Up *Ulmus parvifolia* 'Todd' (Chinese Elm)
- ### Palms
- La *Livistona australis* / *Washingtonia robusta* (Cabbage Tree Palm/ Mexican Fan Palm)

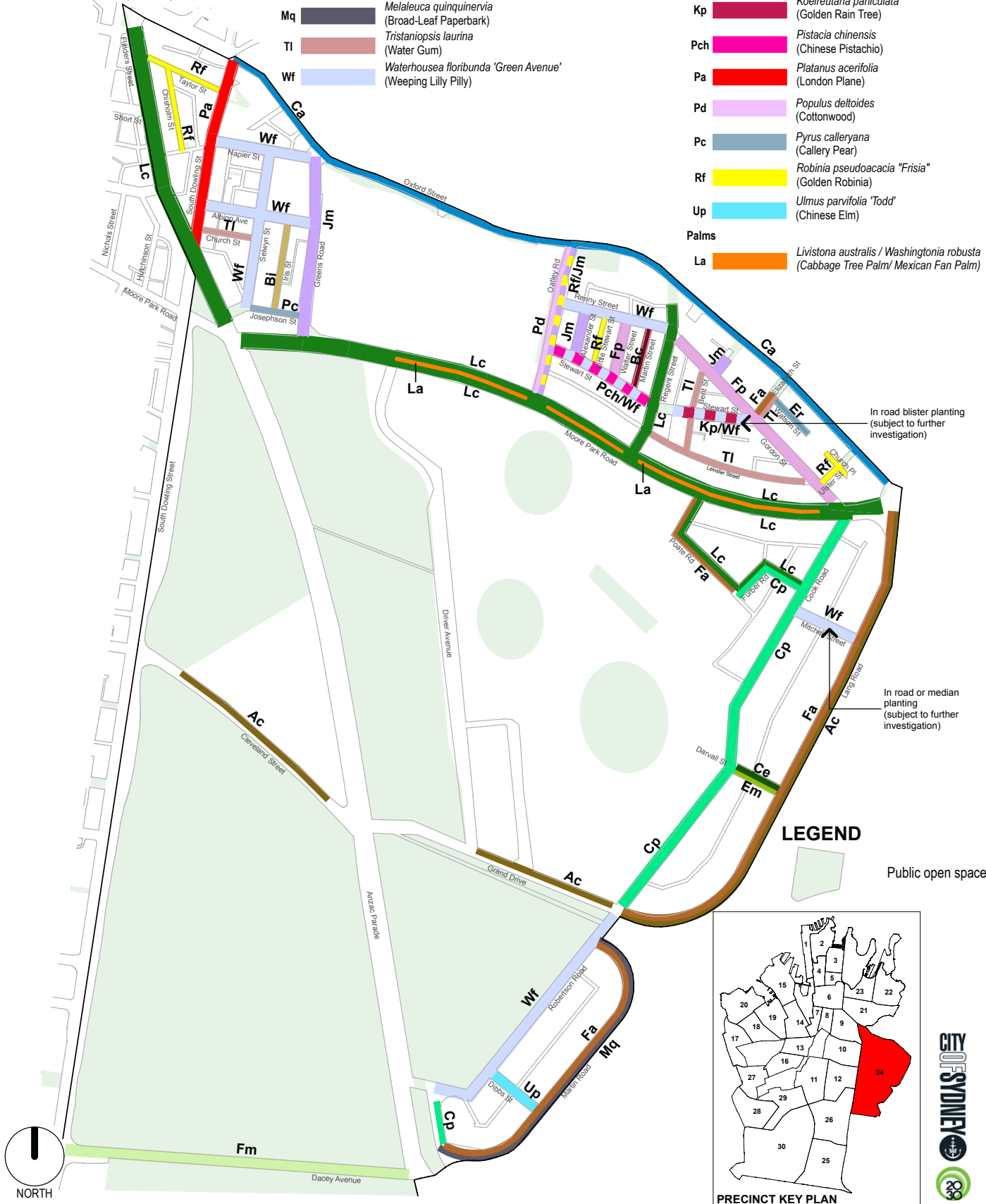

In road blister planting (subject to further investigation)

In road or median planting (subject to further investigation)

LEGEND

Public open space

