



Beare Park Amenities Block Elizabeth Bay

Description

Adaptive reuse of a single story amenities (toilet) block in Beare Park Elizabeth Bay.

The building includes 1 unisex accessible toilet, one male and one female toilet, and a green roof and green facades on the northern aspect of the building.

Project background

The project refurbished an existing 1950s toilet block with these aims:

Design excellence – upgrade the facility improving accessibility and public safety through good design;

Adaptive reuse – retain as much of the existing brick outer shell as possible; and

Making the building more sympathetic to the landscape (through the use of green roof and green facades).

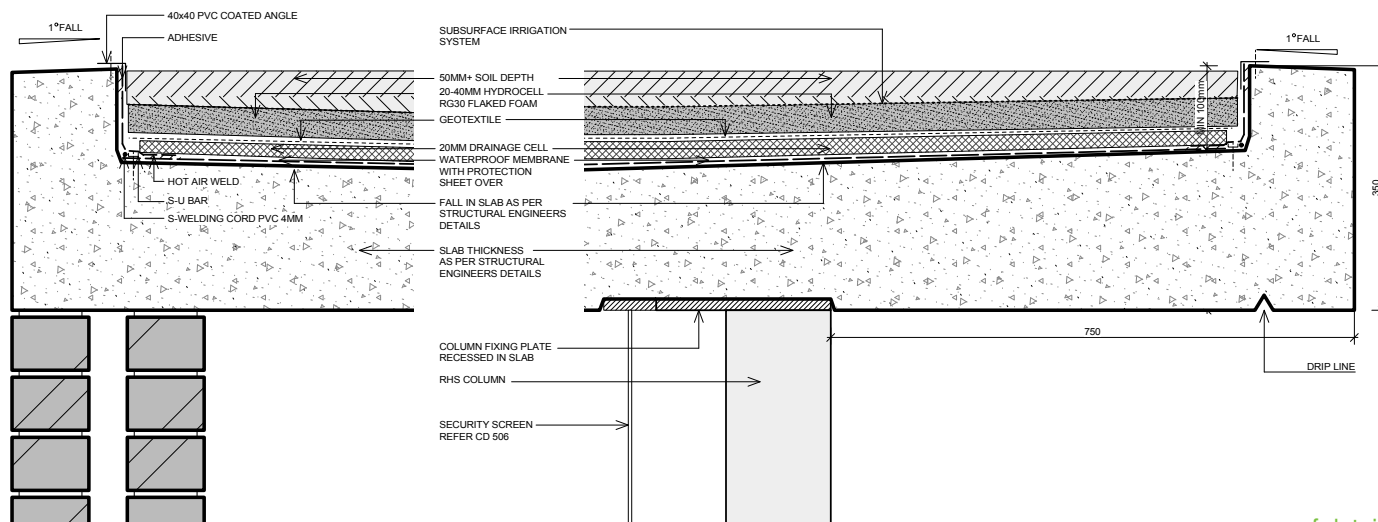

roof detail







Details

Address	2 Elizabeth Bay Road, Elizabeth Bay
Type	Green roof and green facade
Size (m²) total	Green Roof – 40m ² Green Wall – 10m ²
Size – green coverage	Green roof – 100% Green Wall – 60%
New / retrofit	Retrofit
Year installed	Green roof installed 2007 Design process took 6 months
Height	Three storeys
Slope	1 degree
System type	Fytogreen
Soil depth / mix / type	100mm up to 160mm substrate with a total of 250mm profile depth Design includes fytogreen absorbent flakes
Plant types	Drought resistant species to suit the exposed site and shallow soil profile: <ul style="list-style-type: none"> • Agave attenuate; • Aloe barbadensis; • Alyssum spinosum; • Carpobrotus glaucescens; • Kalanchoe thyrsiflora; • Sedum acre; • Sedum hidakanum; • Sedum rubrotinctum; • Senecio serpens; and • Yucca filamentosa). Green wall <ul style="list-style-type: none"> • Kennedia nigricans; and • Hibbertia scandens. All plants have functioned well on the roof.

Cost / m²	Roof works cost approx. \$65,000 or \$1,625 / m ²
Costs include	Consultant architects, landscape architect and green roof specialist design and installation
Client	City of Sydney
Building owner	City of Sydney
Accessibility (private / public)	Can be easily viewed from ground level
Designer / landscape architect	Consultant architect: Sam Crawford Architects Landscape architect: Jane Irwin Landscape Architecture
Installer	Fytogreen
Motivation for installation	Adaptive reuse Aesthetics – blending the building into the environment
Maintenance	Irrigation is installed but rarely used
Water source (tank, recycled, potable)	Recycled water
Contact	City Projects: Project Management – Andrew Chippendale Design Manager – Narelle Naumcevski
Notes	As of October 2014 the green roof and walls are doing extremely well. Despite the exposure of the site to sea air and intense sun, the plants are healthy after more than 7 years. Coverage on the green façade is not complete during winter but is very green during warmer months.



Species on the Beare Park green roof

Latin Name	Common	Photo
Agave attenuate	Agave	
Aloe barbadensis	Aloe	
Alyssum spinosum	Madwort	
Carpobrotus glaucescens	Pigface	
Kalanchoe thyrsiflora	Flapjack	
Sedum acre	Gold moss	

Latin Name	Common	Photo
Sedum hidakanum	Sedum	
Sedum rubrotinctum	Christmas cheer	
Senecio serpens	Blue chalksticks	
Yucca filamentosa	Needle and thread	
Green wall – Beare Park		
Kennedia nigricans	Black coral pea	
Hibbertia scandens	Snake vine	