

'A' - EASEMENT FOR CITY RAILWAY PURPOSES LIMITED IN STRATUM VIDE GOVT. GAZ. No. 134 DATED 15/10/65 FOL3374  
 'B' - PT1 DP811077 MARKET STREET AND GEORGE STREET ABOVE  
 'C' - PT1 DP811077 DRUITT STREET AND GEORGE STREET ABOVE  
 'D' - TELECOM TUNNEL VIDE DP811077 (P11 D.P.811017 ABOVE & BELOW)  
 'E' - S.C.C. TUNNEL VIDE DP811077 (P11 D.P.811017 ABOVE & BELOW)

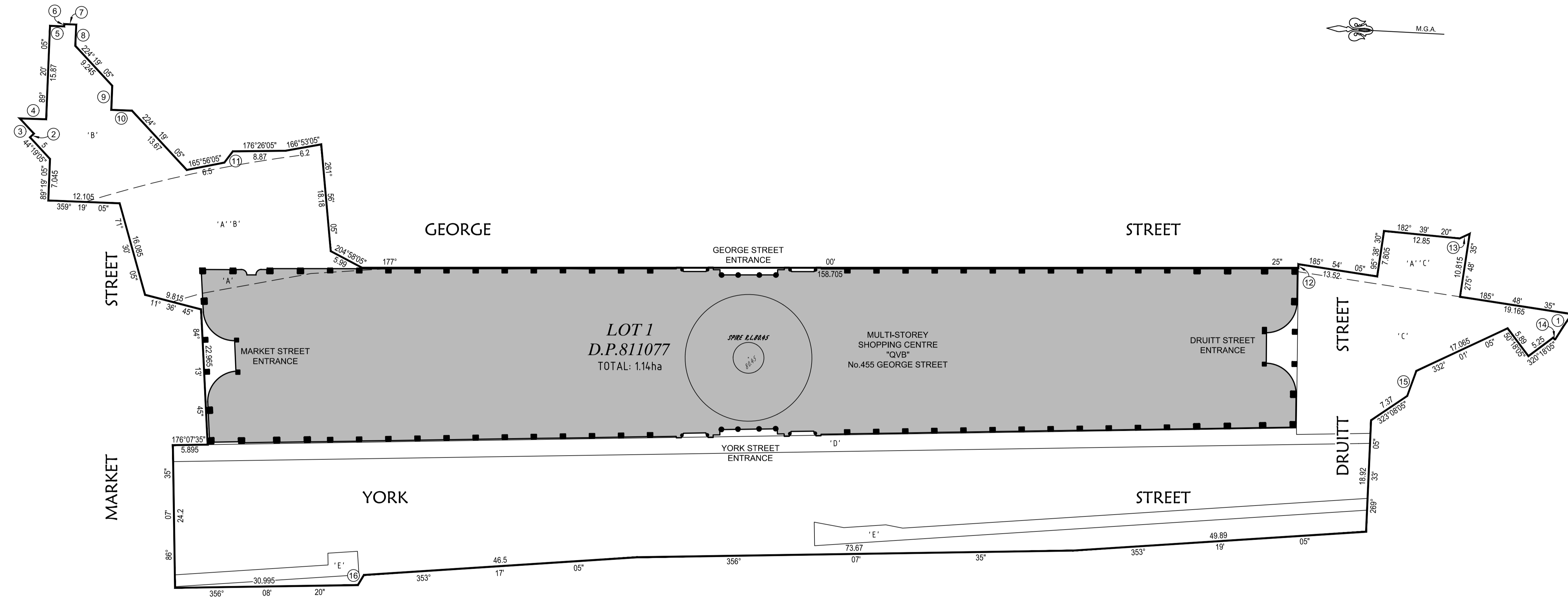
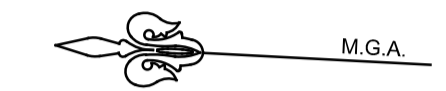

SCHEDULE OF CURVES

No.	BEARING	CHORD	ARC	RADIUS
1	300°04'35"	5.225	5.225	81.69

SCHEDULE OF LINES

No.	BEARING	DISTANCE
2	134°19'05"	0.9
3	44°19'05"	3.51
4	178°48'05"	4.465
5	179°36'05"	2.4
6	89°36'05"	0.4
7	179°36'05"	2.035
8	269°36'05"	3.58
9	269°20'05"	4.085
10	179°19'05"	3.52
11	124°08'05"	2.4
12	87°40'35"	0.625
13	152°23'50"	1.91
14	50°20'05"	0.475
15	287°01'05"	4.55
16	298°07'05"	2

ORIGIN OF LEVELS: P.M.81015, R.L.22.599 VIDE SCIMS 6/6/18.

LOT 1 IS A STRATUM LOT AS DESCRIBED IN D.P.811077

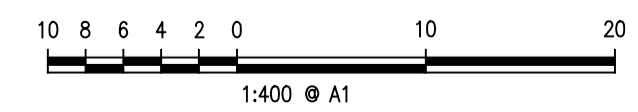

**Survey Notes:-**  
 Location of structures approximate only.  
 The levels and details on this plan have been determined by stadia methods and are within the general accepted accuracies for such surveys. All set out levels must be referred to the bench mark.  
 Bearings and Distances are by deed only and are subject to Final Survey. Except where shown by dimension, the relationship of improvements to boundaries is diagrammatic only. The true positions are subject to Final Survey.  
 Tree sizes are estimates and indicative only.  
 Services and utilities shown have been located by physical evidence and/or by reference to service plans from the relevant authorities. Subsurface utility information shown in accordance with AS5439-2013 QLD. This may not have been opened to verify the type of utility. Excavation has not been carried out to confirm underground location. Service details should be confirmed with the relevant service authority during design and prior to commencement of construction.  
 As part of your duty of care, please contact the following where necessary:-  
 Ausgrid Ph. 131535  
 Dial Before You Dig Ph. 1100  
 Endeavour Energy Ph. 131081  
 Jemena Gas Company Ph. 131245  
 NBN Ph. 1800 881 816  
 Optus Communications Ph. 1800 505 777  
 Sydney Water Ph. 132052  
 Telstra Corporation Ph. 132203  
 This plan has been prepared for the exclusive use of the principal as listed in the title block.  
 Any construction on or near the boundaries will require further survey so that marks defining boundaries can be placed.  
 All set out levels must be referred to the bench mark.  
 © Copyright Craig & Rhodes Pty. Ltd. 2018.  
 No part of this survey may be reproduced, stored in a retrieval system or transmitted in any form without the express permission of the copyright owner except as permitted under the Copyright Act 1968.  
 Any permitted downloading, electronic storage, display, print, copy or reproduction of this survey should contain no alteration or addition to the original.  
 These notes must not be erased.

AMEND. No.	02	DATE	25/01/2019	DETAILS	EASEMENTS & TUNNELS INFO ADDED
AMEND. No.	01	DATE	7/12/2018	DETAILS	DOME INFO ADDED
AMEND. No.	00	DATE	24/07/2018	DETAILS	FIRST ISSUE



Project: LOT DETAILS & GROUND FLOOR BUILDING FOOTPRINT FOR LOT 1 D.P.811077 QUEEN VICTORIA BUILDING 455 GEORGE STREET, SYDNEY

Principal:	URBIS			
Scale:	1:400	Date:	24 JULY 2018	Council Ref.
Cal'c's:	S.T.	Drawn:	K.S.	Proj.Man. D.S.
				Client Ref.



ABN 77 050 209 991 ACN 050 209 991  
 Suite 701, Level 7, 3 Rider Boulevard  
 Rhodes, NSW, 2138  
 PO Box 3220, Rhodes NSW 2138  
 Tel. 9869-1655  
 reception@rhodes.com.au  
 www.craigandrhodes.com.au  
 © Craig & Rhodes

Our Ref. 051-18  
 Dwg File Ref. (Rev) - Sheet Ref.  
 051-18G T01 [02]  
 SHEET 1 OF 1