

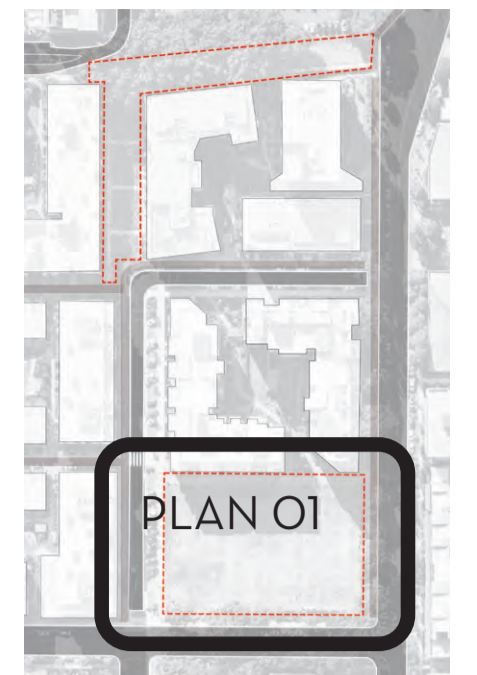

**KEY**

- 1: THE LAWN
  - An open space for informal play, picnicking and gathering.
- 2: THE TERRACES WITH 'DUNE' GARDENS
  - A terrace with shade trees is created on the northern and eastern edges of the park overlooking the lawn.
  - The terraces incorporate play areas and low native gardens, picnic tables, bench seating, cycle racks and a drinking fountain.
  - Staggered avenues of native trees are located on these terraces creating an interlinked canopy and providing dappled shade and habitat for native birds.
- 3: PLAY GROVES
  - A range of play spaces with facilities for children of varying ages.
  - Incorporating themes of nesting, nature play and discovery
  - Emphasis on climbing elements and natural materials.
- 3A: A play zone for younger children incorporating timber sculptures, gardens, steppers and rope hammocks.
- 3B: A play area for older children zone incorporating a custom play structure with rope bridges, platforms, nets and a slide.
- 3C: A swing play grove to the west includes swings facing the lawn.
- 3D: A shade structure over the end of the slide.
- 4: THE GARDEN EDGE
  - A garden space with seating located on the eastern and southern park edge providing a low buffer to the street.
  - A mix of native planting to provide habitat for native birds.
- 5: AMENITIES BUILDING by others
- 6: Existing footpaths.
- 7: Existing trees to be retained.



**LEGEND**

- Scope of works
- Existing trees
- New trees

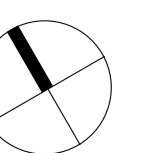



Gum Nest Play Zone: A play area for older children zone incorporating a shade structure, custom play structure with rope bridges, platforms, nets, a slide and in ground rope hammocks.

A play zone for younger children incorporating timber sculptures, gardens and steppers.

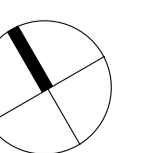

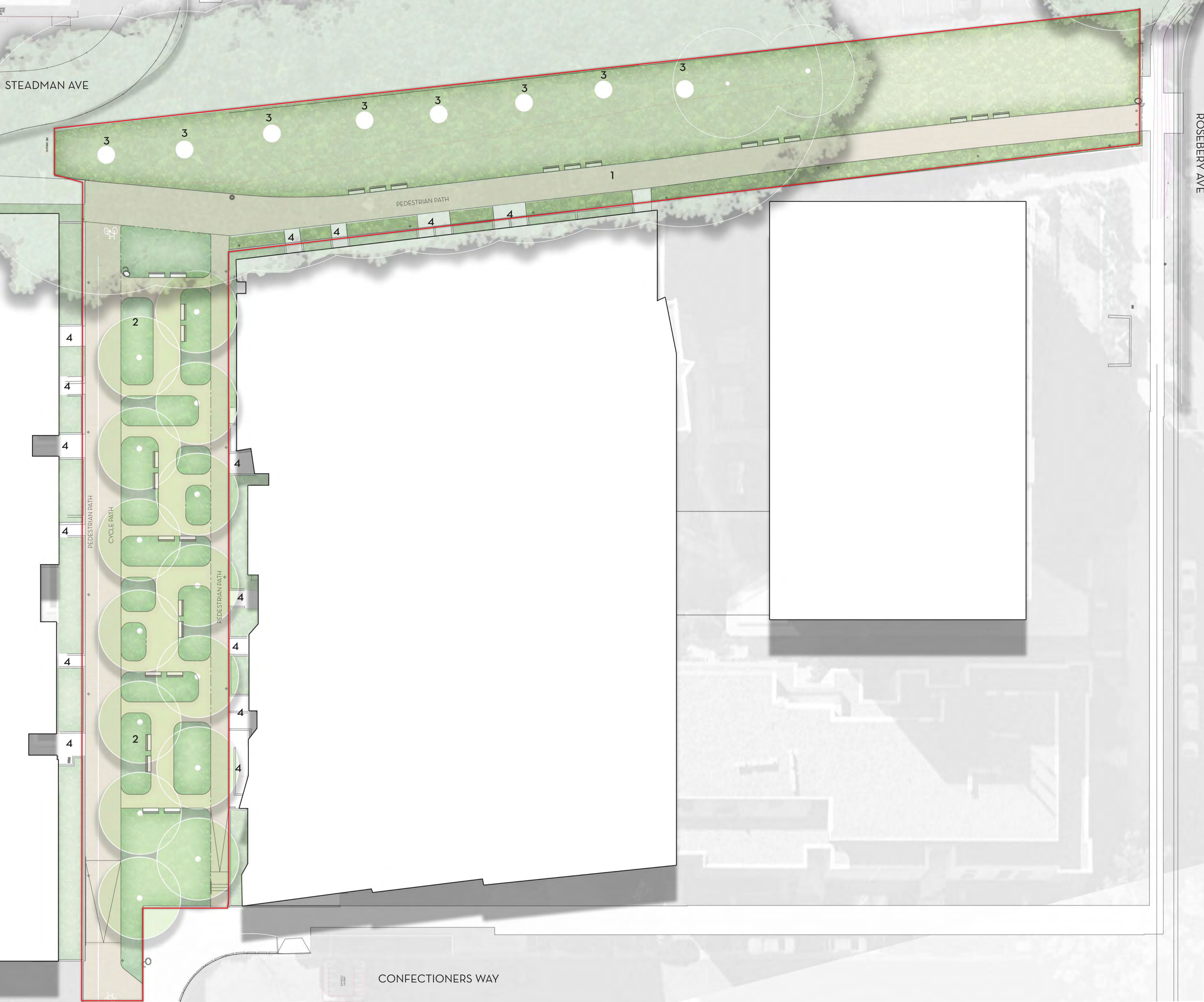

**KEY**

- 1: GREEN LINK : NORTH
  - An upgraded path connection connecting from Rosebery Avenue to Steadman Avenue.
  - The layout provides wider garden beds with low planting under the existing fig trees.
  - New seating is provided along its length.
  - New tree planting is provided at the eastern entry.
  
- 2: GREEN LINK: EAST TO WEST
  - An upgraded landscape terrace with gardens, trees and seating.
  - New pedestrian paths are provided on the eastern boundary and a shared pedestrian/ cycle path on the western boundary. The path on the western boundary is wide (3.8m) to accommodate a pedestrian path (1.4m) and cycle path (2.4m).
  - The new shared path includes ramp access to Confectioners Way.
  - The shared way will connect to a future cycleway to be provided on Spring Street
  
- 3: EXISTING FIGS: to be retained.
  
- 4. EXISTING APARTMENT ENTRIES

**LEGEND**

- Scope of works
- Existing trees
- New trees

