

Proposed works

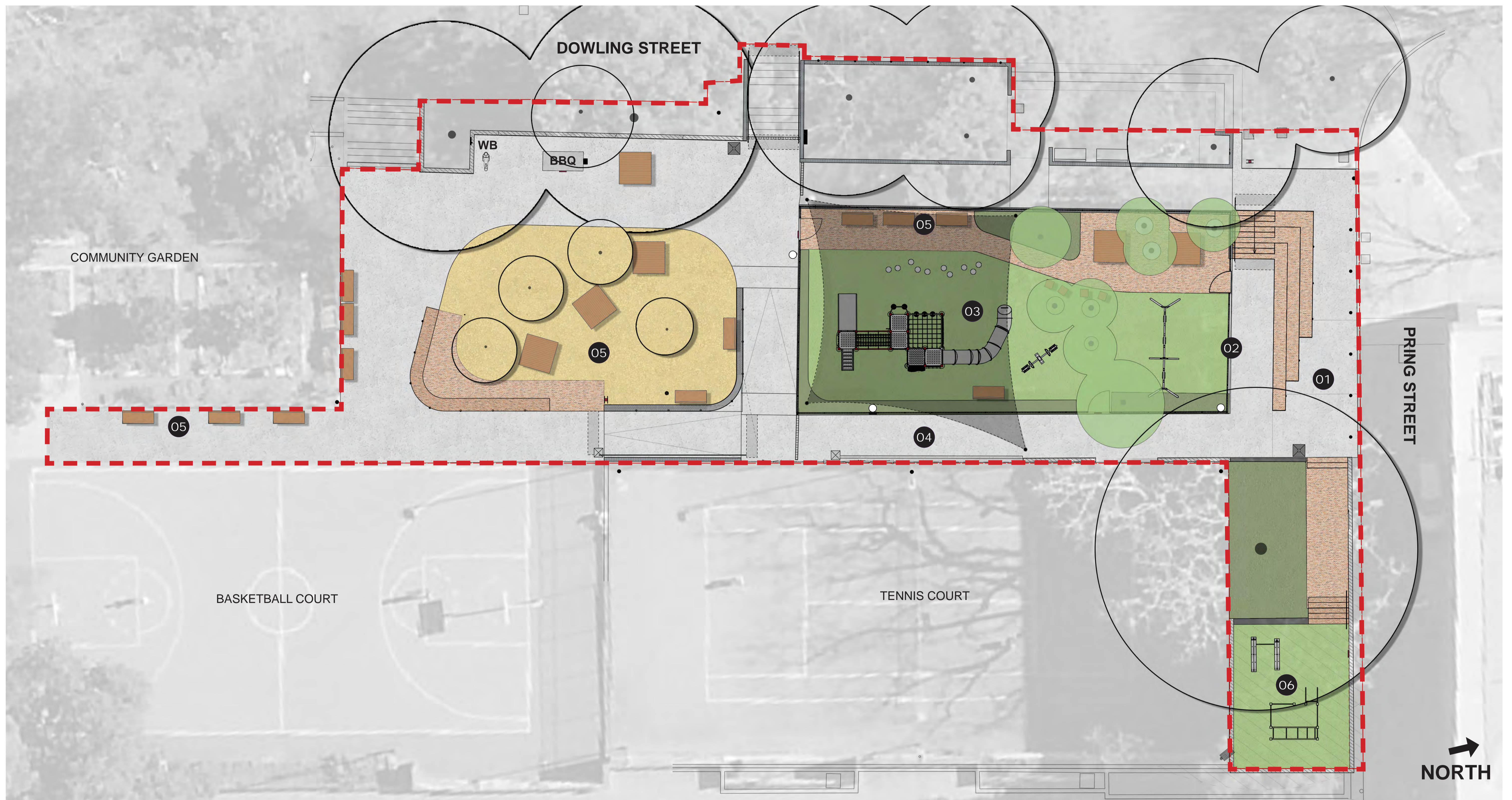

- | | | | |
|--|-------------------------------------|--|---|
| Retain and protect existing trees | New rubber softfall | New water bubbler with dog bowl | New consolidated playground area including play structure with play panels, climbing net and slides, swing set with three seats (x2 strap seats and x1 baby seat), seesaw and steppers. |
| New trees | New planting | New bins | Improved circulation and access paths |
| New concrete path | Retain Shade Structure | New park signage | Increased seating opportunities |
| New brick path, stairs and seating walls | Retain BBQ | New lighting upgrade where required | New exercise area with chin-up and dip bars |
| New decomposed granite surface | New platform | New park entry with stairs and bleachers | |
| | New seating with back and arm rests | New 'Woolloomooloo' playground fence | |