

## KEY

### 1: THE LAWN

- An open space for informal play, picnicking and gathering.
- The orientation maximizes winter sun to the lawn.

### 2: THE TERRACES WITH 'DUNE' GARDENS

- A terrace is created with shade trees overlooking the lawn.
- The terraces incorporate play areas and low native gardens
- The terraces include picnic tables, bench seating drinking fountain and cycle racks.
- A tree grove provides dappled shade and acts as a green screen framing the park.

### 3: PLAY GROVES

- A range of play spaces with facilities for children of varying ages.
- Incorporating themes of nesting, nature play and discovery
- Emphasis on climbing elements and natural materials.

3A: A play zone for younger children incorporating timber sculptures, gardens, steppers and rope hammocks.

3B: A play area for older children zone incorporating a custom play structure with rope bridges, platforms, nets and a slide.

3C: A swing play grove to the west includes swings facing the lawn.

### 4: THE GARDEN EDGE

- A garden space with seating located on the eastern and southern park edge providing a low buffer to the street.
- A mix of native planting to provide habitat for native birds.

### 5: AMENITIES BUILDING by others

### 6. Existing footpaths.

### 7. Existing trees to be retained.

## LEGEND

— Scope of works

Existing trees

New trees

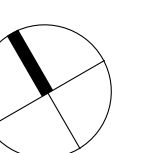





Gum Nest Play Zone: A play area for older children zone incorporating a custom play structure with rope bridges, platforms, nets and a slide.

A play zone for younger children incorporating timber sculptures, gardens, steppers and rope hammocks.

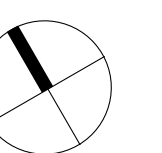



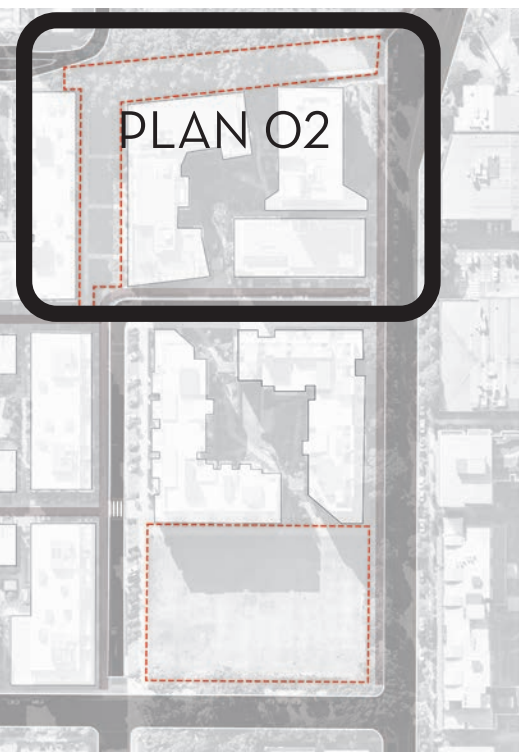
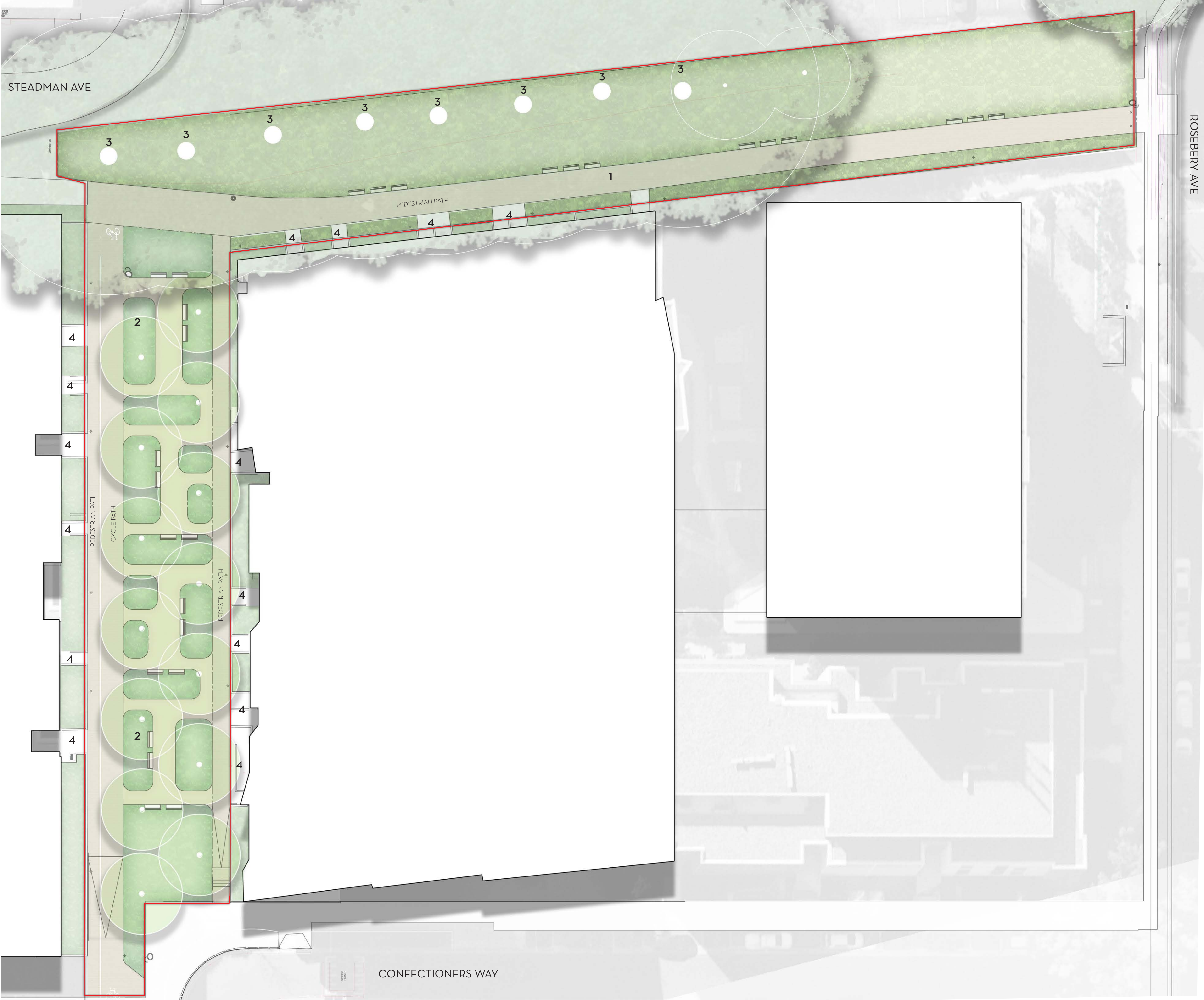

KEY

- 1: GREEN LINK : NORTH
- An upgraded path connection connecting from Rosebery Avenue to Steadman Avenue.
  - The layout provides wider garden beds with low planting under the existing fig trees.
  - New seating is provided along its length.
  - New tree planting is provided at the eastern entry.
- 2: GREEN LINK: EAST TO WEST
- An upgraded landscape terrace with gardens, trees and seating.
  - New pedestrian paths are provided on the eastern boundary and a shared pedestrian/ cycle path on the western boundary. The path on the western boundary is wide (3.8m) to accommodate a pedestrian path (1.4m) and cycle path (2.4m).
  - The new shared path includes ramp access to Confectioners Way.
  - The shared way will connect to a future cycleway to be provided on Spring Street
- 3: EXISTING FIGS: to be retained.
4. EXISTING APARTMENT ENTRIES

LEGEND

- Scope of works
- Existing trees
- New trees

