



Location Plan

Background

In 2024 we consulted with the community about what you wanted upgraded in Alexandria Park playground. We have since been developing a concept design for the park aimed at improving the quality and range of play experiences, catering to a range of age groups, pathway and accessibility, lighting, toilet amenity and tennis facilities.

The key updates and current design can be seen below. We invite your feedback on the proposed concept design.



Artist impression of Alexandria Park renewal



Example of Playground



Example of Tennis Amenity Block



Example of Active Youth Area



Example of Tennis Courts

Proposed Works

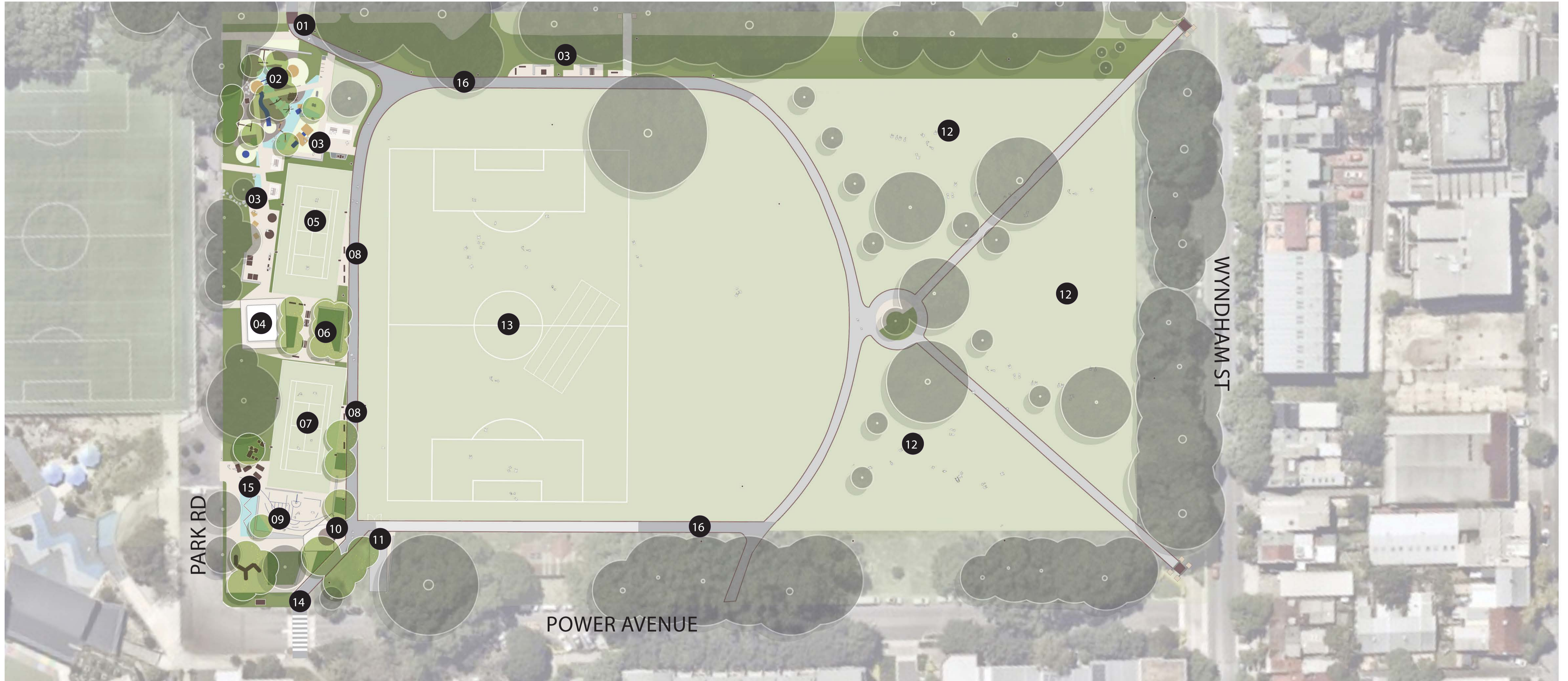

- 01 Upgraded entry from Buckland Street (aligned to crossing)
- 02 New Playground
- 03 Picnic and seating area
- 04 Refurbished Tennis amenities with toilet facilities
- 05 Tennis Court 01
- 06 Shaded picnic and spectating courtyard
- 07 Tennis Court 02
- 08 Spectating seating

- 09 Youth space
- 10 New southern entry plaza
- 11 Upgraded vehicular access
- 12 Dog off leash area to be irrigated
- 13 Existing sportsfield and cricket pitch retained
- 14 Existing Power Avenue pedestrian crossing
- 15 Exercise station
- 16 New pedestrian pathway

