

TYPICAL FOOTPATH SECTION - FLEXIBLE BASE

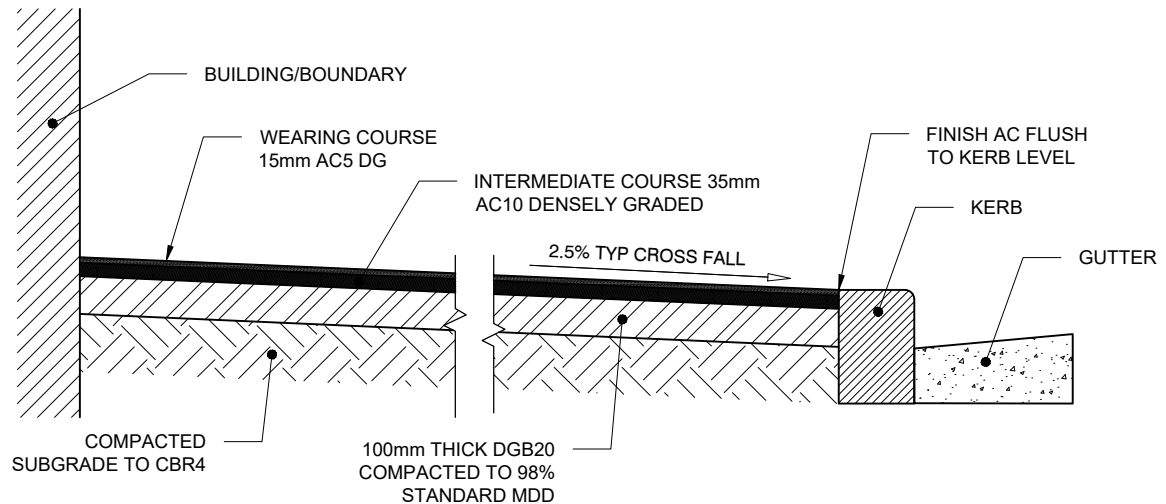

TYPICAL FOOTPATH SECTION - RIGID BASE

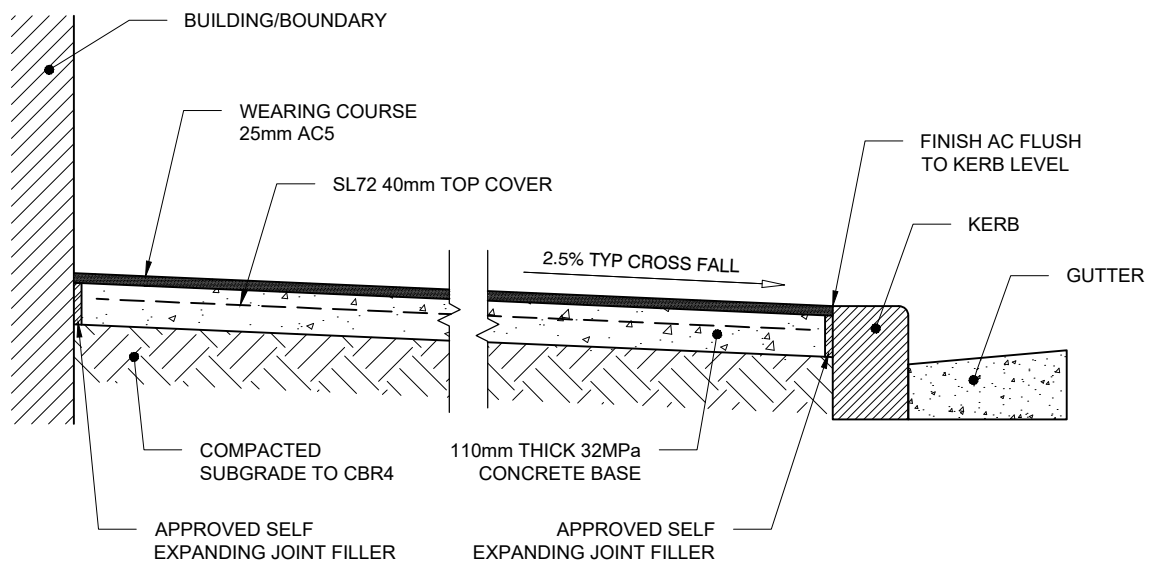

NOTES:

1. MODIFIED ASPHALTIC CONCRETE WITH POLYMER ADDITIVE TO INCREASE SOFTENING POINT TO BE USED IN LOCATIONS WITH EXISTING OR PROPOSED OUTDOOR DINING (FULL FRONTAGE).
2. ALL DIMENSIONS IN MILLIMETRES UNLESS OTHERWISE STATED.

SCALE 1:20