

PLAN 1:100

NOTE: ALL DIMENSIONS IN MILLIMETRES UNLESS OTHERWISE STATED

## TYPICAL FOOTPATH SECTION - FLEXIBLE BASE

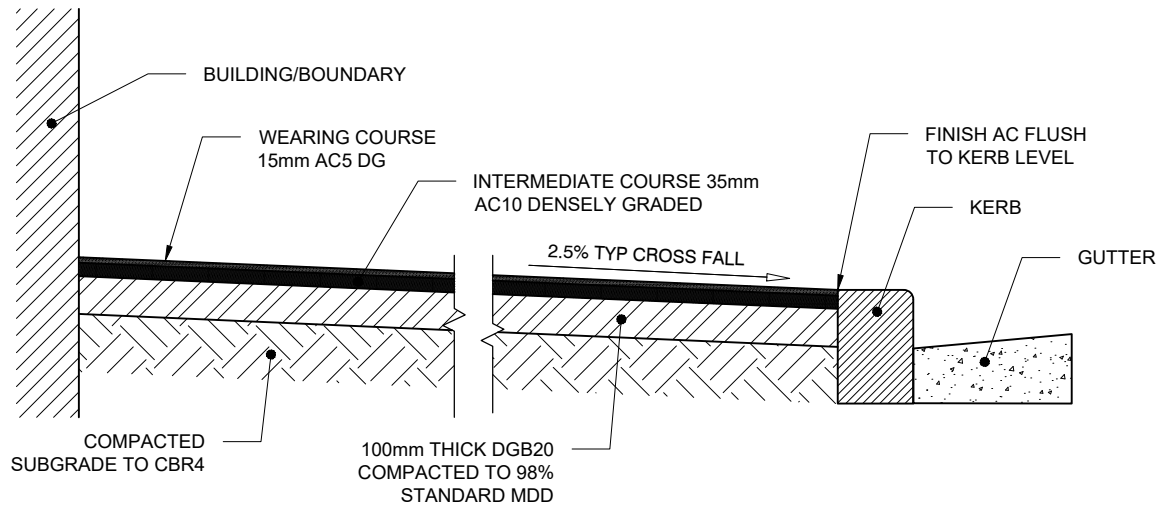

## TYPICAL FOOTPATH SECTION - RIGID BASE

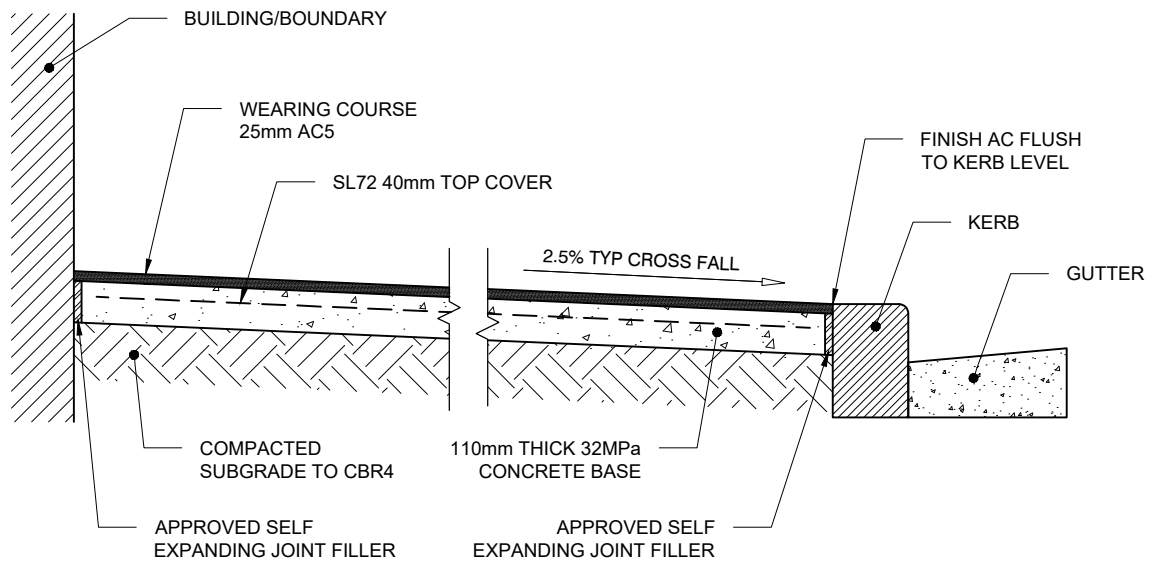

### NOTES:

1. MODIFIED ASPHALTIC CONCRETE WITH POLYMER ADDITIVE TO INCREASE SOFTENING POINT TO BE USED IN LOCATIONS WITH EXISTING OR PROPOSED OUTDOOR DINING (FULL FRONTAGE).
2. ALL DIMENSIONS IN MILLIMETRES UNLESS OTHERWISE STATED.

SCALE 1:20

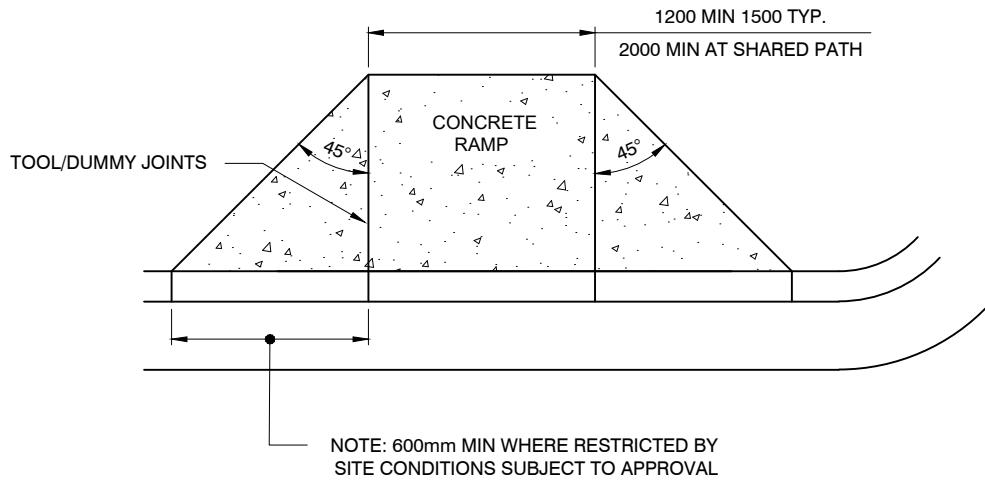

PLAN 1:50

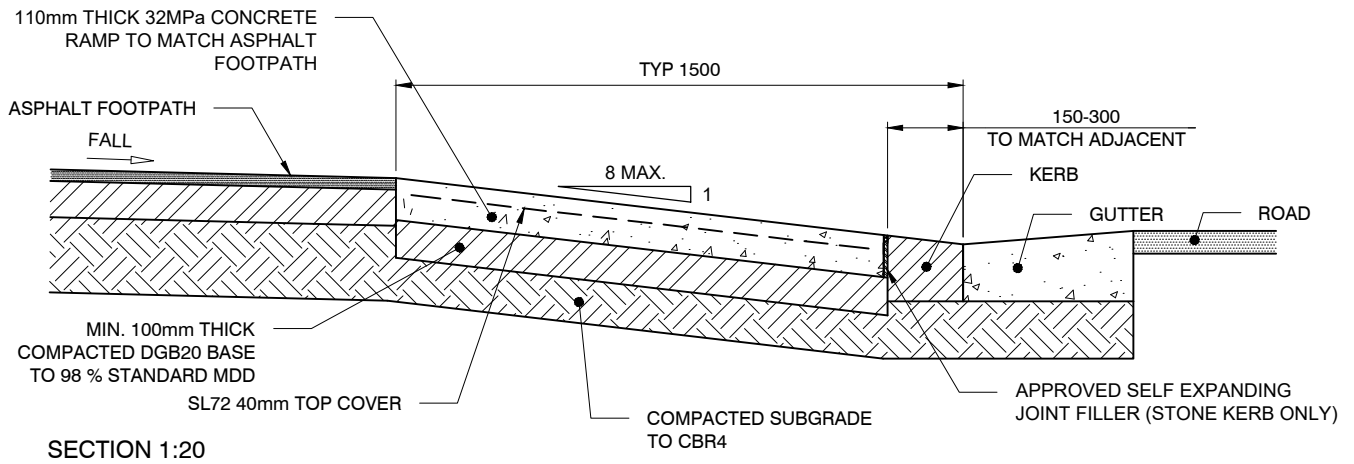

NOTE: ALL DIMENSIONS IN MILLIMETRES UNLESS OTHERWISE STATED

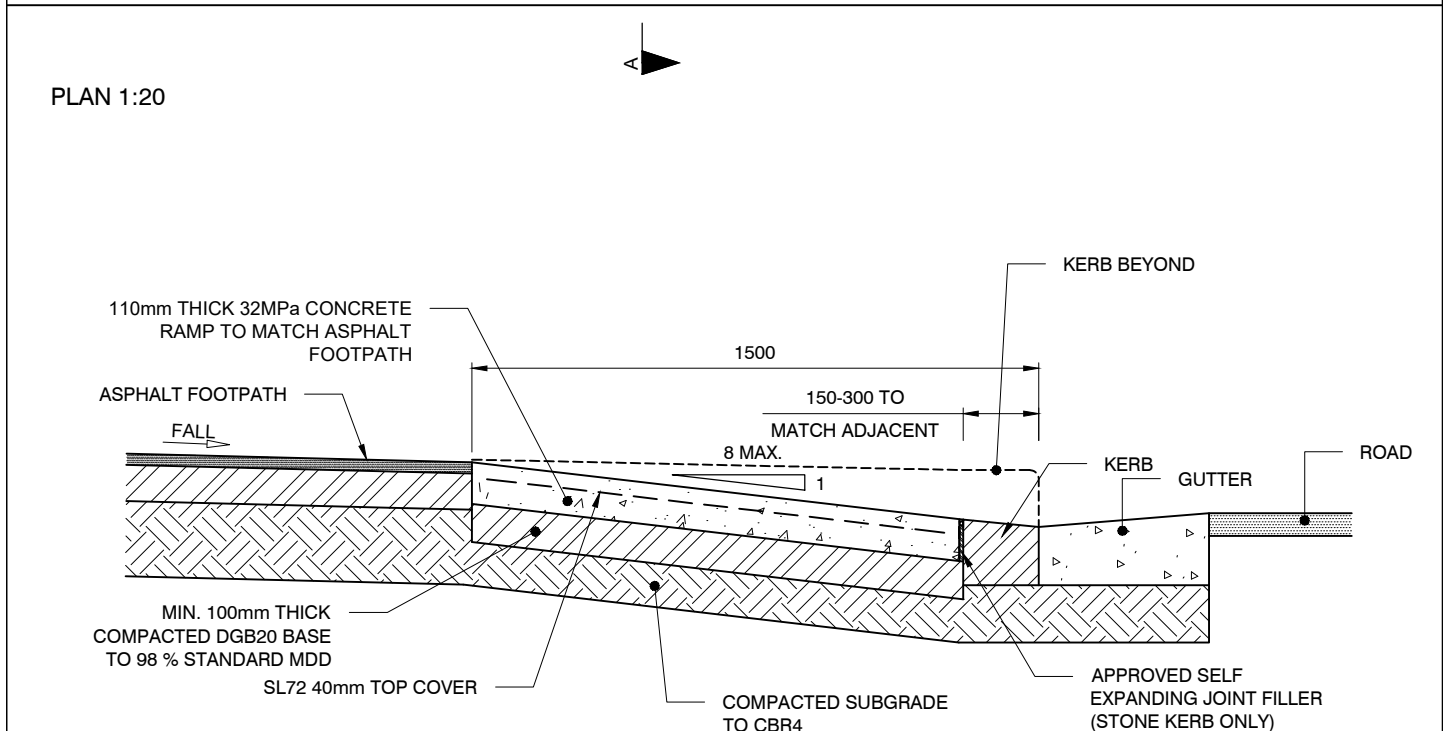
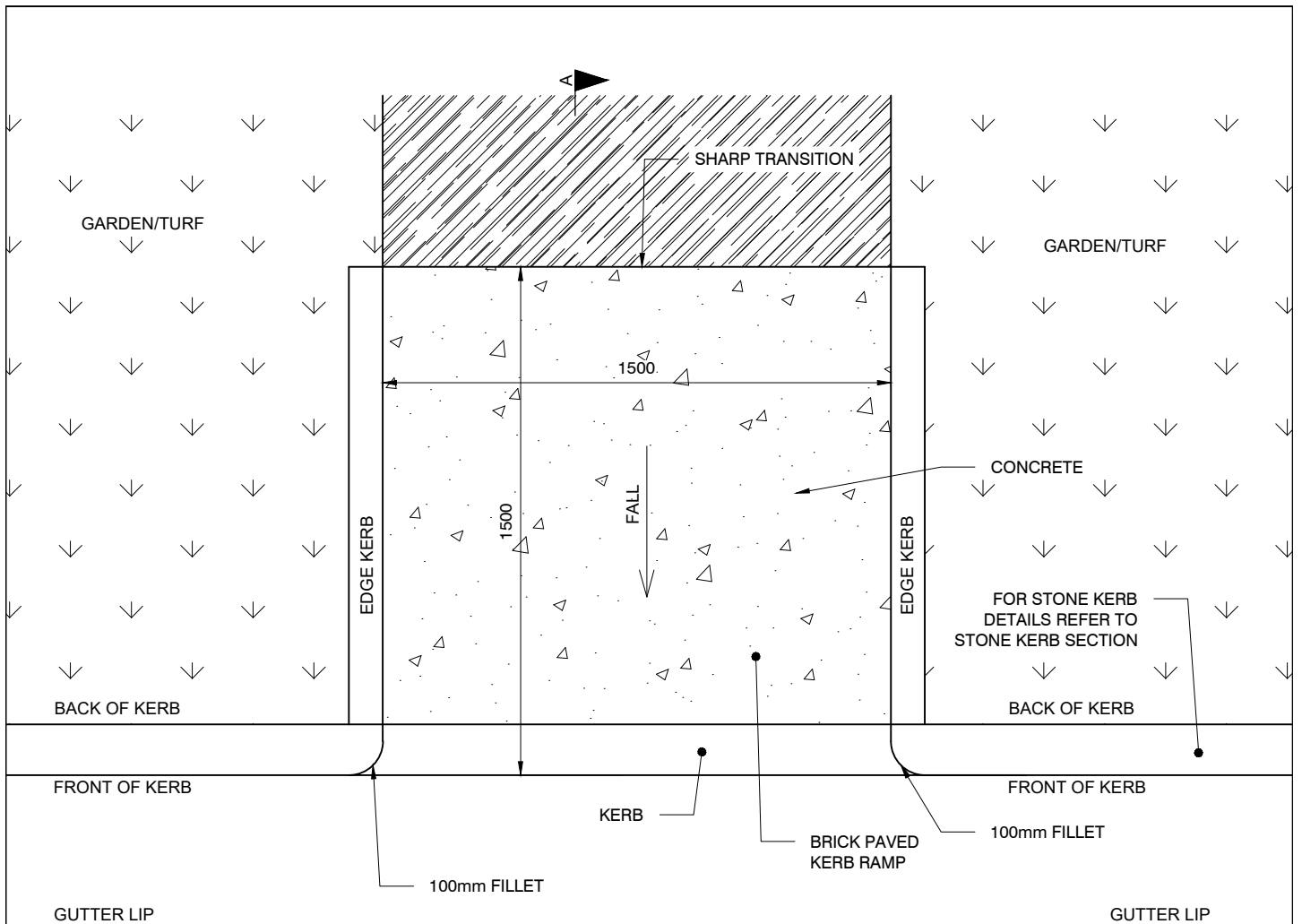

SECTION A-A 1:20

NOTE: ALL DIMENSIONS IN MILLIMETRES UNLESS OTHERWISE STATED

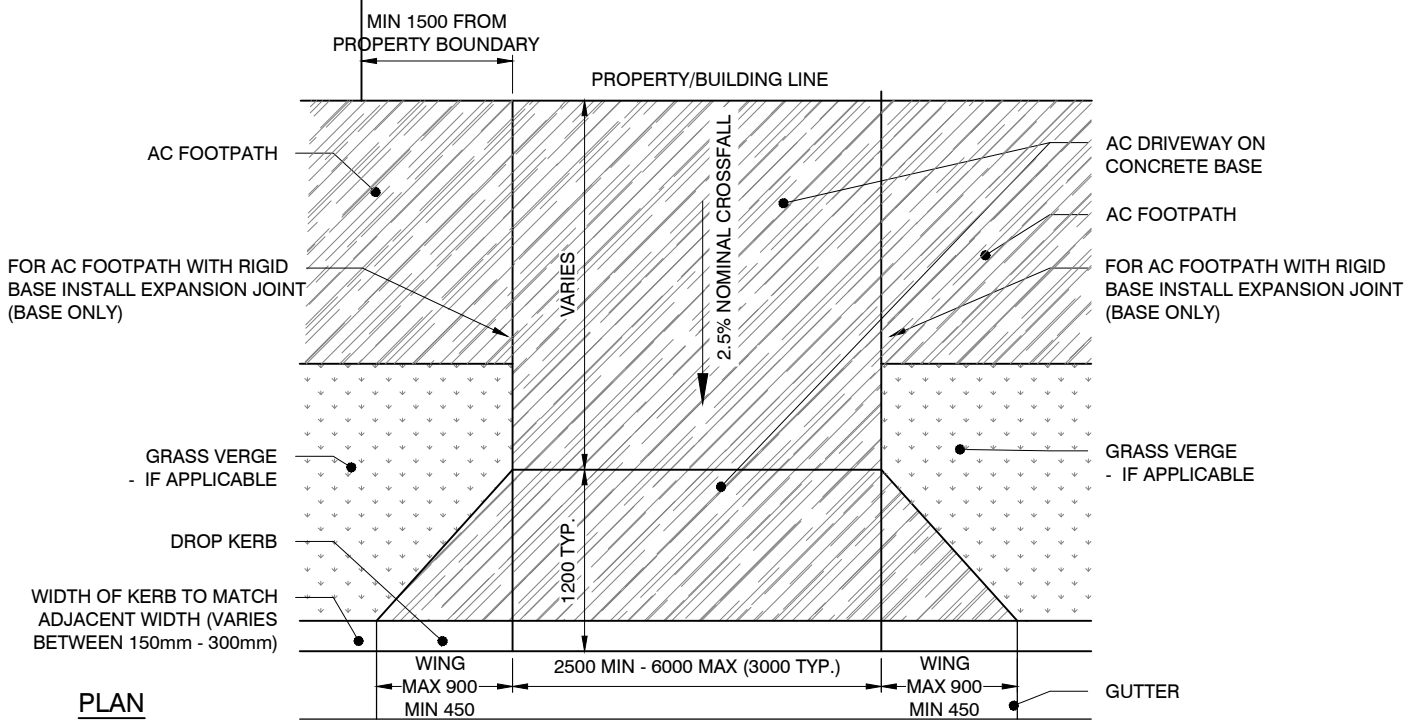

**PLAN**  
1:50

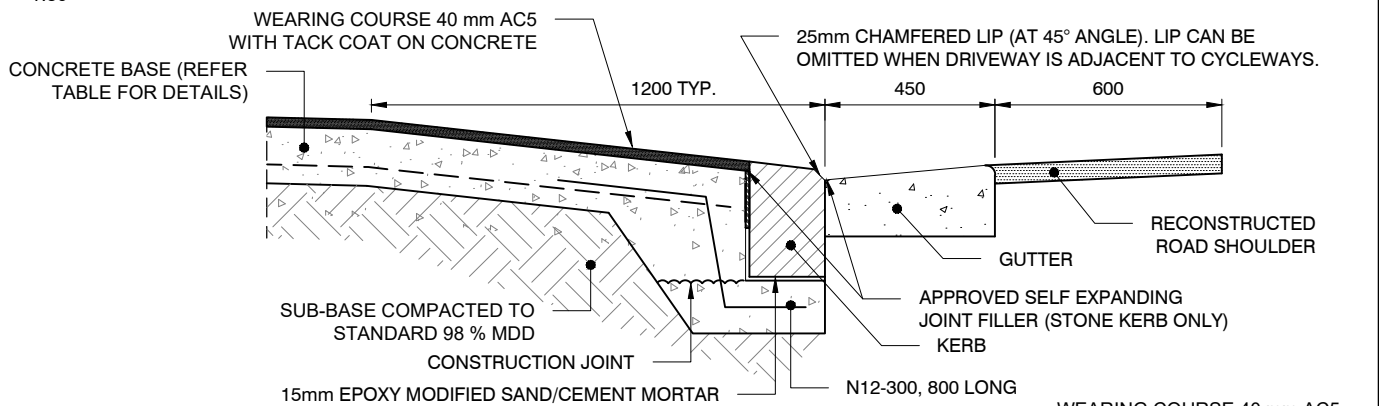

**SECTION ( WITH STONE KERB)**

1:20

DRIVEWAY SPECIFICATIONS			
DRIVEWAY USE	CONCRETE STRENGTH	THICKNESS	REINFORCEMENT
SINGLE RESIDENTIAL	32MPa	150	SL82 50 TOP COVER
MULTI RESIDENTIAL	32MPa	200	SL82 50 TOP COVER

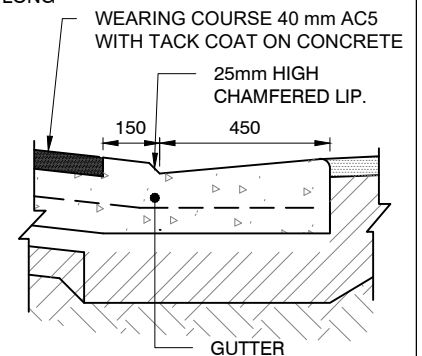

**SECTION ( WITH CONCRETE KERB)**

1:20

**NOTES:**

1. DRIVEWAY TO BE GENERALLY PERPENDICULAR TO KERB LINE, UNLESS APPROVED OTHERWISE.
2. FOR NARROW FOOTPATHS, LENGTH OF LAYBACK TO BE REDUCED TO 900mm, SUBJECT TO VEHICLE CLEARANCE OR LAYBACK ONLY TO BE USED IN APPROVED APPLICATIONS.
3. DRIVEWAY TO BE GENERALLY PERPENDICULAR TO KERB LINE, UNLESS APPROVED OTHERWISE.
4. VERTICAL AND HORIZONTAL CLEARANCE SHALL BE CHECKED BY THE DESIGNER IN ACCORDANCE WITH AS2890.1.
5. CONCRETE TO BE MINIMUM 32MPa.
6. ALL DIMENSIONS IN MILLIMETRES UNLESS OTHERWISE STATED.

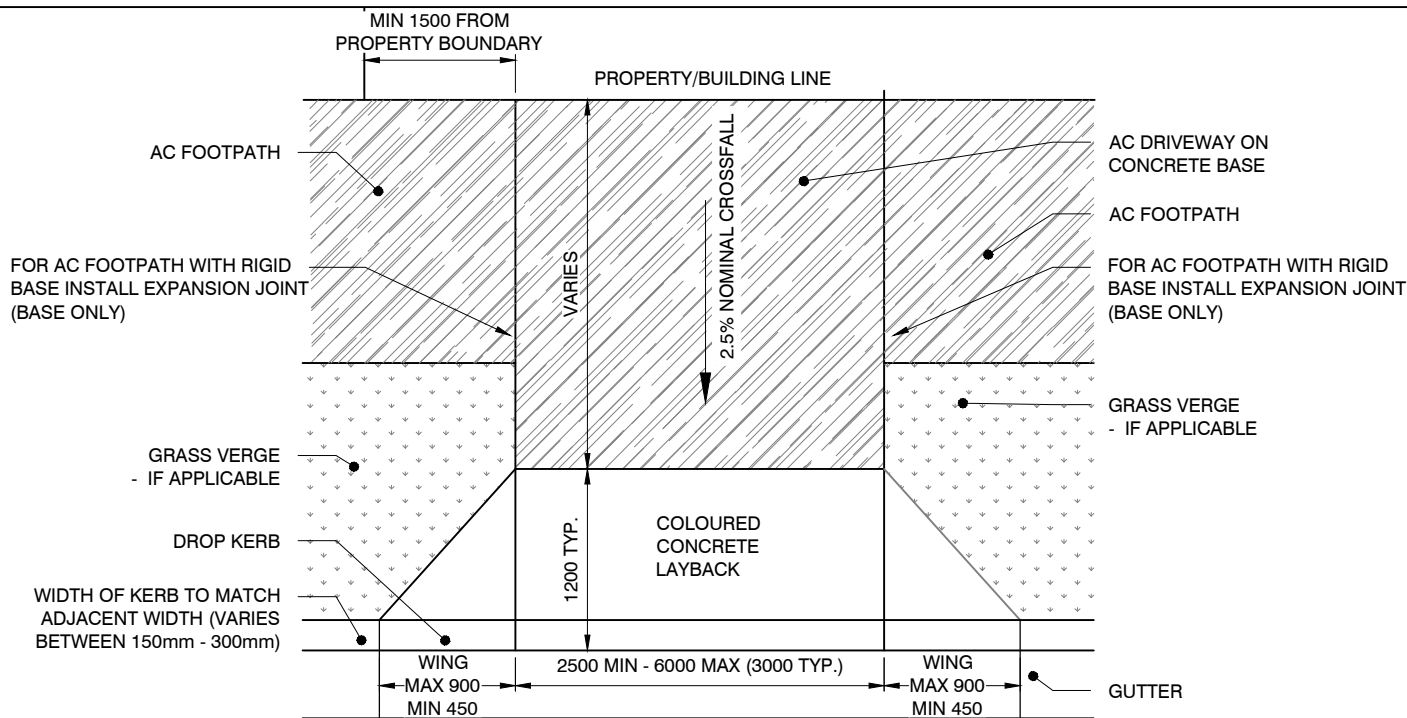

**PLAN**  
1:50

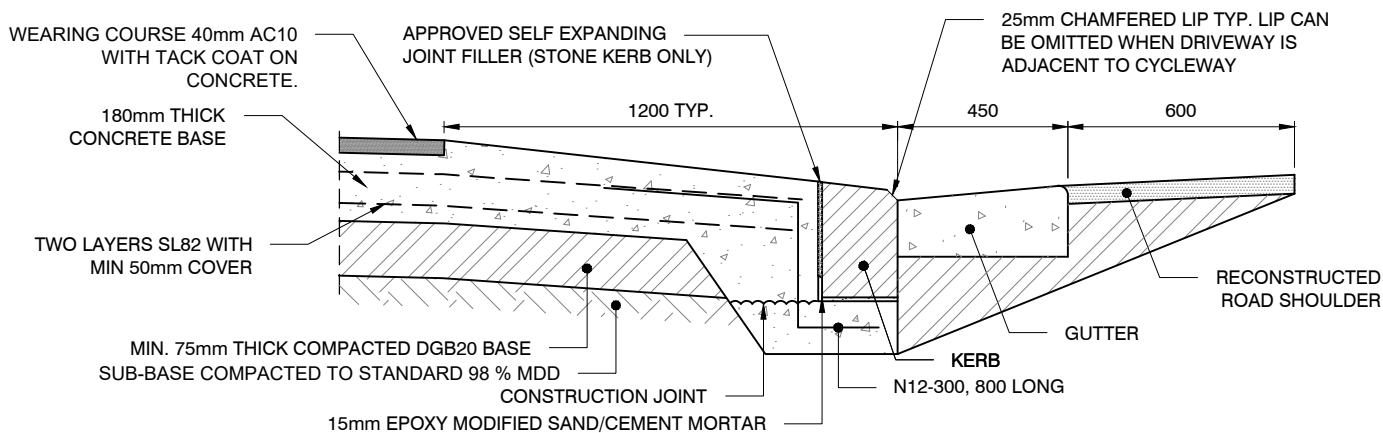

**SECTION ( WITH STONE KERB)**  
1:20

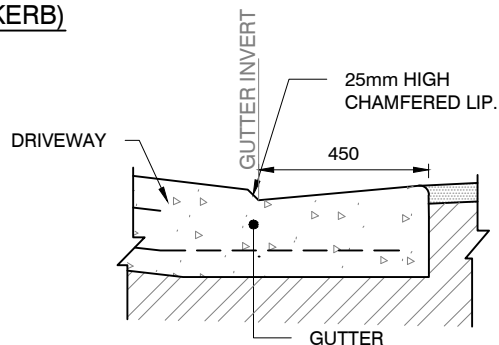

**SECTION ( WITH CONCRETE KERB)**  
1:20

**NOTES:**

1. THIS DRIVEWAY SUIT COMMERCIAL VEHICULAR CROSSINGS SUBJECT TO AXLE LOADING OF 10 TONNES OR LIGHTER.
2. DRIVEWAY TO BE GENERALLY PERPENDICULAR TO KERB LINE, UNLESS APPROVED OTHERWISE.
3. VERTICAL AND HORIZONTAL CLEARANCE SHALL BE CHECKED BY THE DESIGNER IN ACCORDANCE WITH AS2890.1.
4. FOR NARROW FOOTPATHS, LENGTH OF RAMP TO BE REDUCED TO 900mm, SUBJECT TO VEHICLE CLEARANCE OR LAYBACK ONLY TO BE USED IN APPROVED APPLICATIONS.
5. FOR DRIVEWAYS WIDER THAN 6.0m A TOOL JOINT SHALL BE PROVIDED ALONG THE CENTRE OF THE CONCRETE DRIVEWAY.
6. CONCRETE TO BE MINIMUM 32MPa.
7. TYPE OF KERB TO SUIT SYDNEY STREET CODE.
8. ALL DIMENSIONS IN MILLIMETRES UNLESS OTHERWISE STATED.

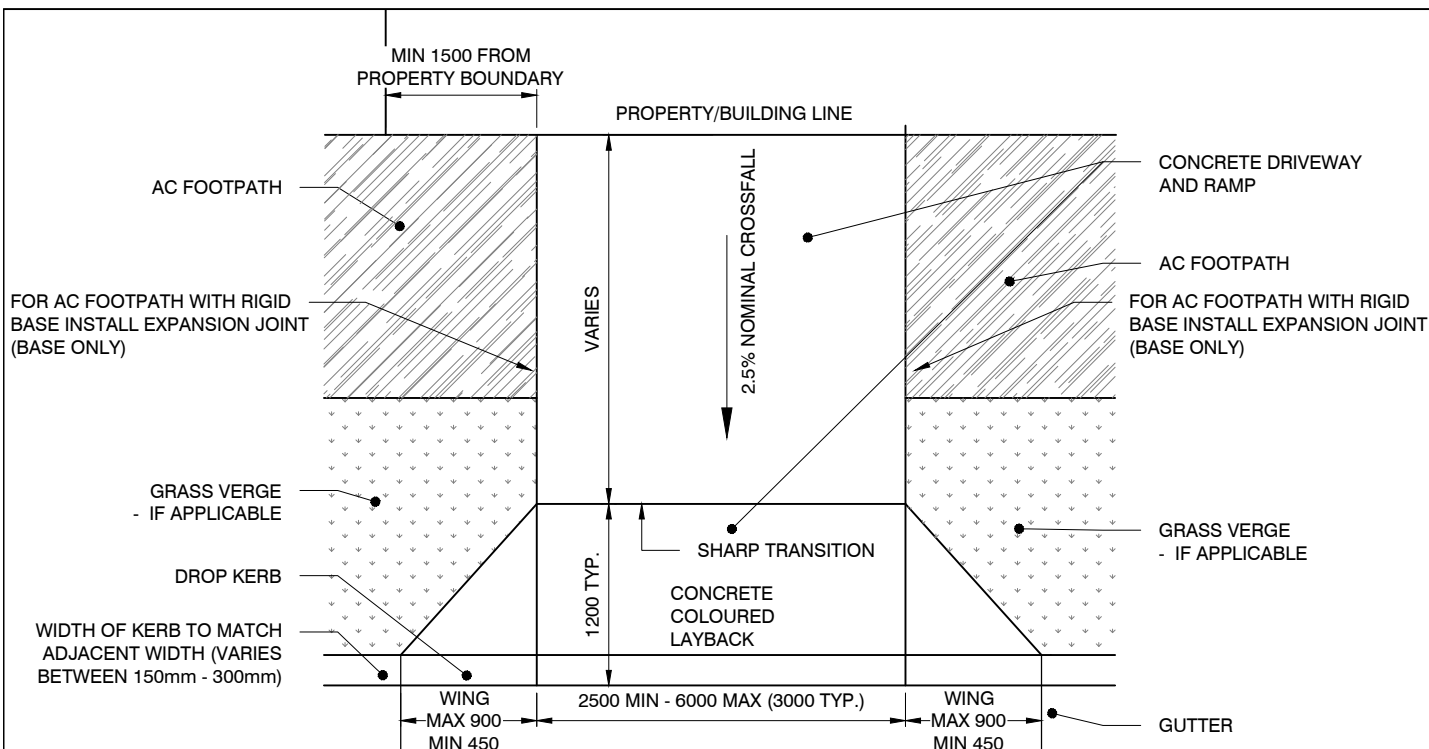

**PLAN**  
1:50

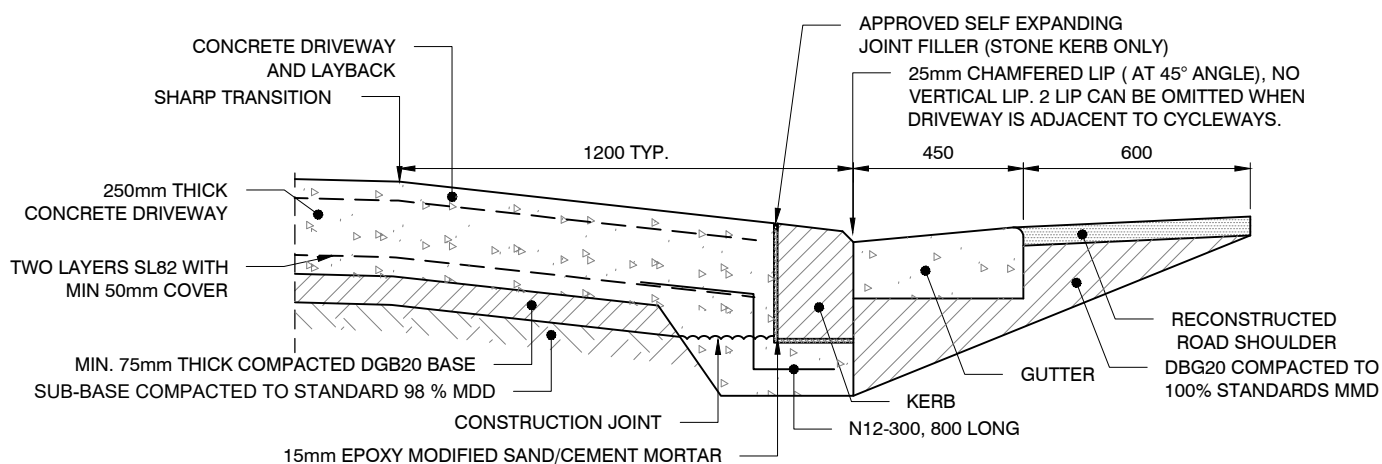

**SECTION ( WITH STONE KERB)**  
1:20

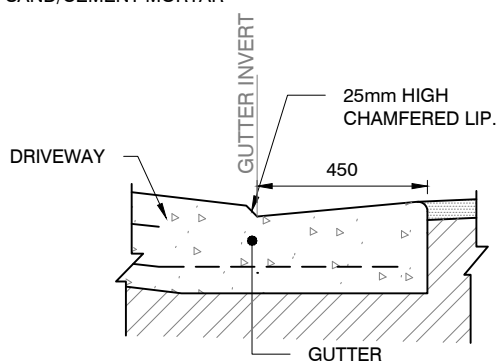

**SECTION ( WITH CONCRETE KERB)**  
1:20

**NOTES:**

1. THIS DRIVEWAY SUIT COMMERCIAL VEHICULAR CROSSINGS SUBJECTED TO AXLE LOADING HEAVIER THAN 10 TONNES.
2. DRIVEWAY TO BE GENERALLY PERPENDICULAR TO KERB LINE, UNLESS APPROVED OTHERWISE.
3. VERTICAL AND HORIZONTAL CLEARANCE SHALL BE CHECKED BY THE DESIGNER AS PER AS2890.1.
4. FOR NARROW FOOTPATHS, LENGTH OF RAMP TO BE REDUCED TO 900mm, SUBJECT TO VEHICLE CLEARANCE OR LAYBACK ONLY TO BE USED IN APPROVED APPLICATIONS.
5. FOR DRIVEWAYS WIDER THAN 6.0m A TOOL JOINT SHALL BE PROVIDED ALONG THE CENTRE OF THE CONCRETE DRIVEWAY.
6. CONCRETE TO BE MINIMUM 32MPa.
7. TYPE OF KERB TO SUIT SYDNEY STREET CODE.
8. ALL DIMENSIONS IN MILLIMETRES UNLESS OTHERWISE STATED.

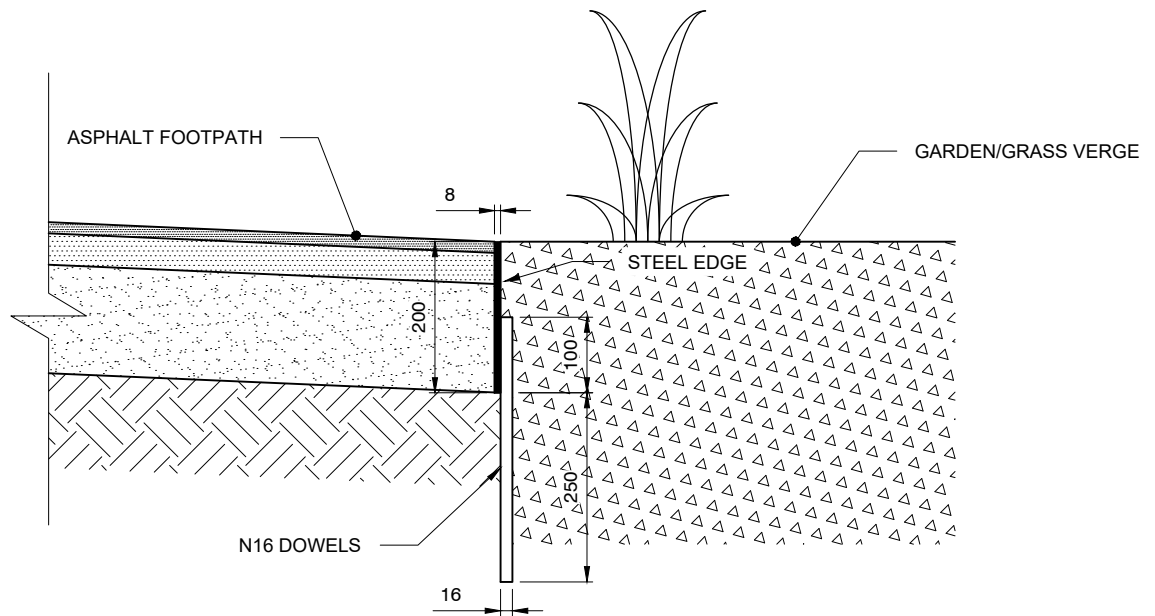

SECTION 1:10

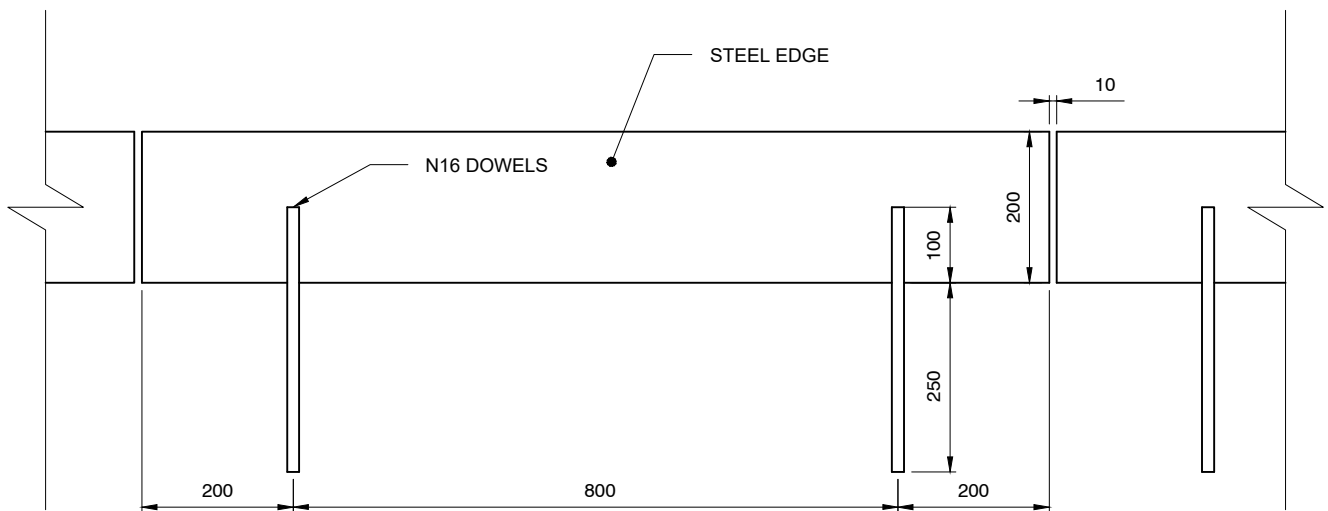

ELEVATION 1:10

NOTES:

1. ALL STEELWORK TO BE HOT DIPPED GALVANISED.
2. ALL STEELWORK BELOW GROUND LEVEL TO BE PAINTED WITH TWO COATS OF BITUMINOUS PAINT.
3. ALL DIMENSIONS IN MILLIMETRES UNLESS OTHERWISE STATED.



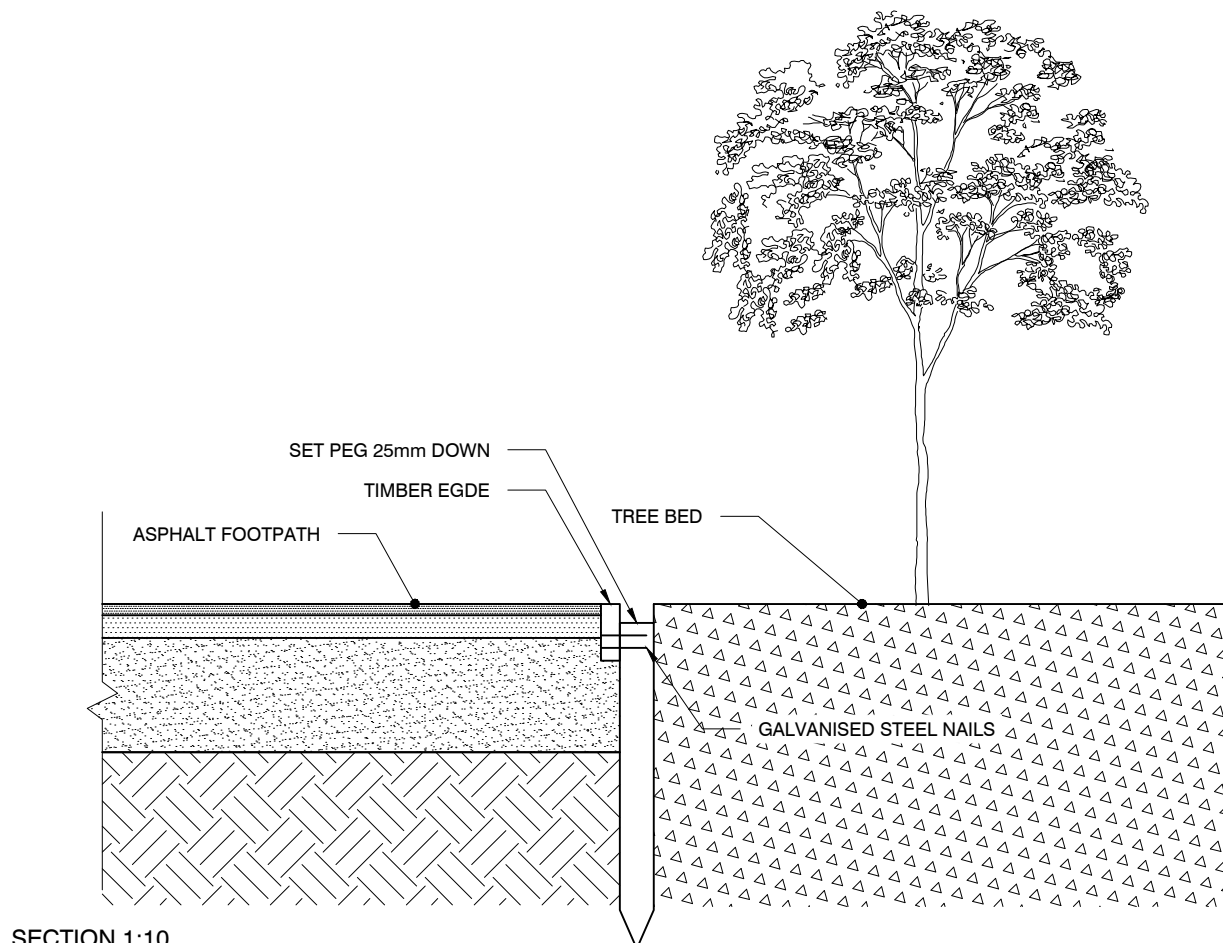

SECTION 1:10

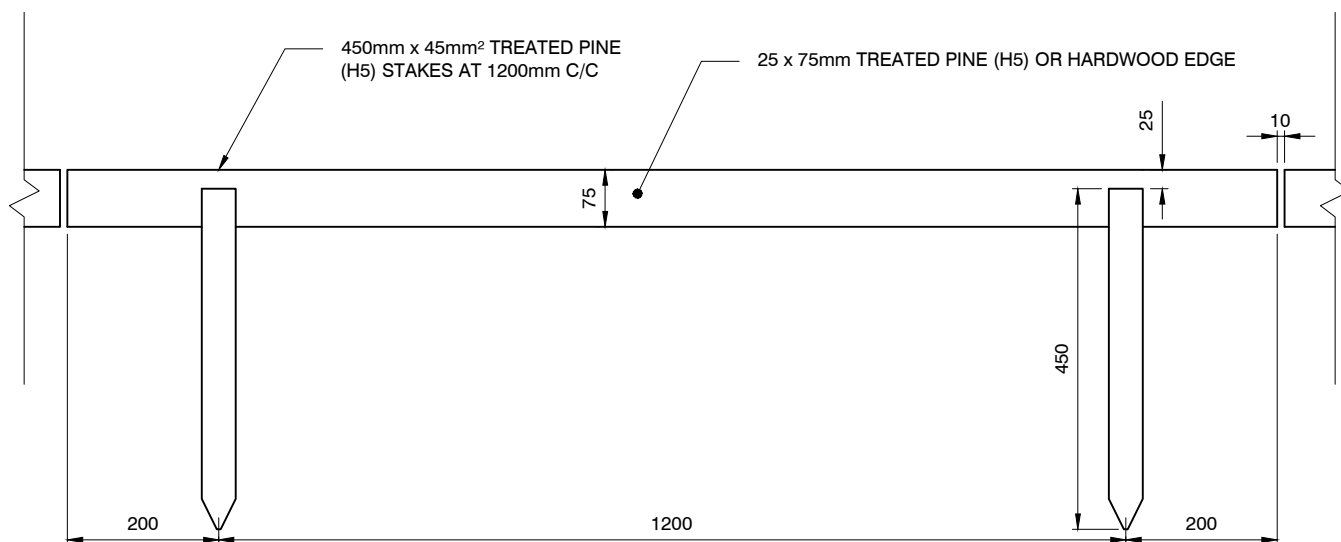

ELEVATION 1:10

NOTE: ALL DIMENSIONS IN MILLIMETRES UNLESS OTHERWISE STATED