

PLAN
1:200

NOTES:

1. FOR SIGNALISED INTERSECTION TYPE AND LOCATION OF THE POLES, DIRECTION OF THE PEDESTRIAN CROSSING AND RAMPS SHALL BE APPROVED BY CITY OF SYDNEY TRAFFIC OPERATION TEAM PRIOR TO ANY CHANGES. CONSULTATION AND OBTAINING APPROVAL FROM TfNSW ALSO MAY BE REQUIRED.
2. FOR ANY PEDESTRIAN CROSSING AT THE INTERSECTION SITE SPECIFIC LIGHTING DESIGN SHALL BE PREPARED AND APPROVAL SHALL BE OBTAINED FROM CITY OF SYDNEY'S INFRASTRUCTURE PLANNING.
3. ALL DIMENSIONS IN MILLIMETRES UNLESS OTHERWISE STATED.

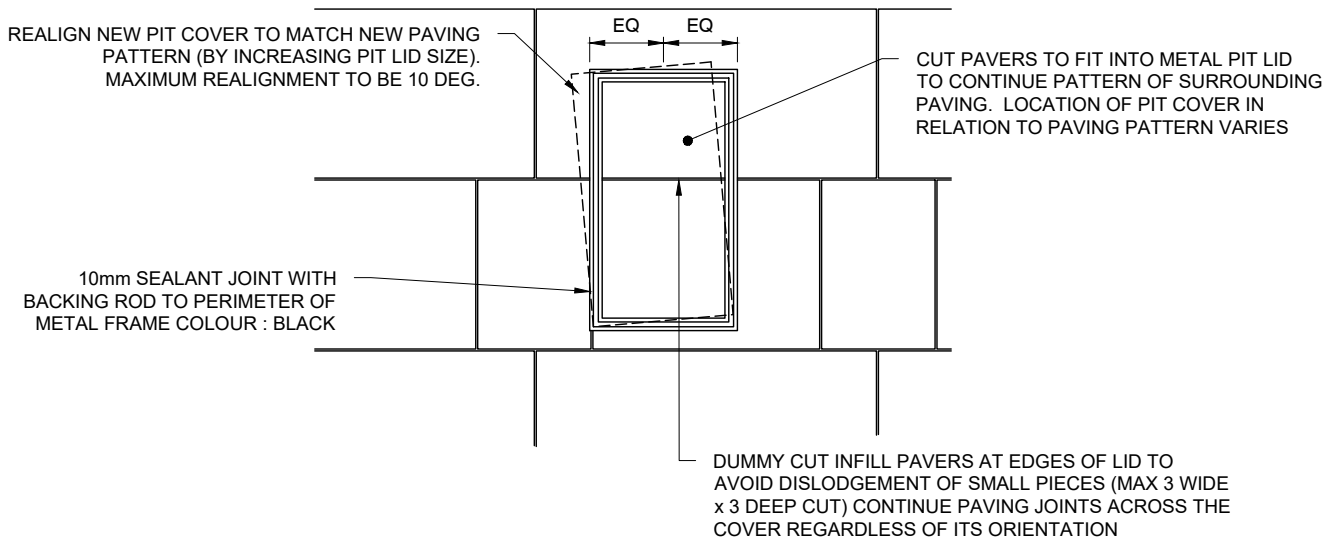

NOTES:

1. OBTAIN APPROVAL FROM AUTHORITY FOR COVER REALIGNMENT.
2. CLEAN PIT LID WITH WIRE BRUSH AND THEN WITH SOFT BRUSH TO REMOVE RUST FROM LID.
3. MOISTEN PAVER AND LID TO AID HYDRATION OF MORTAR MIX.
4. USE CEMENT MORTAR WITH FORTIFYING COMPOUND (ARDEX OR APPROVED EQUIVALENT) AS JOINTING MATERIAL.
5. USE A RICHER MIX eg. 1:1 CEMENT:SAND THINNER (2-5mm) JOINTS AND 1:2.5 CEMENT:SAND MIX FOR THICKER (12-15mm) JOINT.
6. PIT LID INFILLS TO HAVE APPROX. 3mm GAP ON SIDES SO AS TO NOT TOUCH THE LID.
7. GAPS ON SIDES SHOULD BE GROUTED WITH RICH CEMENT SAND MIX WITH FORTIFYING COMPOUND.
8. TO ENSURE THE SERVICE PIT IS STILL ACCESSIBLE AND FIT FOR USE THE RELEVANT AUTHORITY IS TO PROVIDE SIGN OFF / APPROVAL.
9. PIT COVERS IN THE FOOTPATH SHALL COMPLY WITH CLASS 'C' LOADING AND FOR TRAFFICABLE AREA, PIT COVERS SHALL COMPLY WITH CLASS 'D' LOADING.
10. ALL DIMENSIONS IN MILLIMETRES UNLESS OTHERWISE STATED.

PLAN 1:50

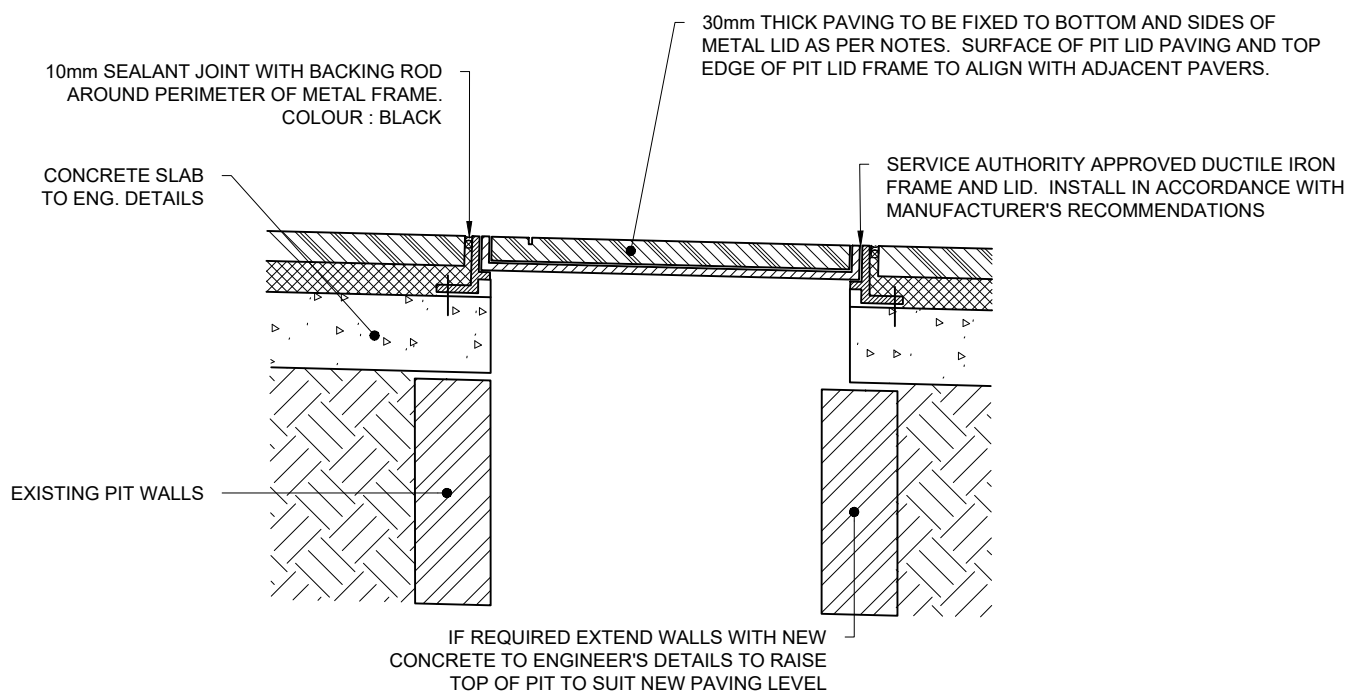

SECTION 1:10

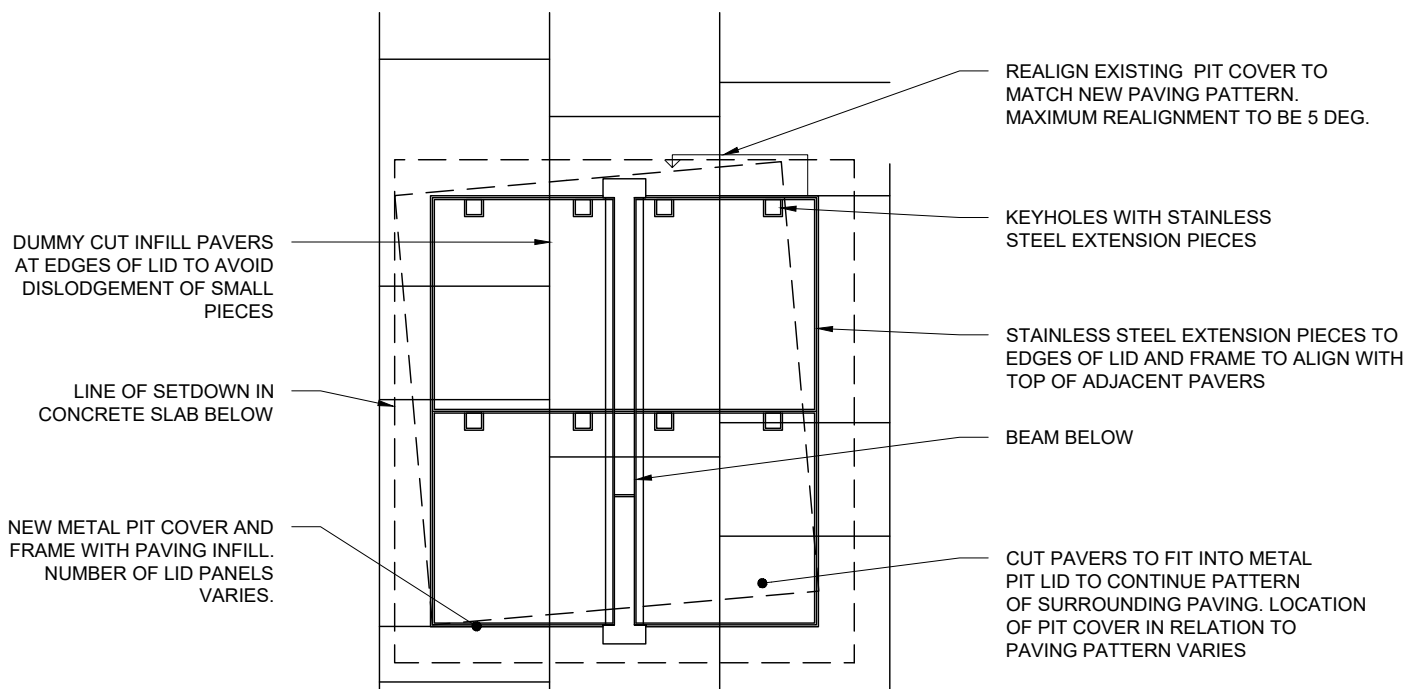

PLAN 1:20

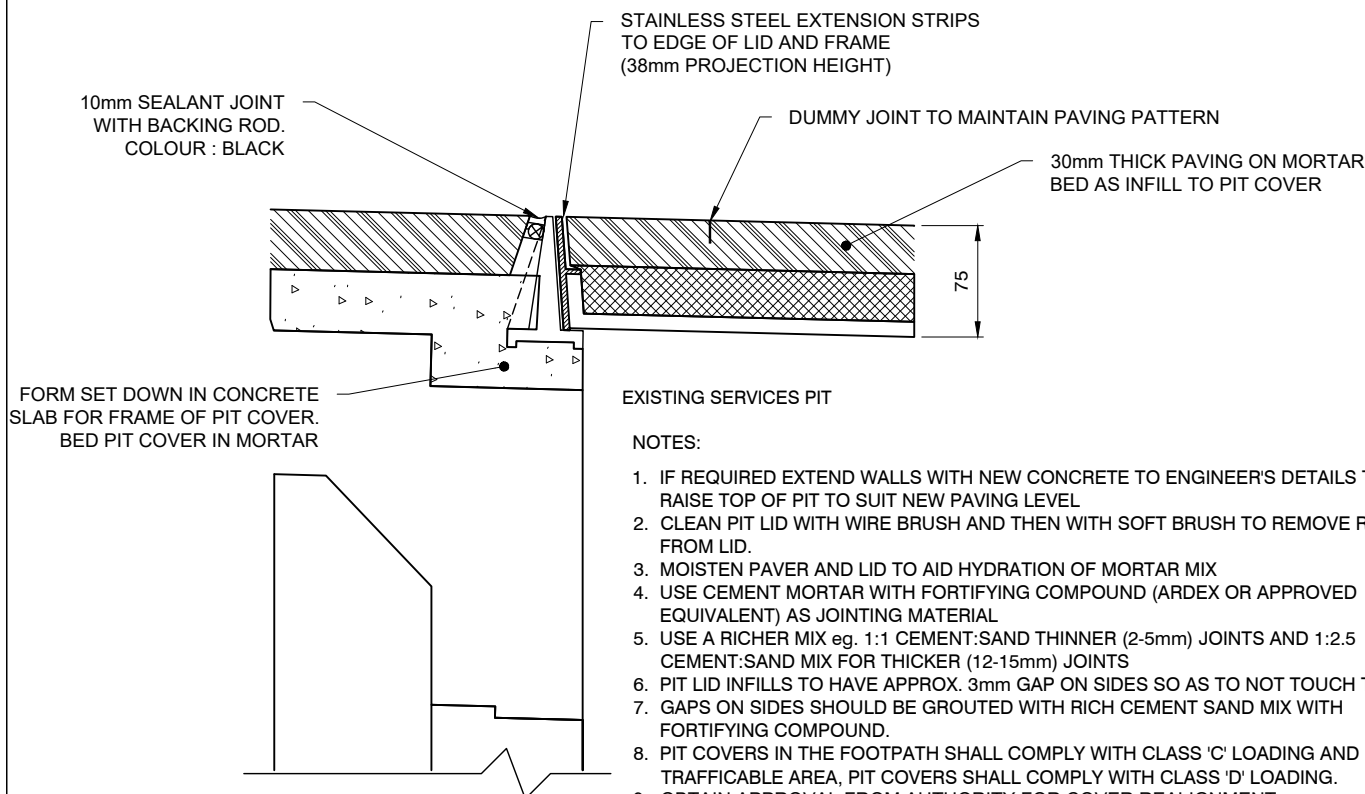

SECTION 1:5

NOTES:

1. IF REQUIRED EXTEND WALLS WITH NEW CONCRETE TO ENGINEER'S DETAILS TO RAISE TOP OF PIT TO SUIT NEW PAVING LEVEL
2. CLEAN PIT LID WITH WIRE BRUSH AND THEN WITH SOFT BRUSH TO REMOVE RUST FROM LID.
3. MOISTEN PAVER AND LID TO AID HYDRATION OF MORTAR MIX
4. USE CEMENT MORTAR WITH FORTIFYING COMPOUND (ARDEX OR APPROVED EQUIVALENT) AS JOINTING MATERIAL
5. USE A RICHER MIX eg. 1:1 CEMENT:SAND THINNER (2-5mm) JOINTS AND 1:2.5 CEMENT:SAND MIX FOR THICKER (12-15mm) JOINTS
6. PIT LID INFILLS TO HAVE APPROX. 3mm GAP ON SIDES SO AS TO NOT TOUCH THE LID
7. GAPS ON SIDES SHOULD BE GROUTED WITH RICH CEMENT SAND MIX WITH FORTIFYING COMPOUND.
8. PIT COVERS IN THE FOOTPATH SHALL COMPLY WITH CLASS 'C' LOADING AND FOR TRAFFICABLE AREA, PIT COVERS SHALL COMPLY WITH CLASS 'D' LOADING.
9. OBTAIN APPROVAL FROM AUTHORITY FOR COVER REALIGNMENT.
10. TO ENSURE THE SERVICE PIT IS STILL ACCESSIBLE AND FIT FOR USE THE RELEVANT AUTHORITY IS TO PROVIDE SIGN OFF / APPROVAL
11. ALL DIMENSIONS IN MILLIMETRES UNLESS OTHERWISE STATED.

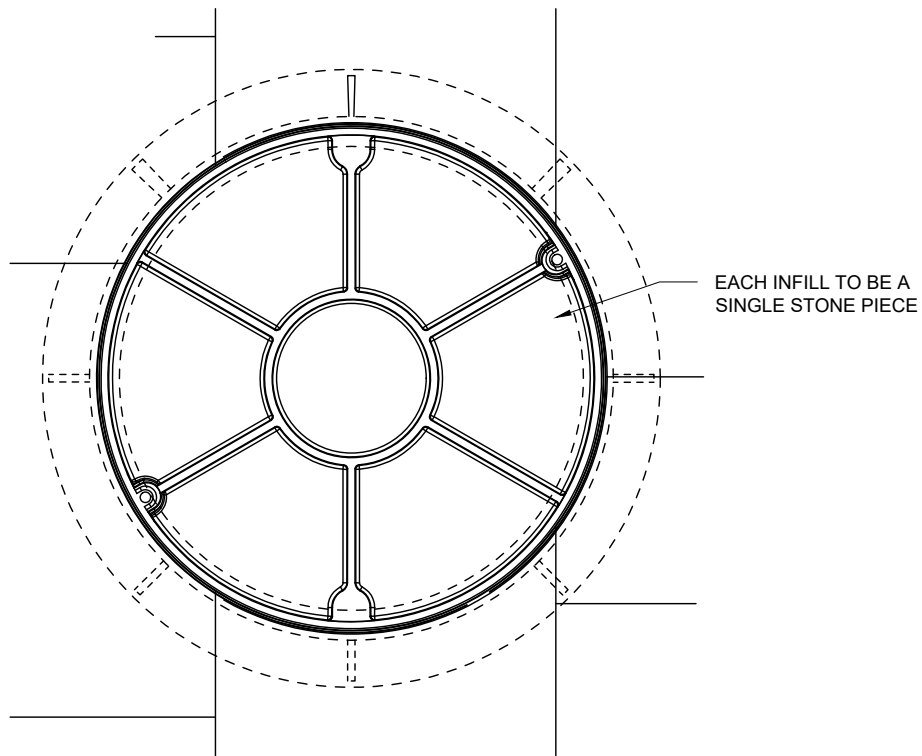

PLAN 1:10

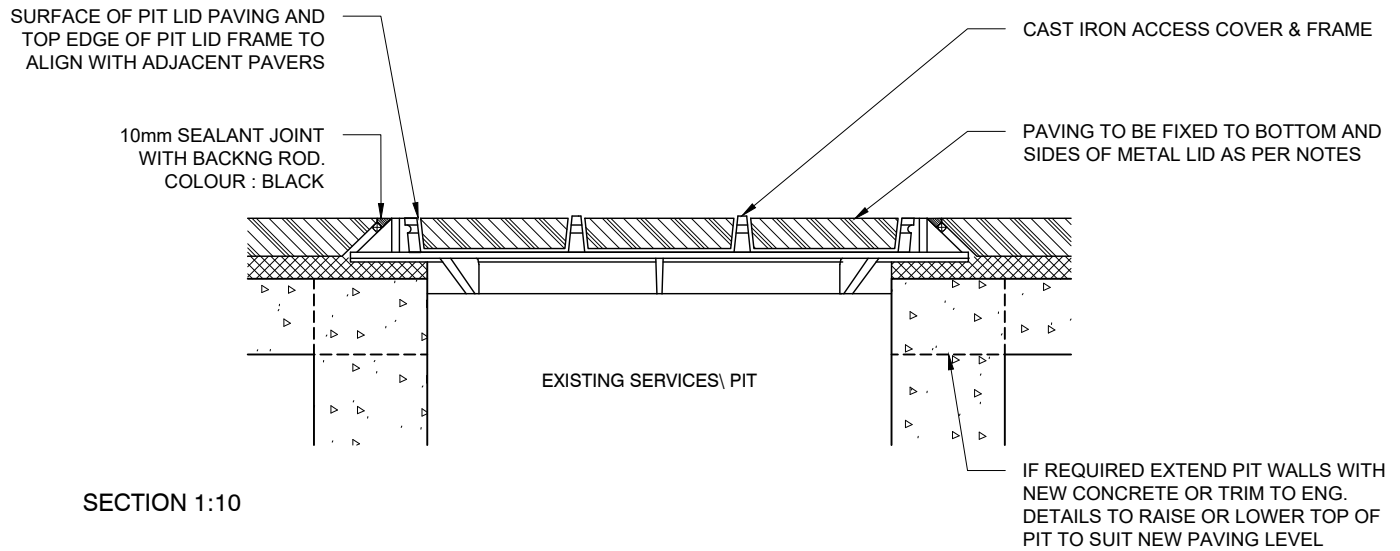

SECTION 1:10

NOTES:

1. CLEAN PIT LID WITH BRUSH AND THEN SOFT BRUSH TO CLEAR RUST FROM LID
2. MOISTEN PAVER AND LID TO AID HYDRATION OF MORTAR MIX
3. USE CEMENT MORTAR WITH FORTIFYING COMPOUND (ARDEX OR APPROVED EQUIVALENT) AS JOINTING MATERIALS
4. USE A RICHER MIX eg: 1:1 CEMENT:SAND FOR THINNER (3-5mm) JOINTS AND 1:2.5 CEMENT:SAND MIX FOR THICKER (12-15mm) JOINTS
5. PIT LID INFILLS TO HAVE APPROX. 3mm GAP ON SIDES SO AS NOT TO TOUCH THE LID
6. GAPS ON SIDES SHOULD BE GROUTED WITH RICH CEMENT SAND MIX WITH FORTIFYING COMPOUND.
7. TO ENSURE THE SERVICE PIT IS STILL ACCESSIBLE AND FIT FOR USE THE RELEVANT AUTHORITY IS TO PROVIDE SIGN OFF / APPROVAL
8. PIT COVERS IN THE FOOTPATH SHALL COMPLY WITH CLASS 'C' LOADING AND FOR TRAFFICABLE AREA, PIT COVERS SHALL COMPLY WITH CLASS 'D' LOADING.
9. ALL DIMENSIONS IN MILLIMETRES UNLESS OTHERWISE STATED.

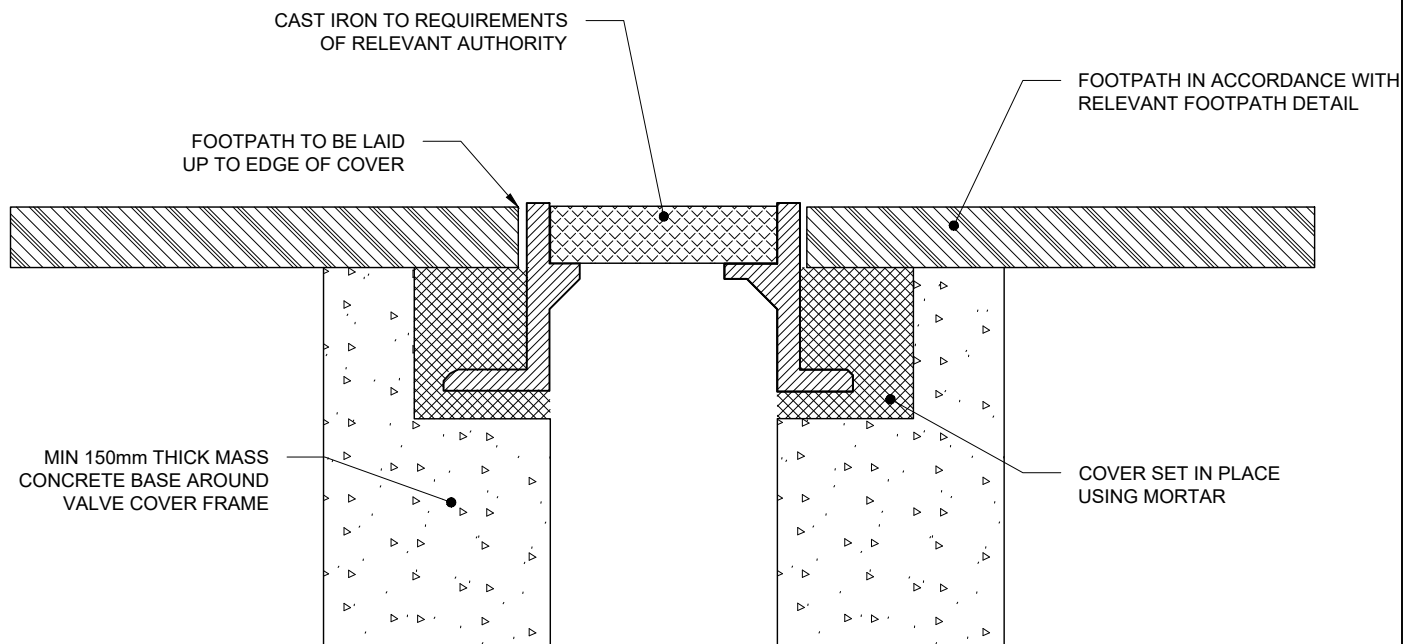

NOTE:

1. TO ENSURE THE SERVICE VALVE IS STILL ACCESSIBLE, THE RELEVANT AUTHORITY IS TO PROVIDE SIGN OFF / APPROVAL
2. FOR FIRE FIGHTING OPERATIONS, SERVICE VALVE COVERS ARE TO BE REINSTATED IN ACCORDANCE WITH THE WATER SUPPLY CODE OF AUSTRALIA WSA 03-2002-2.2 SYDNEY WATER EDITION VERSION, AND SPECIFICALLY DRAWINGS WAT-1305-V AND WAT-1306-V. ON COMPLETION THE NSWFB ZONE COMMANDERS EAST ONE (TEL: 0419 993 065) SHOULD BE CONTACTED TO ARRANGE TESTING TO ENSURE COMPLIANCE. TYPICALLY, THE CBD HAS SCREW HYDRANTS WHILST OUTSIDE CBD, SPRING HYDRANTS ARE USED.
3. WHERE PIT LID IS GREATER THAN 300mm IN ANY DIRECTION, AN INFILL LID IS TO BE USED.
4. PIT COVERS IN THE FOOTPATH SHALL COMPLY WITH CLASS 'C' LOADING AND FOR TRAFFICABLE AREA PIT COVERS SHALL COMPLY WITH CLASS 'D' LOADING.
5. ALL DIMENSIONS IN MILLIMETRES UNLESS OTHERWISE STATED.

SCALE 1:5

TYPICAL PLAN

100mm DEEP SELF EXPANDING JOINT
FILLER IN CASE OF SURROUNDING AREA
BEING INFLEXIBLE PAVEMENT (eg
CONCRETE)

SERVICE PIT

FOOTPATH / ROAD AREA

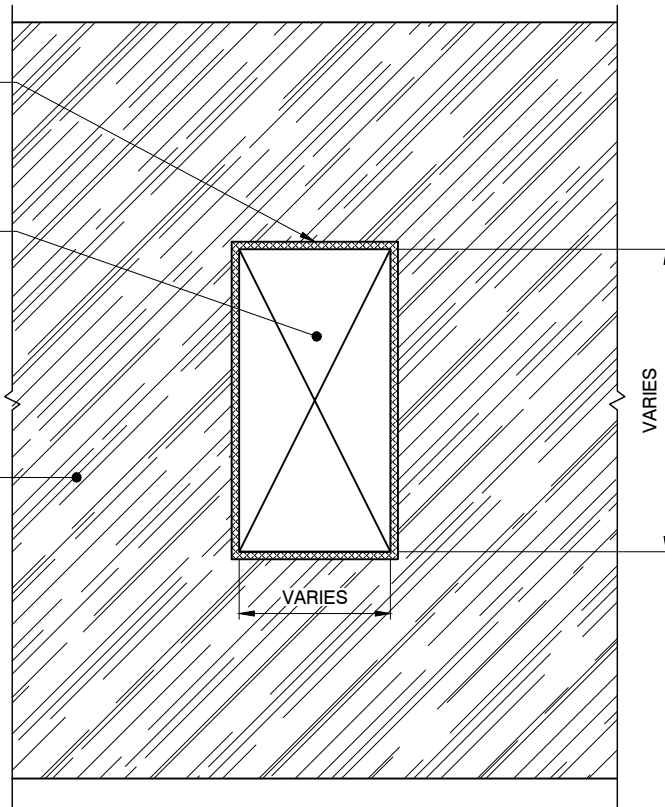

FLEXIBLE PAVEMENT ELEVATION

FLEXIBLE PAVEMENT

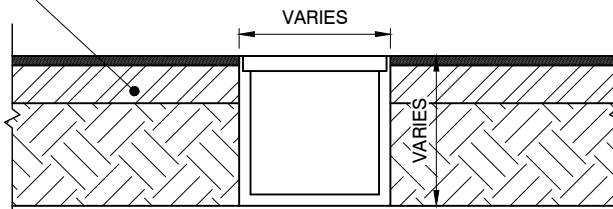

RIGID PAVEMENT ELEVATION

SELF EXPANDING JOINT FILLER
TO DEPTH OF RIGID PAVEMENT

RIGID PAVEMENT

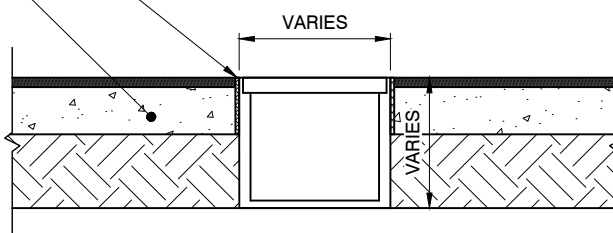

SCALE 1:20

NOTE: ALL DIMENSIONS IN MILLIMETRES UNLESS OTHERWISE STATED

JUNCTION ALONG PROPERTY BOUNDARY

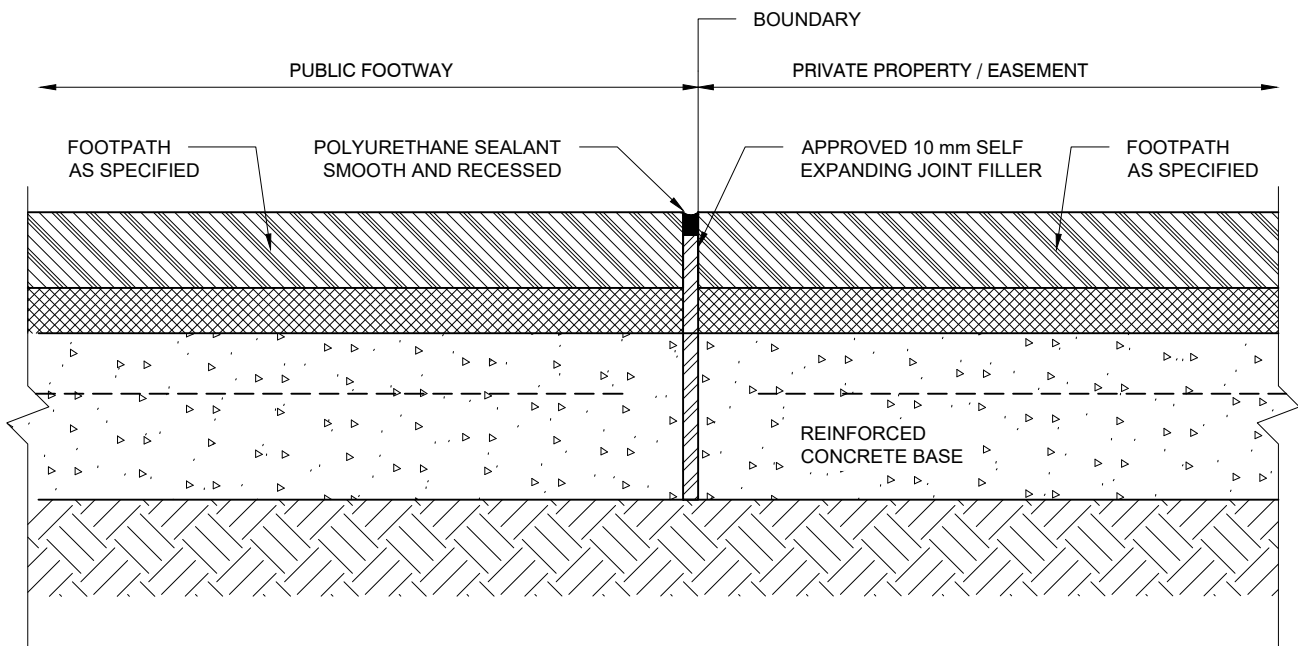

SECTION 1:5

NOTE: ALL DIMENSIONS IN MILLIMETRES UNLESS OTHERWISE STATED

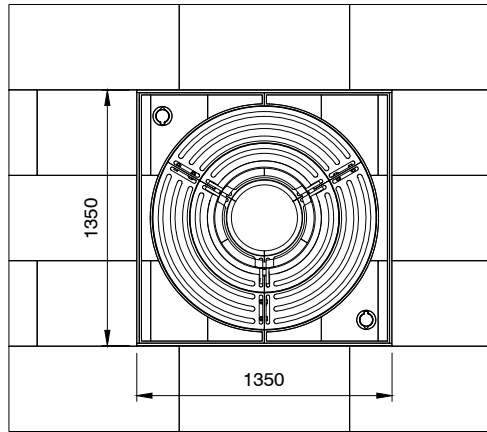

PLAN

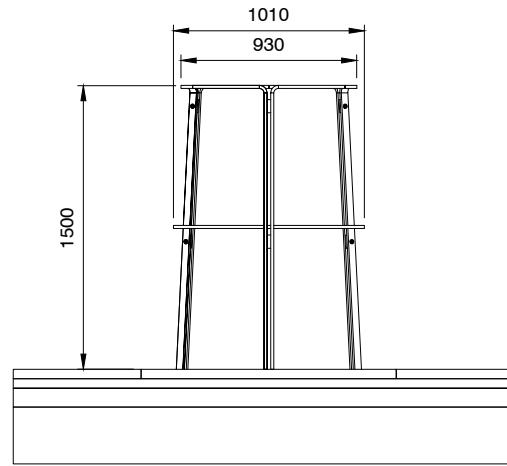

ELEVATION - FRONT

STANDARD TREE GUARD AND TREE GRATE 1:25

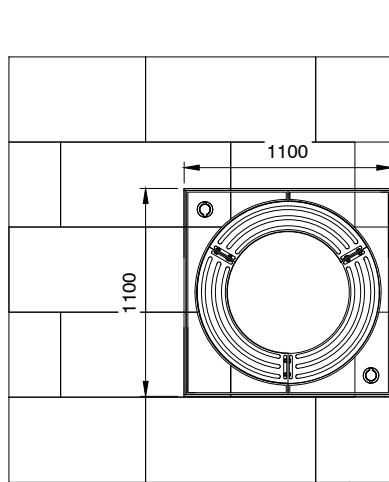

PLAN

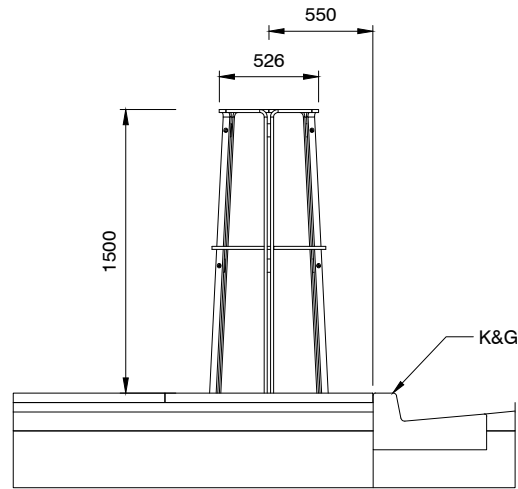

ELEVATION - FRONT

SLIMMED DESIGN TREE GUARD AND TREE GRATE 1:25

ANCHOR BOLT DETAILS REFER TO
MANUFACTURER'S SPEC

30mm THICK
MORTAR BED
MAXIMUM

PAVER

TREE
GRATE

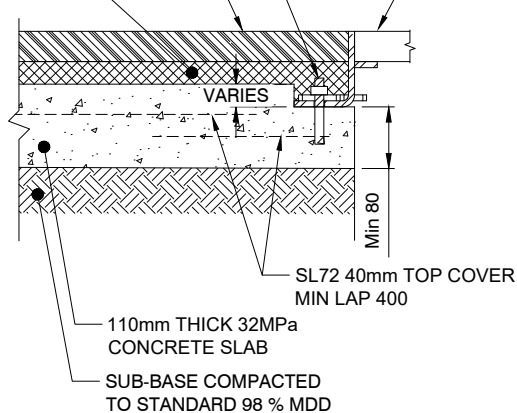

FRAME INSTALLATION DETAILS
1:10

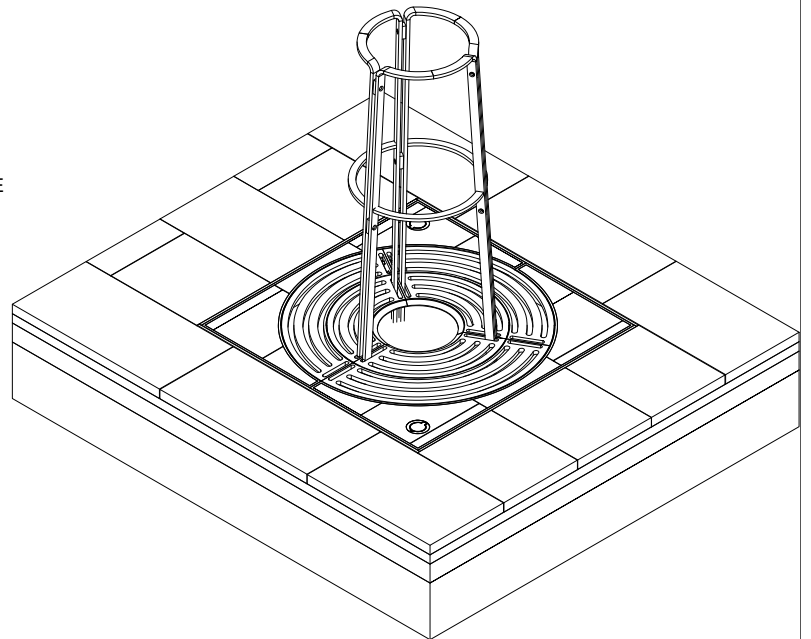

ISOMETRIC VIEW
N.T.S.

NOTES:

1. FOR DESIGN DETAILS AND INSTALLATION GUIDES REFER TO MANUFACTURER'S SPECIFICATION
2. ALL DIMENSIONS IN MILLIMETRES UNLESS OTHERWISE STATED.

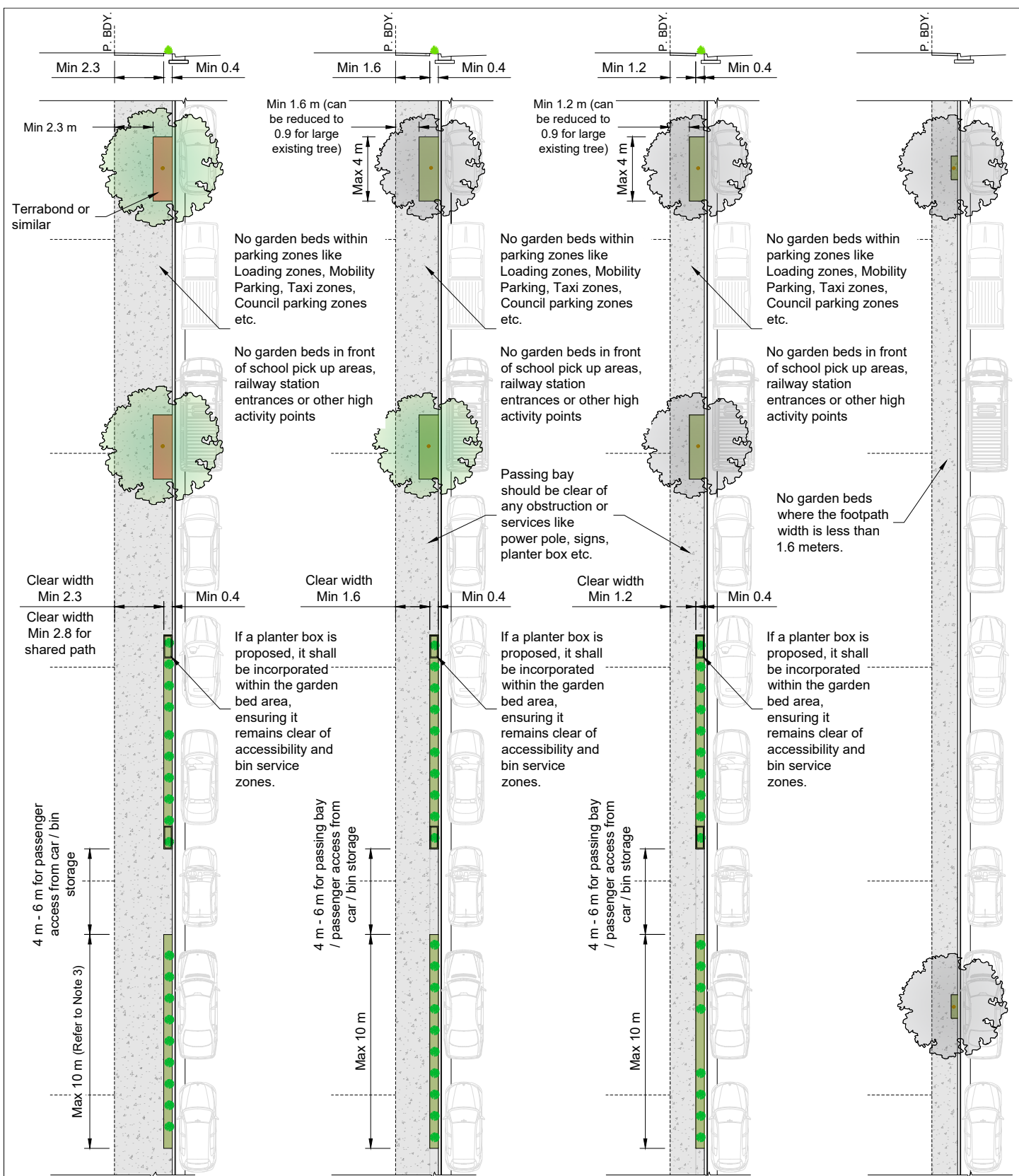

FOOTPATH ≥ 2.7 m WIDE ⁽¹⁾

1:250 - LOCAL STREET (Mid to High Activity Streets)

FOOTPATH ≥ 2 m < 2.7 m WIDE ⁽¹⁾

1:250 - LOCAL STREET (Low Activity Streets)

FOOTPATH ≥ 1.6 < 2 m WIDE ⁽¹⁾

FOOTPATH < 1.6 m WIDE ⁽¹⁾

NOTES:

1. The footpath width shown is measured from the property boundary to the back of the kerb.
2. The minimum footpath width must comply with the Sydney Street Code & Inclusive and Accessible Public Domain Guidelines. If existing trees prevent this, the specified minimum width for various scenarios may be applied, with a priority on maximising footpath width.
3. In No Stopping zones, garden beds can be extended or made continuous, provided the clear footpath width complies with the Sydney Street Code and the section of the street is not serviced by a refuse vehicle.
4. Greening should be planned in consultation with the Infrastructure Services, City's Urban Forest Team, Waste Collection Team and City Greening and Leisure Operations to ensure that greening is viable, meets operational needs and provides direct access to kerb where required
5. Garden beds shall have a minimum depth of 500mm. If this depth cannot be achieved or if an awning is present, consultation with the Parks Team is required to ensure an appropriate design and planting solution is implemented.
6. In locations where a minimum 2.3m continuous and accessible path of travel is available and access to kerb is not required, then continuous planting may be considered