

PLAN 1:100

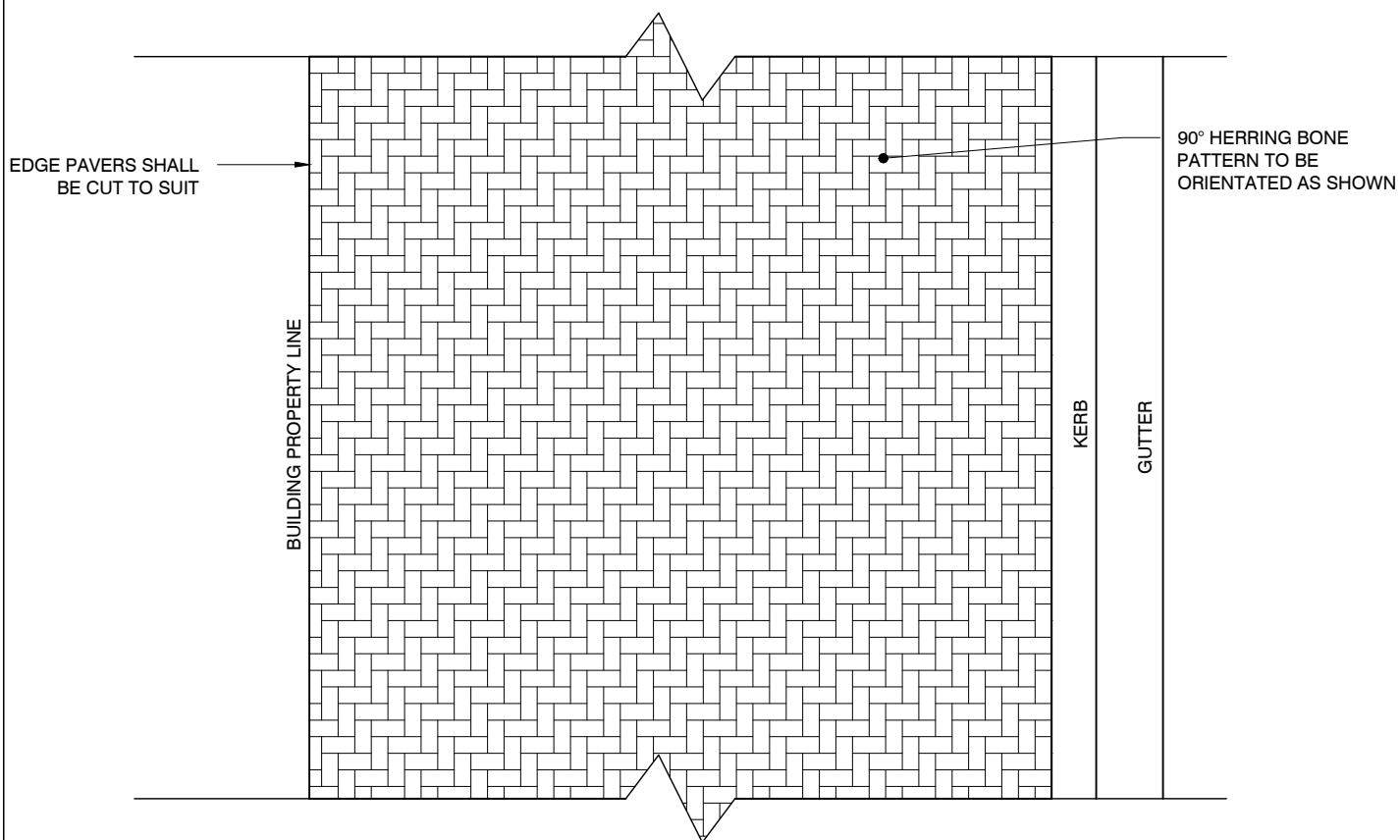

TYPICAL PAVING MODULE 1:50

NOTE: ALL DIMENSIONS IN MILLIMETRES UNLESS OTHERWISE STATED

BRICK PAVING CORNER ARRANGEMENT PLAN

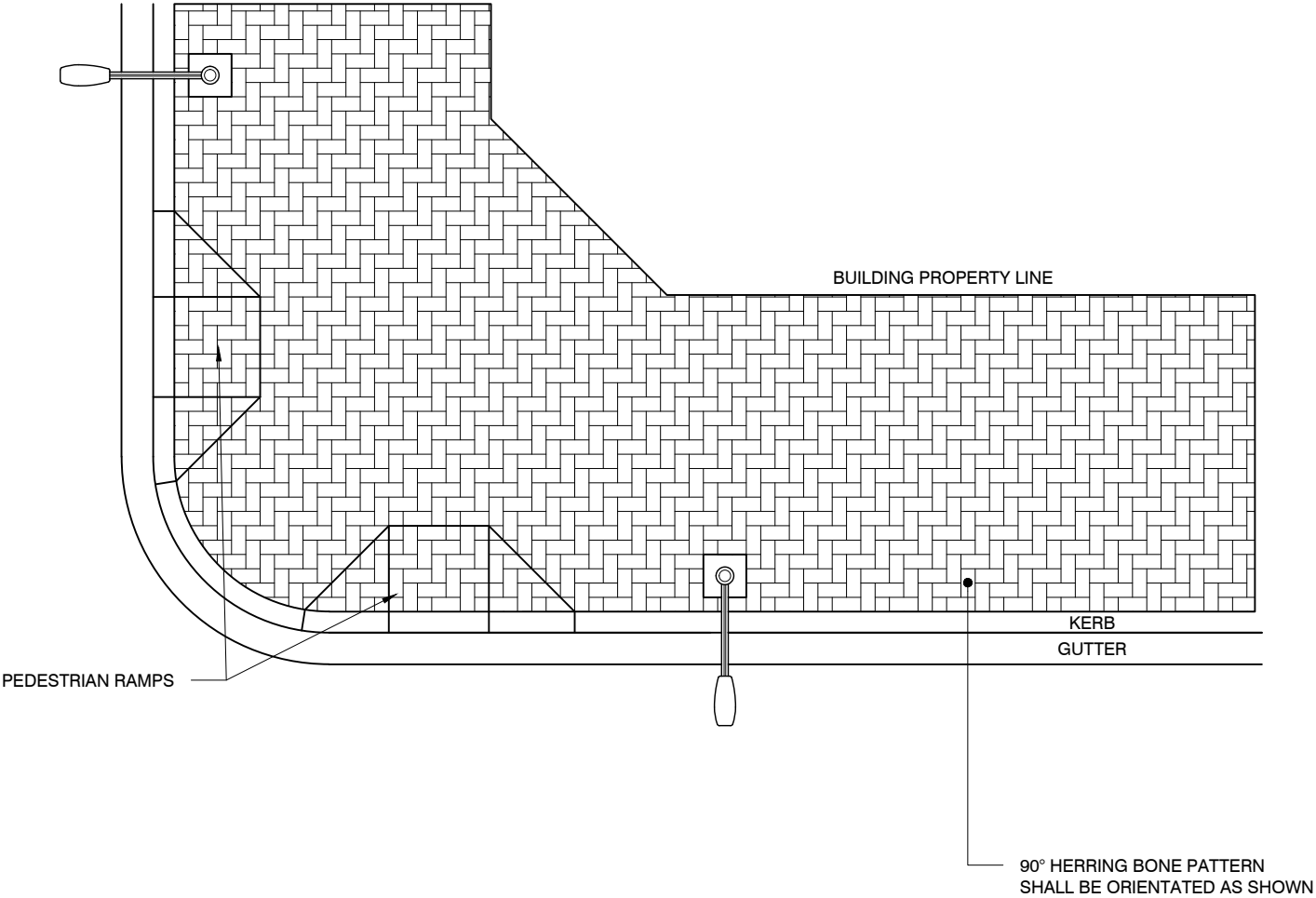

PLAN 1:100

- NOTES:
1. FOR NON 90° INTERSECTIONS, PAVERS IN MAKE UP ZONE ARE TO BE CUT TO ACCOMMODATE THE INTERSECTION ANGLE.
 2. ALL DIMENSIONS IN MILLIMETRES UNLESS OTHERWISE STATED.

JUNCTION WITH BUILDING

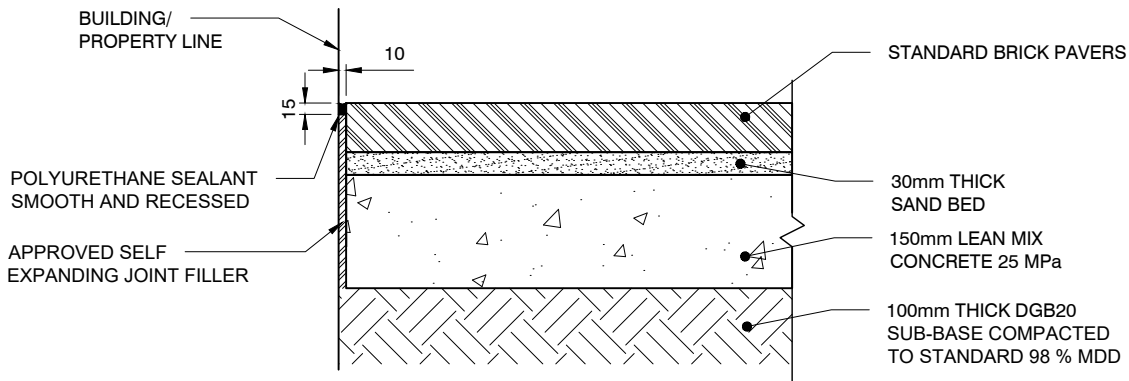

JUNCTION WITH BACK OF KERB

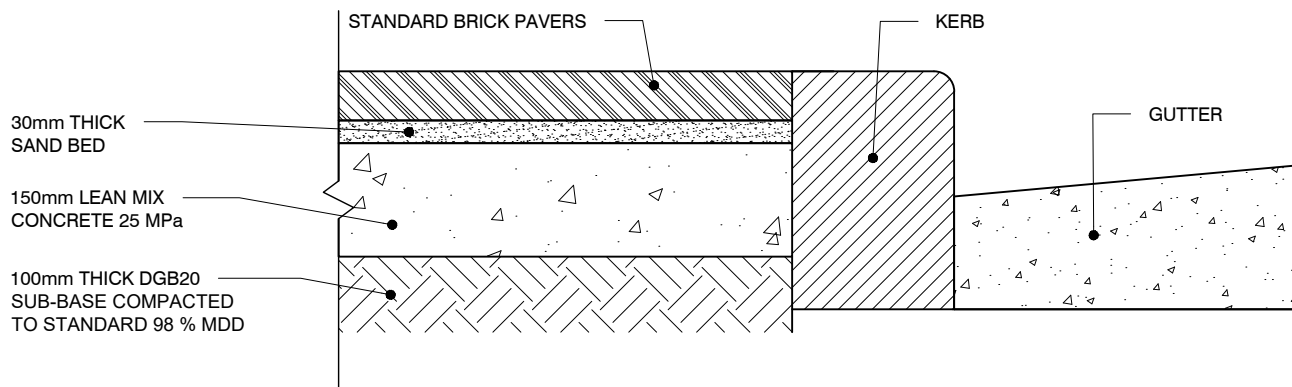

JUNCTION WITH EXISTING PAVEMENT

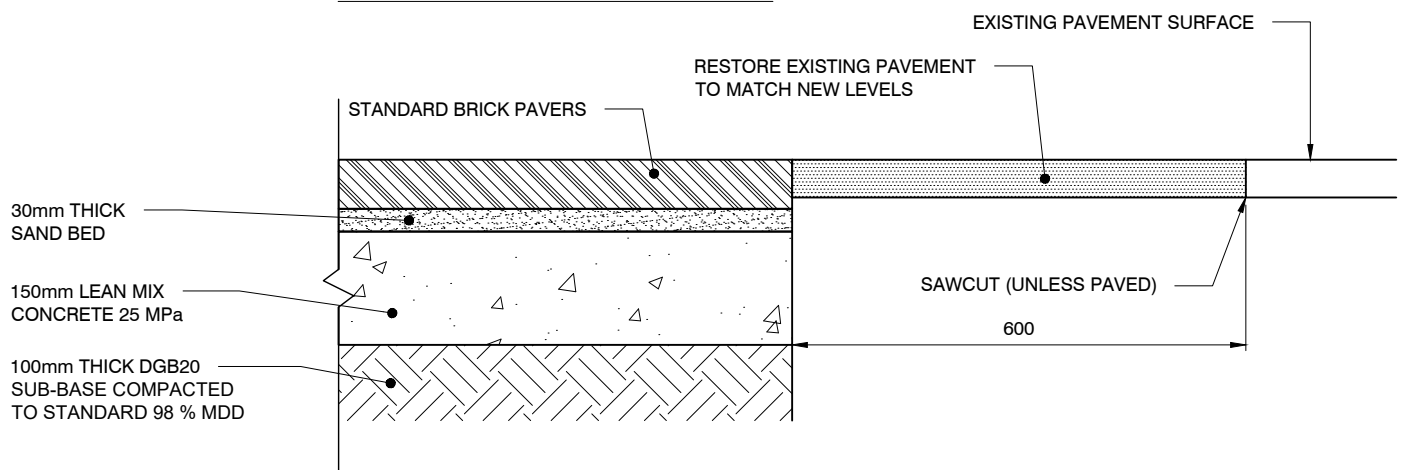

SECTION 1:10

NOTES:

1. ALL DIMENSIONS IN MILLIMETRES UNLESS OTHERWISE STATED

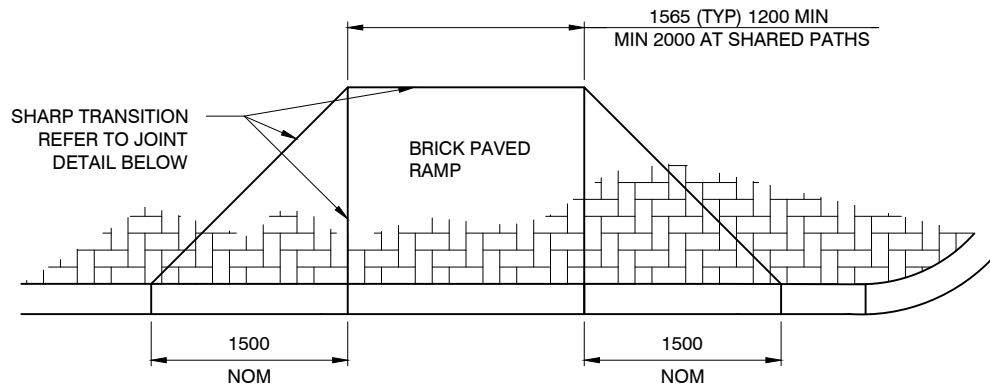

PLAN 1:50

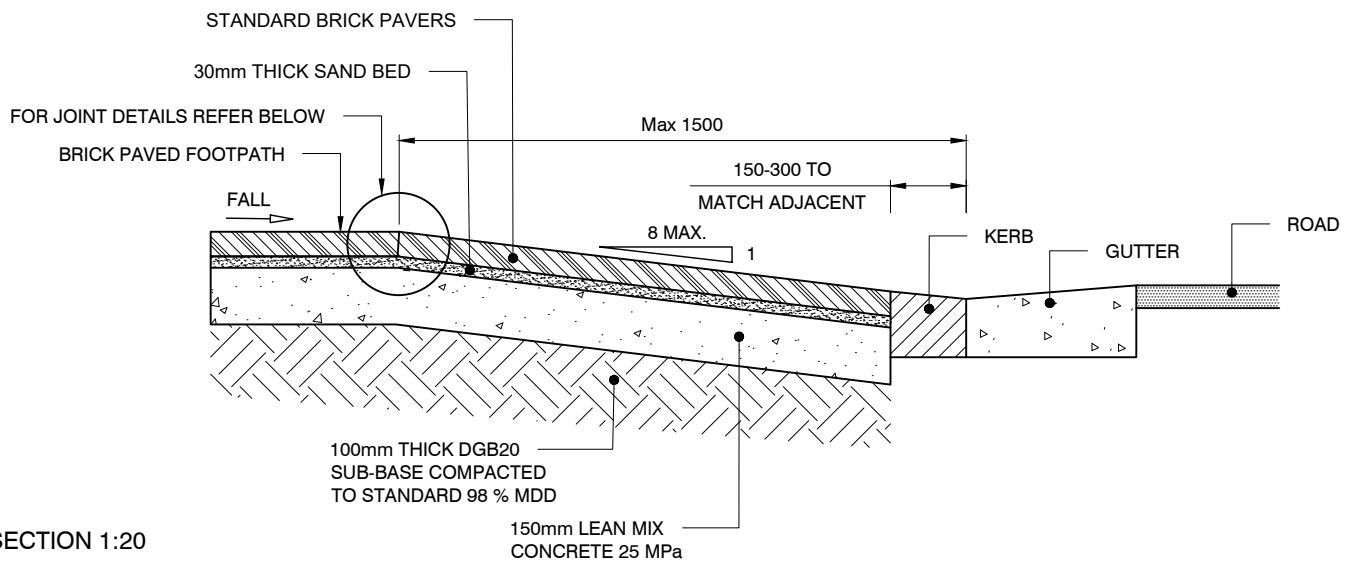

SECTION 1:20

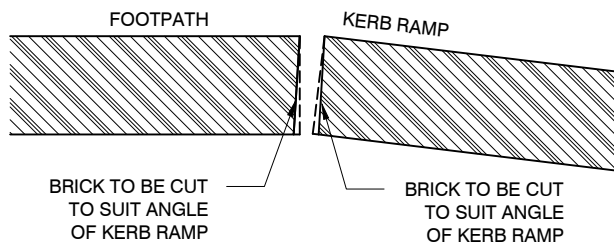

DETAIL 1:5

NOTES:
1. ALL DIMENSIONS IN MILLIMETRES UNLESS OTHERWISE STATED

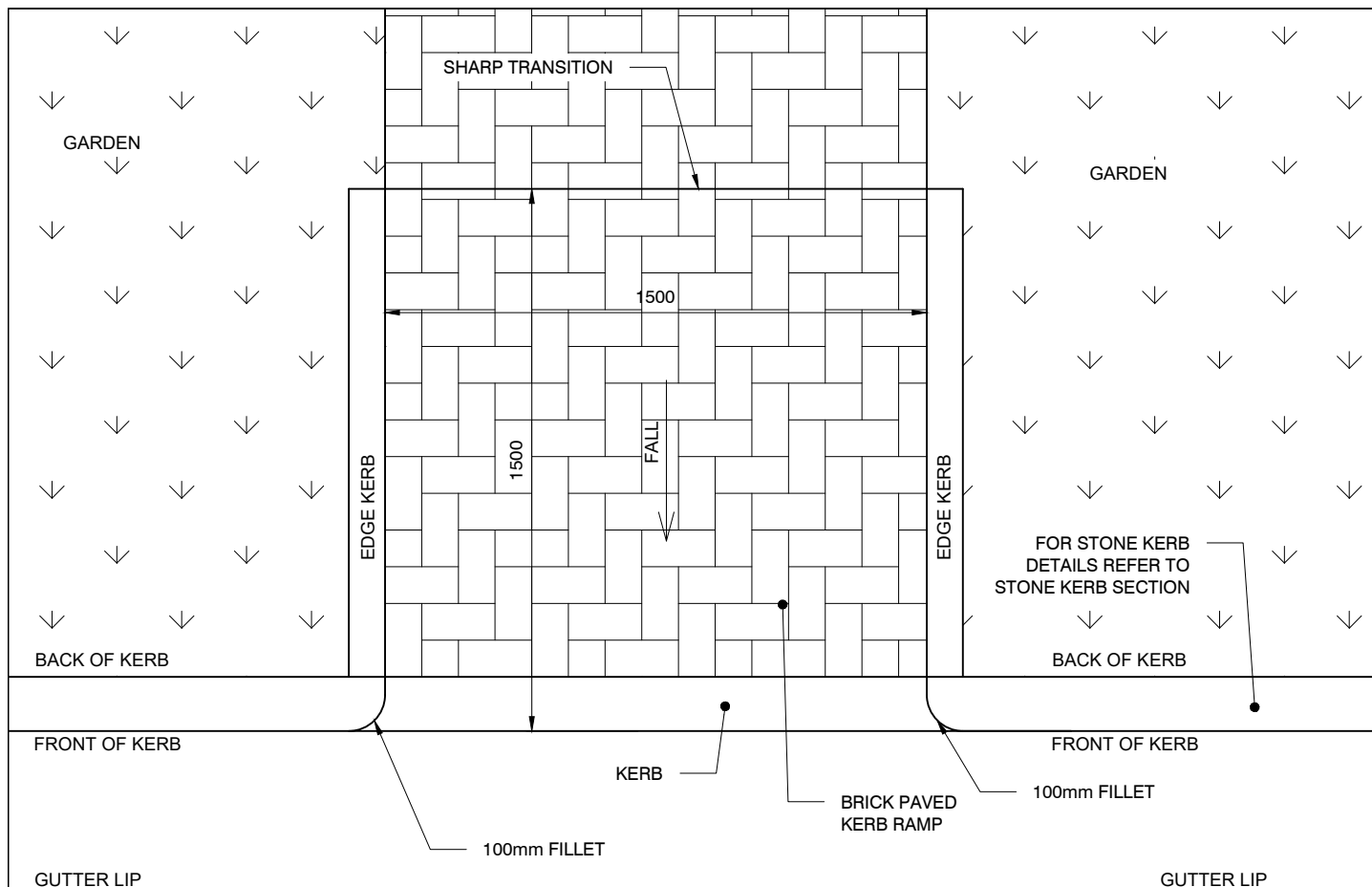

PLAN 1:20

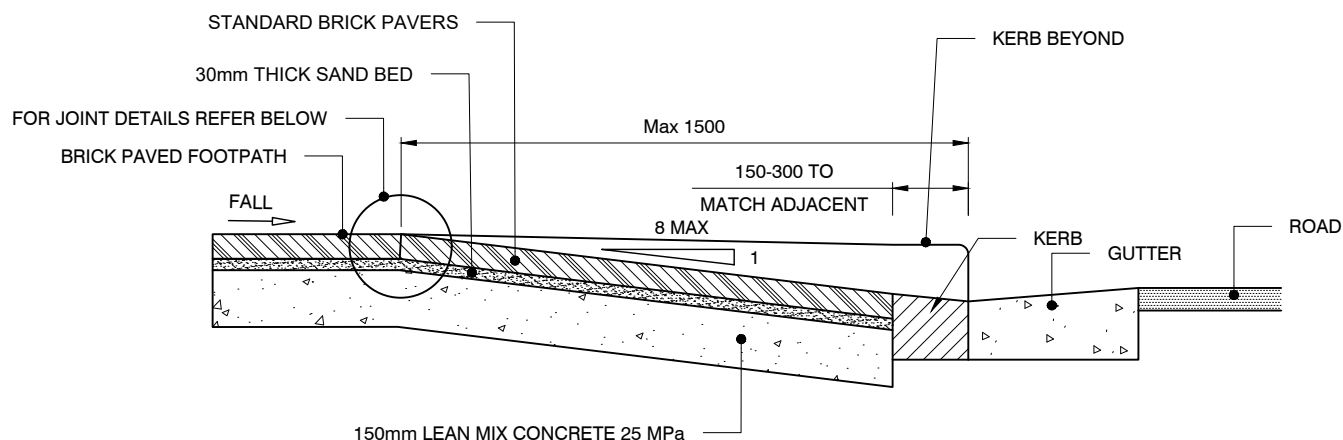

SECTION 1:20

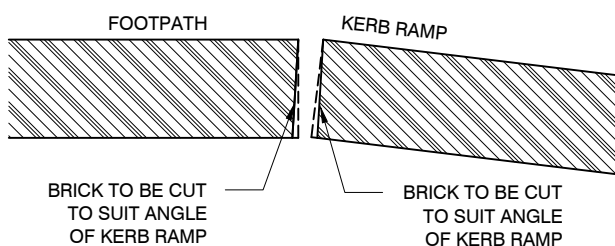

DETAIL 1:5

- NOTES:
1. ONLY TO BE USED IN COUNCIL APPROVED LOCATIONS.
 2. SUB-BASE SHALL BE 100mm THICK DGB20.
 3. ALL DIMENSIONS IN MILLIMETRES UNLESS OTHERWISE STATED

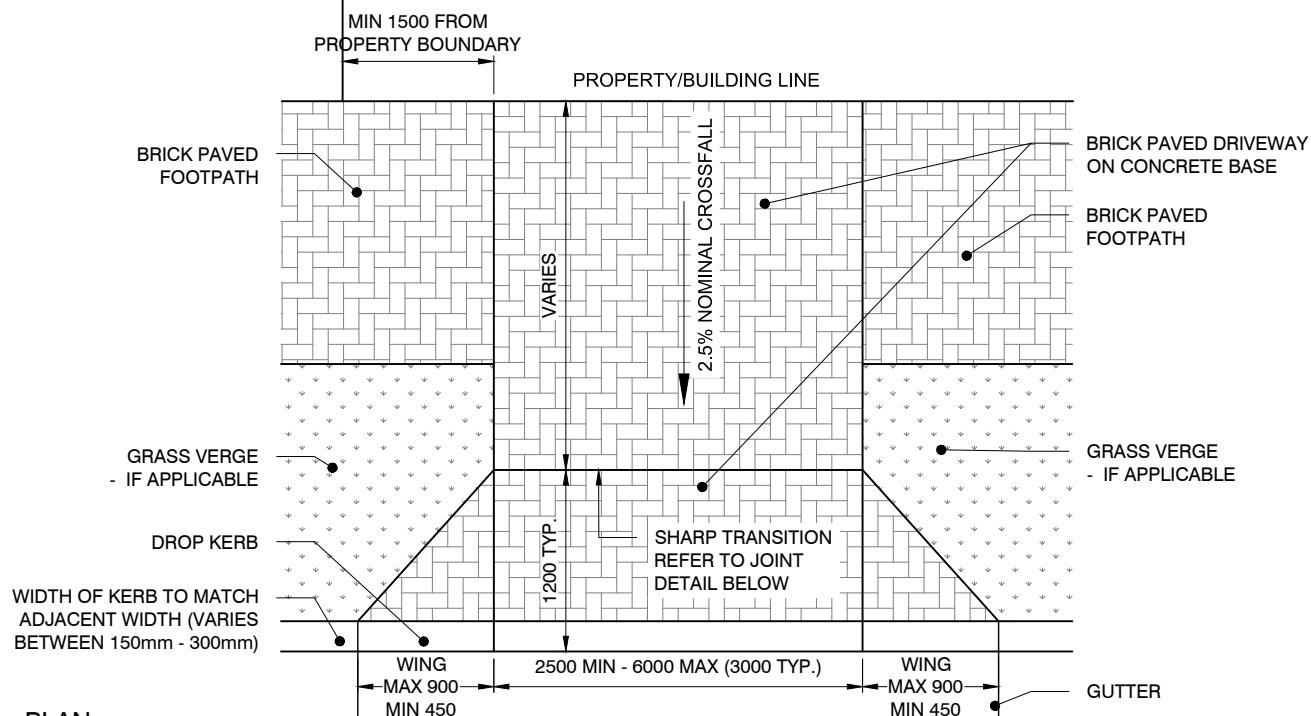

PLAN
1:50

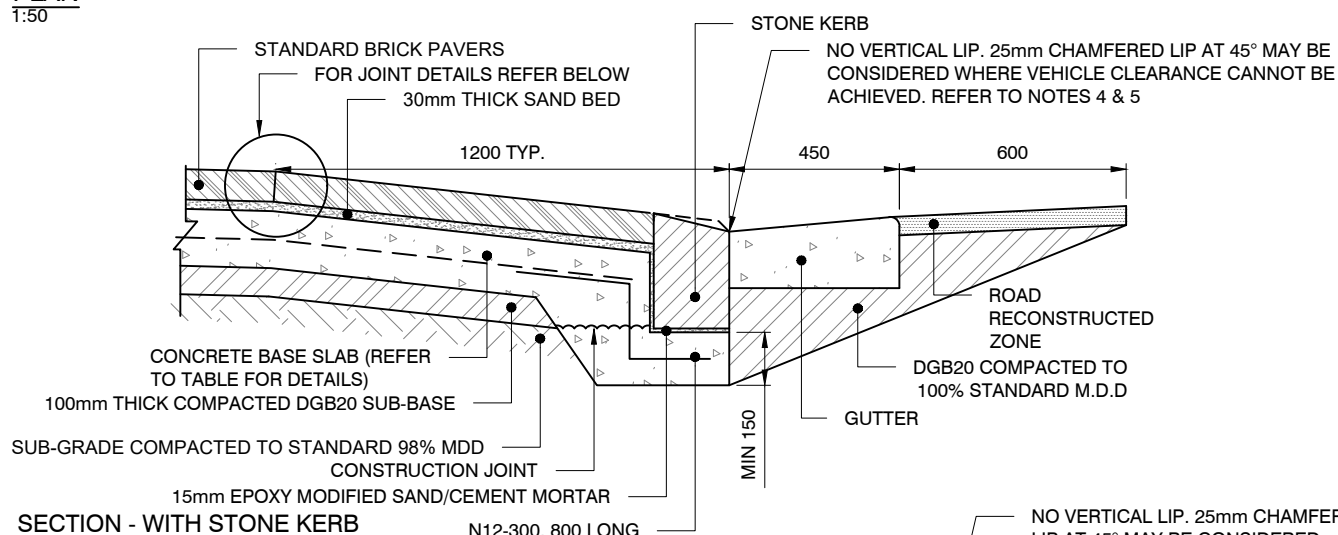

SECTION - WITH STONE KERB
1:20

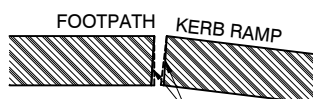

BRICK TO BE CUT TO SUIT
ANGLE OF KERB RAMP

DETAIL 1:10

DRIVEWAY SPECIFICATIONS			
DRIVEWAY USE	CONCRETE STRENGTH	THICKNESS	REINFORCEMENT
SINGLE RESIDENTIAL	32MPa	150	SL82, 50 TOP COVER
MULTI RESIDENTIAL	32MPa	200	SL82, 50 TOP COVER

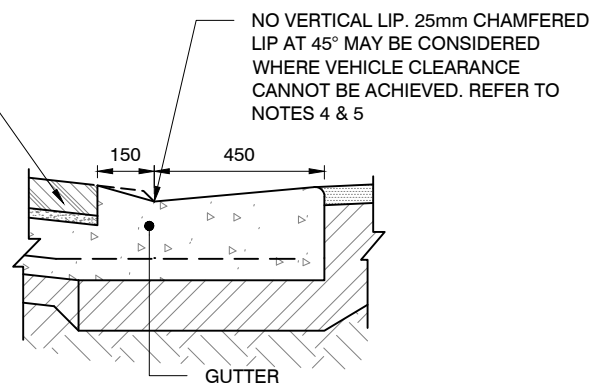

SECTION - WITH CONCRETE K&G
1:20

NOTES:

1. ALIGN CENTRE OF DRIVEWAY WITH ENTRY
2. DRIVEWAY TO BE GENERALLY PERPENDICULAR TO KERB LINE, UNLESS APPROVED OTHERWISE.
3. ALL DRIVEWAY CROSSINGS TO INCLUDE REINFORCED CONCRETE SLAB.
4. VERTICAL AND HORIZONTAL CLEARANCE SHALL BE CHECKED BY THE DESIGNER IN ACCORDANCE WITH AS2890.1
5. VERTICAL LIP ADJACENT TO CYCLEWAY MUST BE APPROVED BY CITY'S REPRESENTATIVE
6. FOR NARROW FOOTPATHS, LENGTH OF RAMP TO BE REDUCED TO 900mm SUBJECT TO VEHICLE CLEARNACE, OR LAYBACK ONLY TO BE USED IN APPROVED APPLICATIONS.
7. FOR DRIVEWAYS WIDER THAN 6.0m A TOOL JOINT SHALL BE PROVIDED ALONG THE CENTRE OF THE DRIVEWAY.
8. ALL DIMENSIONS IN MILLIMETRES UNLESS OTHERWISE STATED.

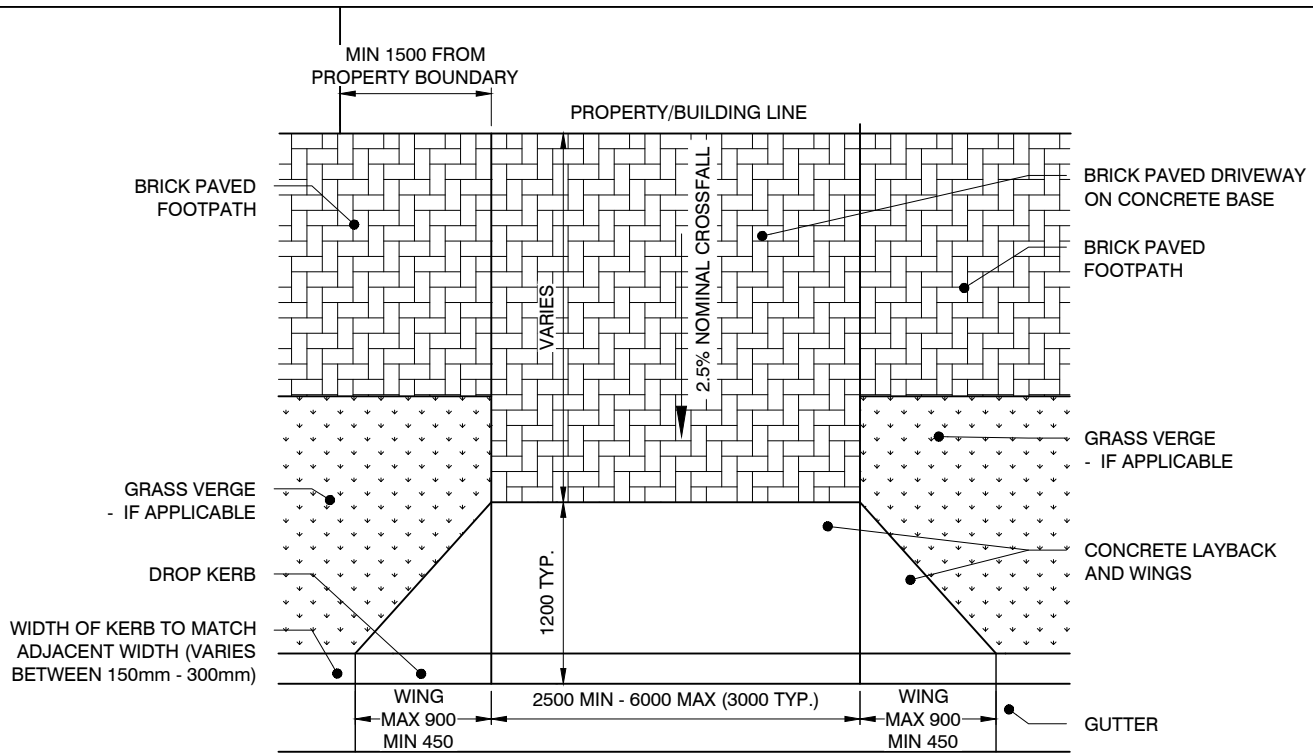

PLAN 1:50

NOTES:

1. ALIGN CENTRE OF DRIVEWAY WITH ENTRY
2. DRIVEWAY TO BE GENERALLY PERPENDICULAR TO KERB LINE, UNLESS APPROVED OTHERWISE.
3. ALL DRIVEWAY CROSSINGS TO INCLUDE REINFORCED CONCRETE SLAB.
4. VERTICAL AND HORIZONTAL CLEARANCE SHALL BE CHECKED BY THE DESIGNER IN ACCORDANCE WITH AS2890.1
5. VERTICAL LIP ADJACENT TO CYCLEWAY MUST BE APPROVED BY CITY'S REPRESENTATIVE
6. FOR NARROW FOOTPATHS, LENGTH OF RAMP TO BE REDUCED TO 900mm SUBJECT TO VEHICLE CLEARANCE, OR LAYBACK ONLY TO BE USED IN APPROVED APPLICATIONS.
7. FOR DRIVEWAYS WIDER THAN 6.0m A TOOL JOINT SHALL BE PROVIDED ALONG THE CENTRE OF THE DRIVEWAY.
8. ALL DIMENSIONS IN MILLIMETRES UNLESS OTHERWISE STATED.

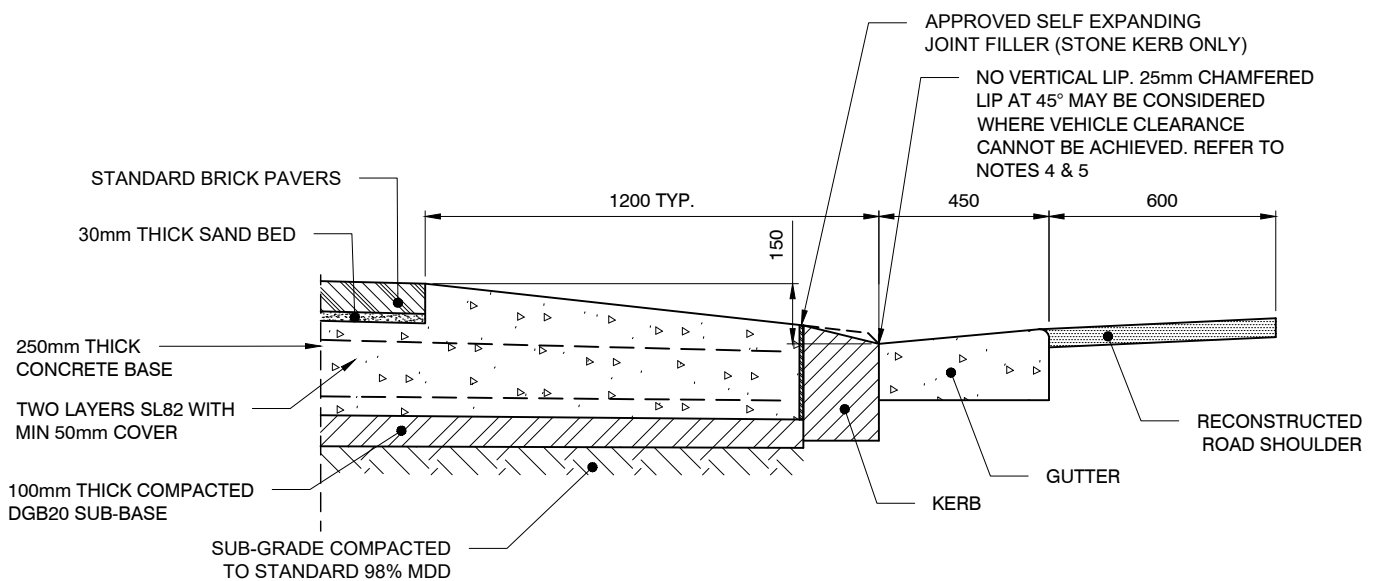

SECTION 1:20

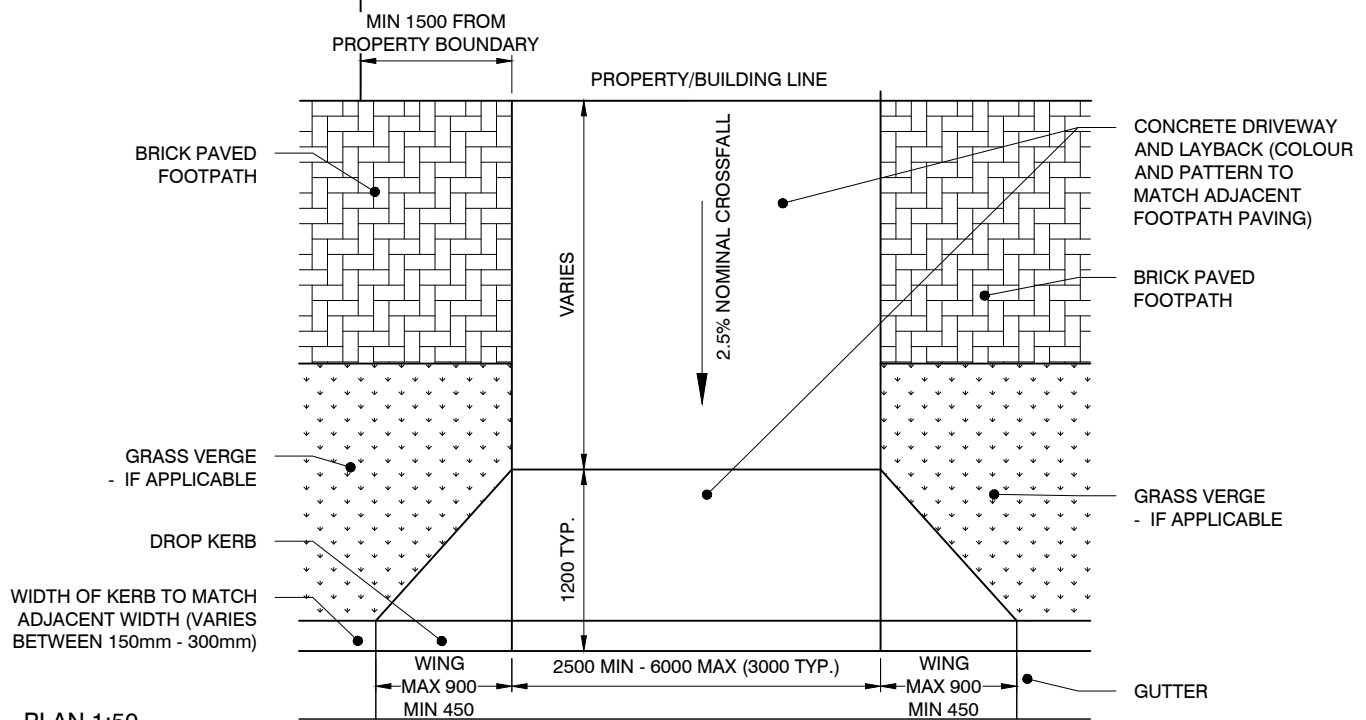

PLAN 1:50

NOTES:

1. ALIGN CENTRE OF DRIVEWAY WITH ENTRY
2. DRIVEWAY TO BE GENERALLY PERPENDICULAR TO KERB LINE, UNLESS APPROVED OTHERWISE.
3. ALL DRIVEWAY CROSSINGS TO INCLUDE REINFORCED CONCRETE SLAB.
4. VERTICAL AND HORIZONTAL CLEARANCE SHALL BE CHECKED BY THE DESIGNER IN ACCORDANCE WITH AS2890.1
5. VERTICAL LIP ADJACENT TO CYCLEWAY MUST BE APPROVED BY CITY'S REPRESENTATIVE
6. FOR NARROW FOOTPATHS, LENGTH OF RAMP TO BE REDUCED TO 900mm SUBJECT TO VEHICLE CLEARNACE, OR LAYBACK ONLY TO BE USED IN APPROVED APPLICATIONS.
7. FOR DRIVEWAYS WIDER THAN 6.0m A TOOL JOINT SHALL BE PROVIDED ALONG THE CENTRE OF THE DRIVEWAY.
8. ALL DIMENSIONS IN MILLIMETRES UNLESS OTHERWISE STATED.

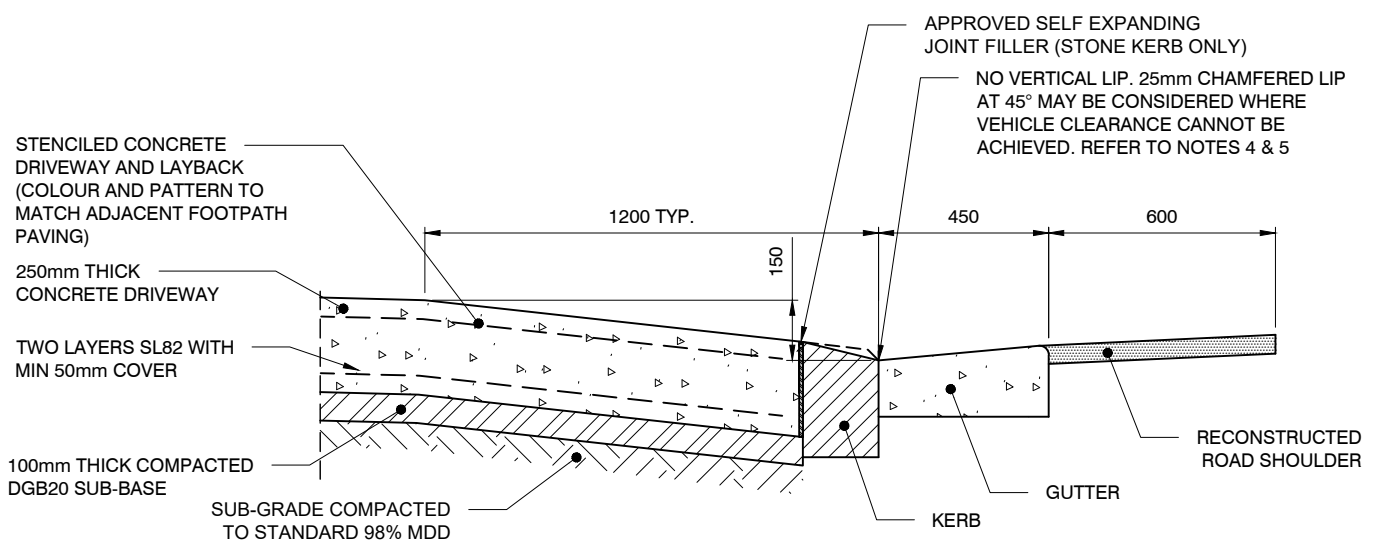

SECTION 1:20