

PLAN 1:100

NOTE: ALL DIMENSIONS IN MILLIMETRES UNLESS OTHERWISE STATED

TYPICAL FOOTPATH SECTION - FLEXIBLE BASE

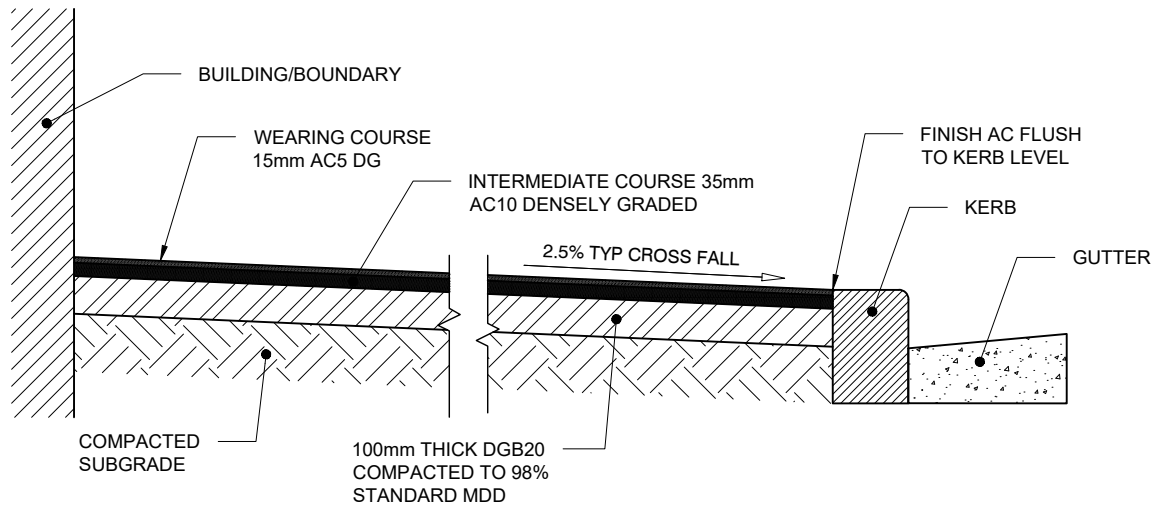

TYPICAL FOOTPATH SECTION - RIGID BASE

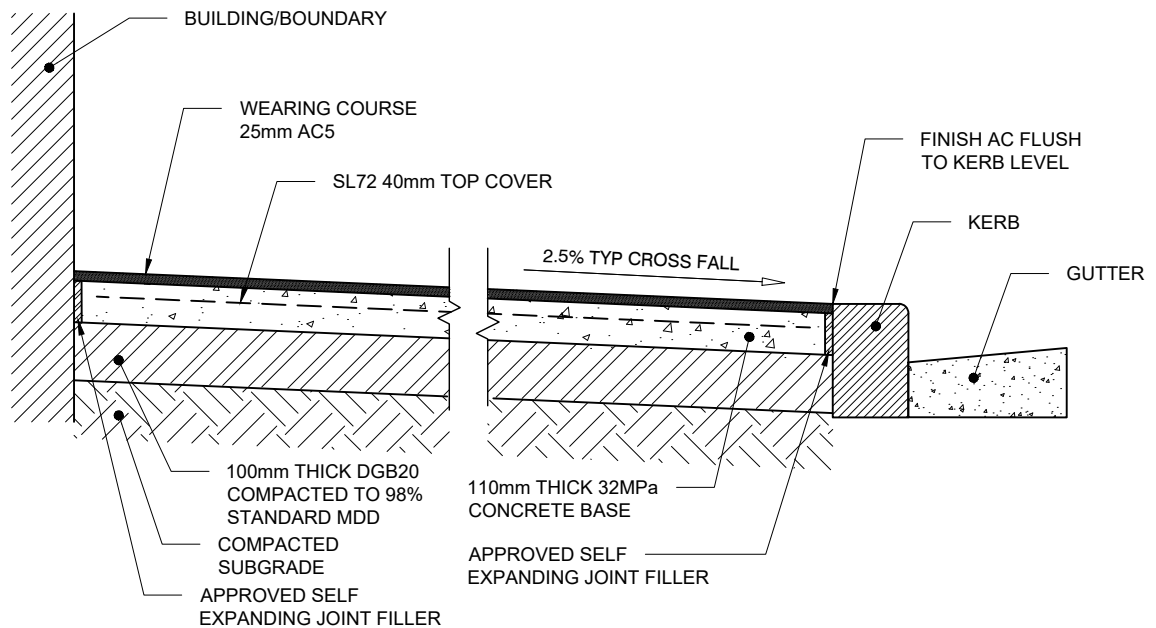

NOTES:

1. MODIFIED ASPHALTIC CONCRETE WITH POLYMER ADDITIVE TO INCREASE SOFTENING POINT TO BE USED IN LOCATIONS WITH EXISTING OR PROPOSED OUTDOOR DINING (FULL FRONTAGE).
2. ALL DIMENSIONS IN MILLIMETRES UNLESS OTHERWISE STATED.

SCALE 1:20

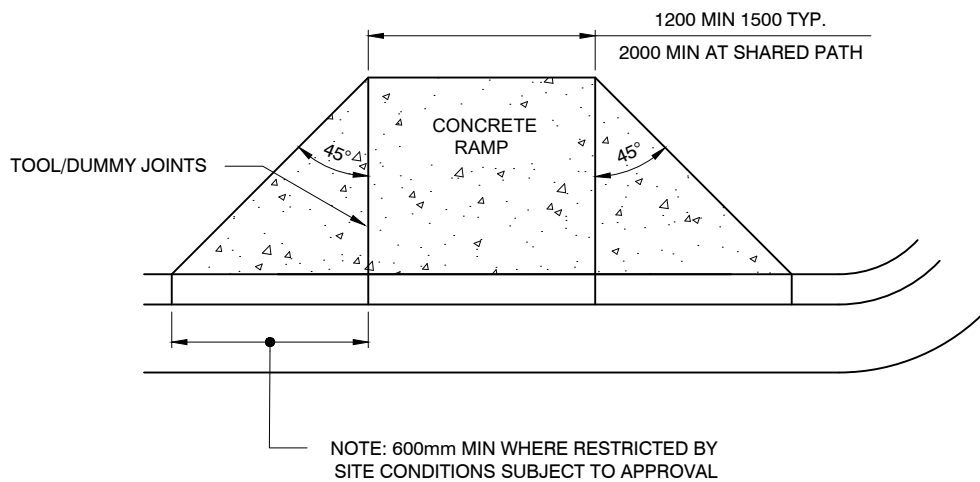

PLAN 1:50

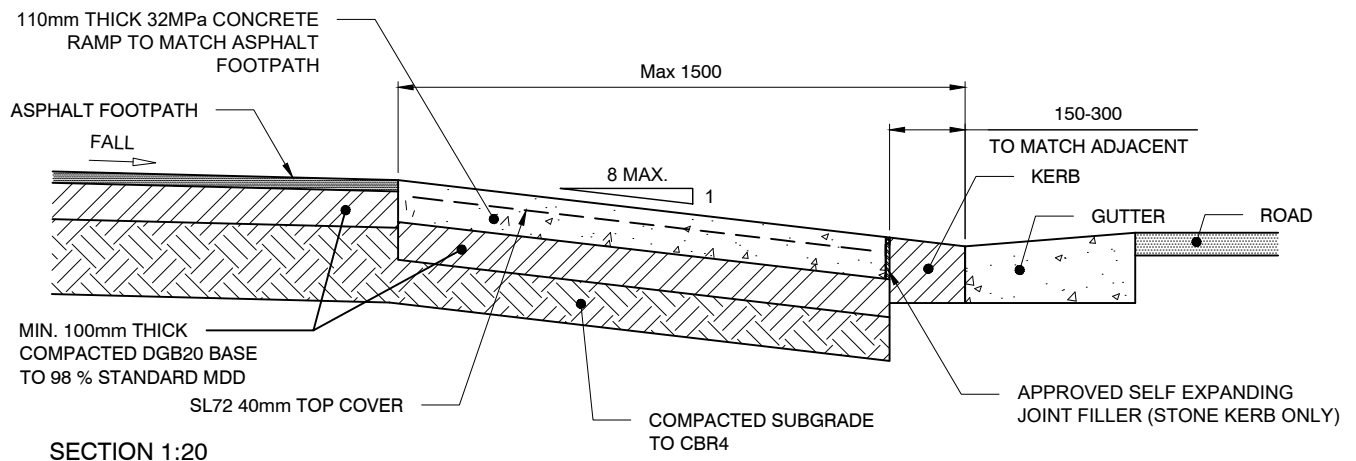

NOTE: ALL DIMENSIONS IN MILLIMETRES UNLESS OTHERWISE STATED

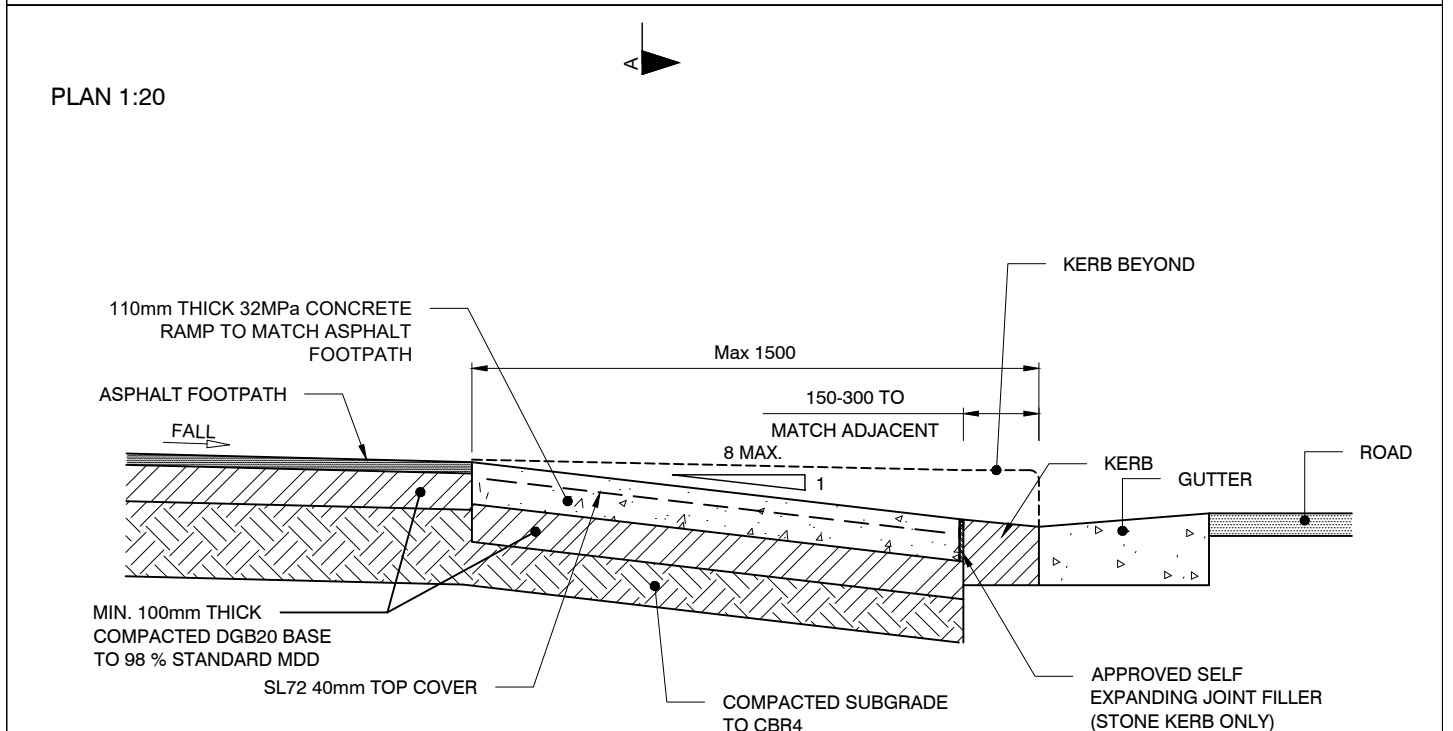
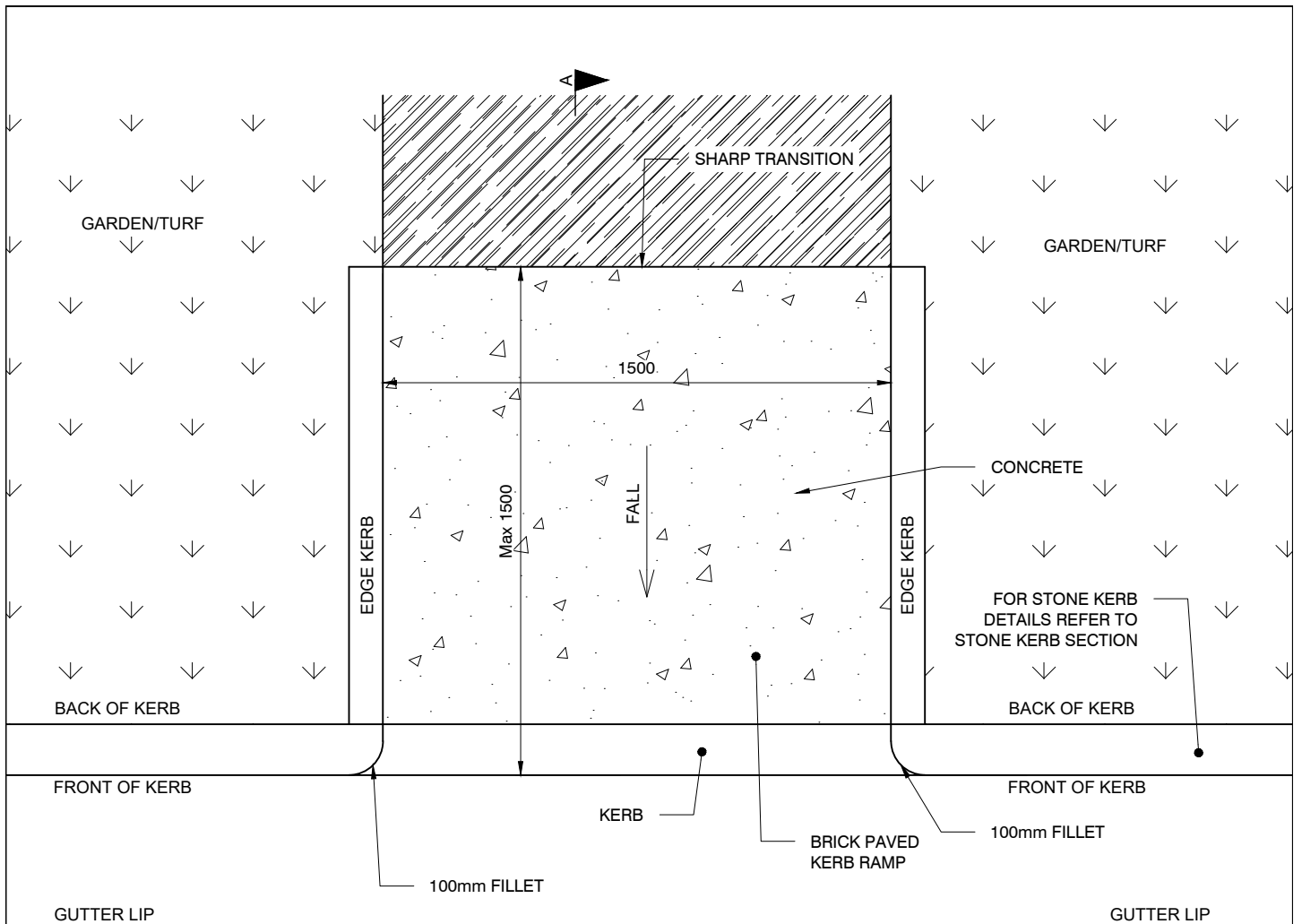

SECTION A-A 1:20

NOTE: ALL DIMENSIONS IN MILLIMETRES UNLESS OTHERWISE STATED

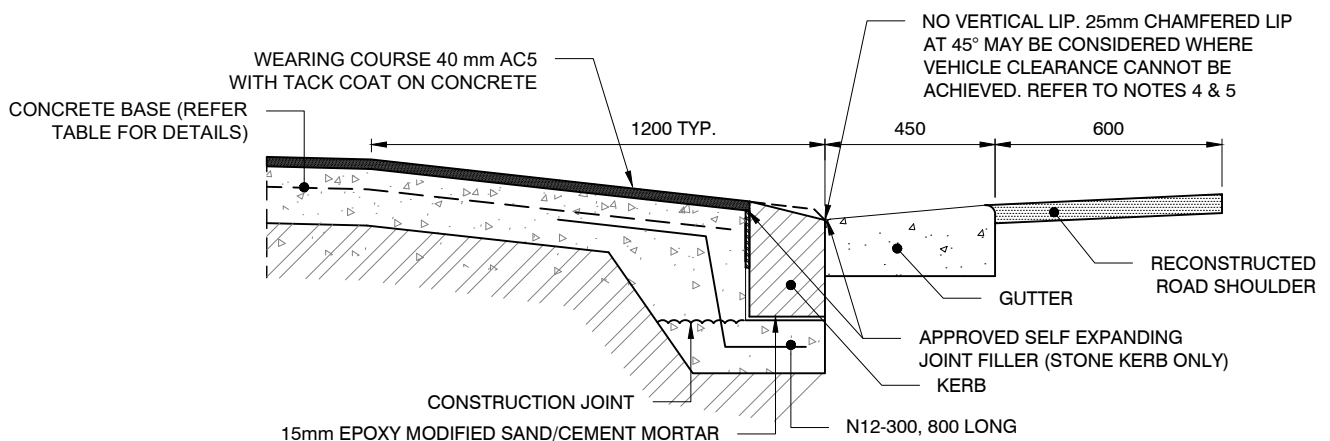
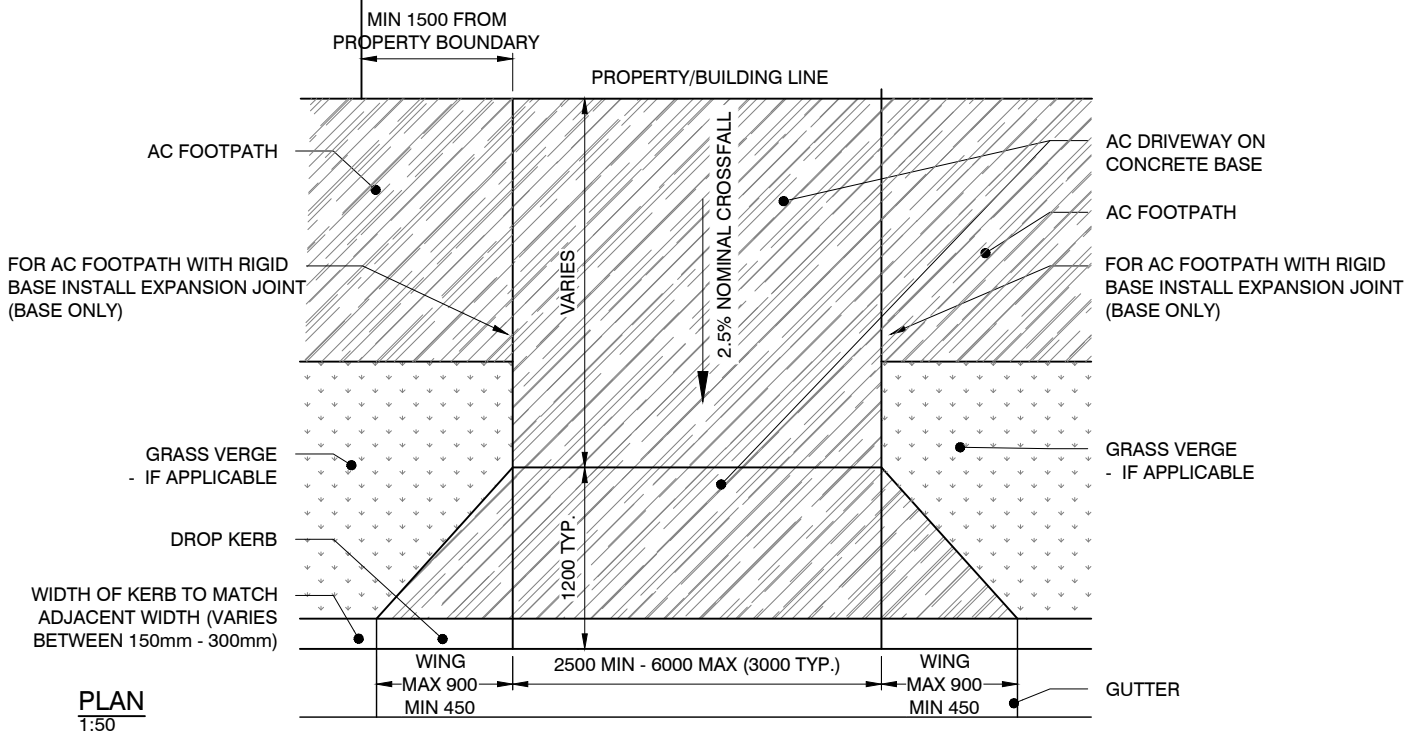

SECTION (WITH STONE KERB)
1:20

DRIVEWAY SPECIFICATIONS			
DRIVEWAY USE	CONCRETE STRENGTH	THICKNESS	REINFORCEMENT
SINGLE RESIDENTIAL	32MPa	150	SL82 50 TOP COVER
MULTI RESIDENTIAL	32MPa	200	SL82 50 TOP COVER

WEARING COURSE 40 mm AC5 WITH TACK COAT ON CONCRETE

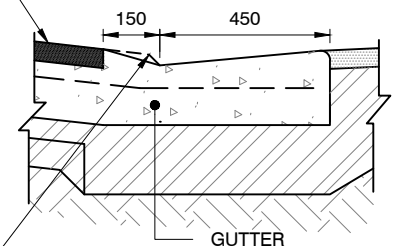

SECTION (WITH CONCRETE KERB)
1:20

NOTES:

1. ALIGN CENTRE OF DRIVEWAY WITH ENTRY
2. DRIVEWAY TO BE GENERALLY PERPENDICULAR TO KERB LINE, UNLESS APPROVED OTHERWISE.
3. ALL DRIVEWAY CROSSINGS TO INCLUDE REINFORCED CONCRETE SLAB.
4. VERTICAL AND HORIZONTAL CLEARANCE SHALL BE CHECKED BY THE DESIGNER IN ACCORDANCE WITH AS2890.1
5. VERTICAL LIP ADJACENT TO CYCLEWAY MUST BE APPROVED BY CITY'S REPRESENTATIVE
6. FOR NARROW FOOTPATHS, LENGTH OF RAMP TO BE REDUCED TO 900mm SUBJECT TO VEHICLE CLEARANCE, OR LAYBACK ONLY TO BE USED IN APPROVED APPLICATIONS.
6. SUB-BASE SHALL BE 100mm THICK DGB20 COMPACTED TO STANDARD 98% MDD
7. ALL DIMENSIONS IN MILLIMETRES UNLESS OTHERWISE STATED.

NO VERTICAL LIP. 25mm CHAMFERED LIP AT 45° MAY BE CONSIDERED WHERE VEHICLE CLEARANCE CANNOT BE ACHIEVED. REFER TO NOTES 4 & 5

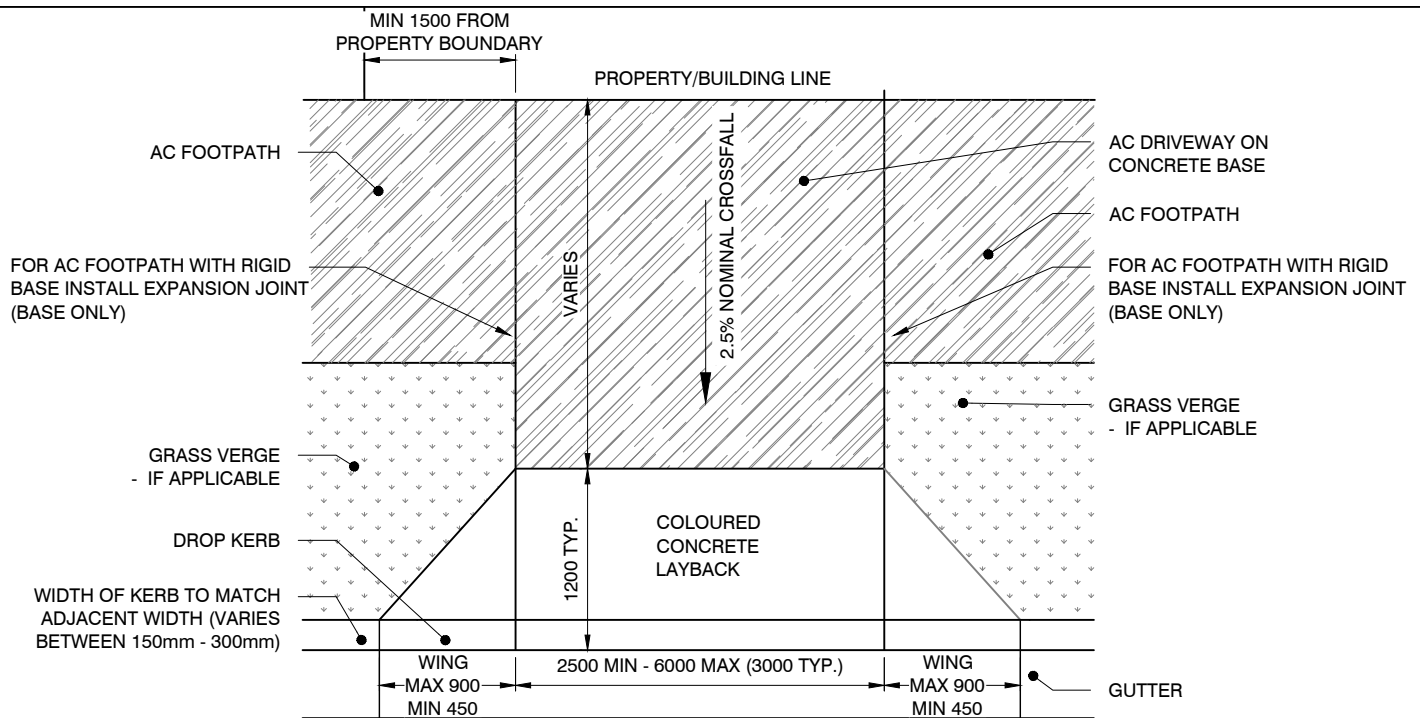

PLAN
1:50

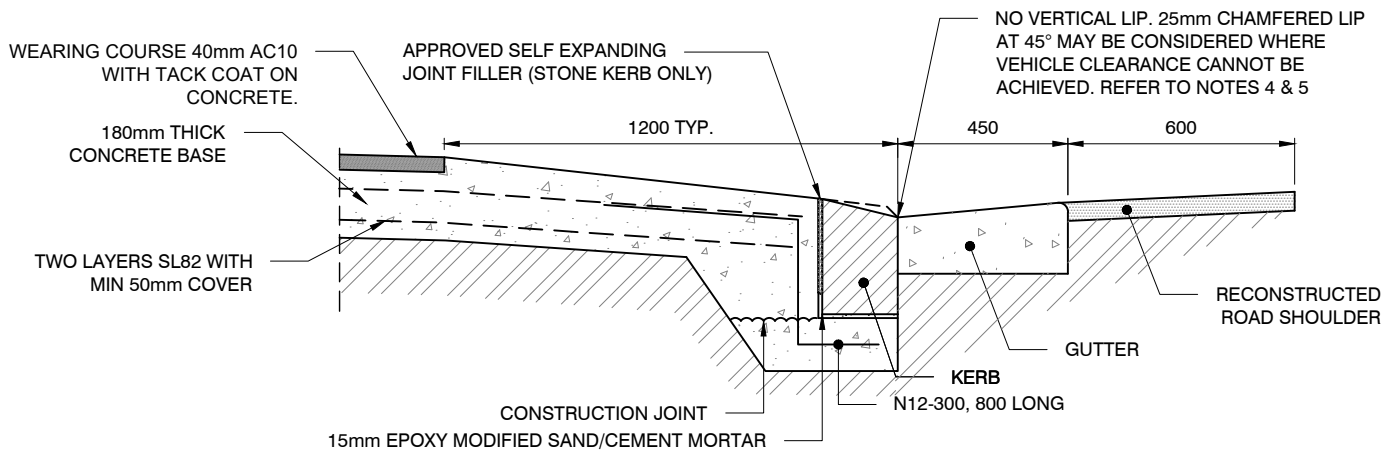

SECTION (WITH STONE KERB)
1:20

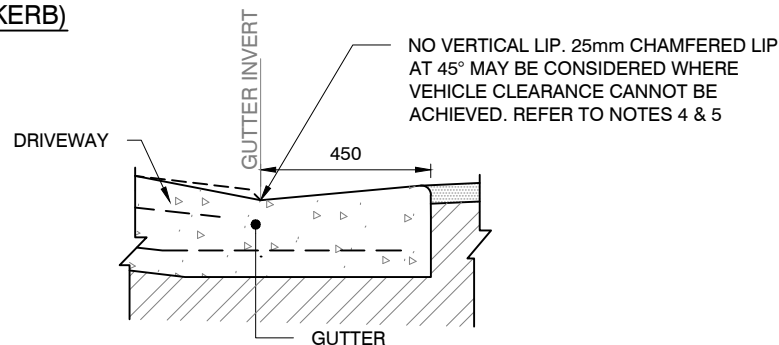

SECTION (WITH CONCRETE KERB)
1:20

NOTES:

1. THIS DRIVEWAY SUIT COMMERCIAL VEHICULAR CROSSINGS SUBJECT TO AXLE LOADING OF 10 TONNES OR LIGHTER.
2. DRIVEWAY TO BE GENERALLY PERPENDICULAR TO KERB LINE, UNLESS APPROVED OTHERWISE.
3. ALL DRIVEWAY CROSSINGS TO INCLUDE REINFORCED CONCRETE SLAB.
4. VERTICAL AND HORIZONTAL CLEARANCE SHALL BE CHECKED BY THE DESIGNER IN ACCORDANCE WITH AS2890.1
5. VERTICAL LIP ADJACENT TO CYCLEWAY MUST BE APPROVED BY CITY'S REPRESENTATIVE
6. FOR NARROW FOOTPATHS, LENGTH OF RAMP TO BE REDUCED TO 900mm, SUBJECT TO VEHICLE CLEARANCE OR LAYBACK ONLY TO BE USED IN APPROVED APPLICATIONS.
7. FOR DRIVEWAYS WIDER THAN 6.0m A TOOL JOINT SHALL BE PROVIDED ALONG THE CENTRE OF THE CONCRETE DRIVEWAY.
8. CONCRETE TO BE MINIMUM 32MPa.
6. SUB-BASE SHALL BE 100mm THICK DGB20 COMPACTED TO STANDARD 98% MDD
7. ALL DIMENSIONS IN MILLIMETRES UNLESS OTHERWISE STATED.

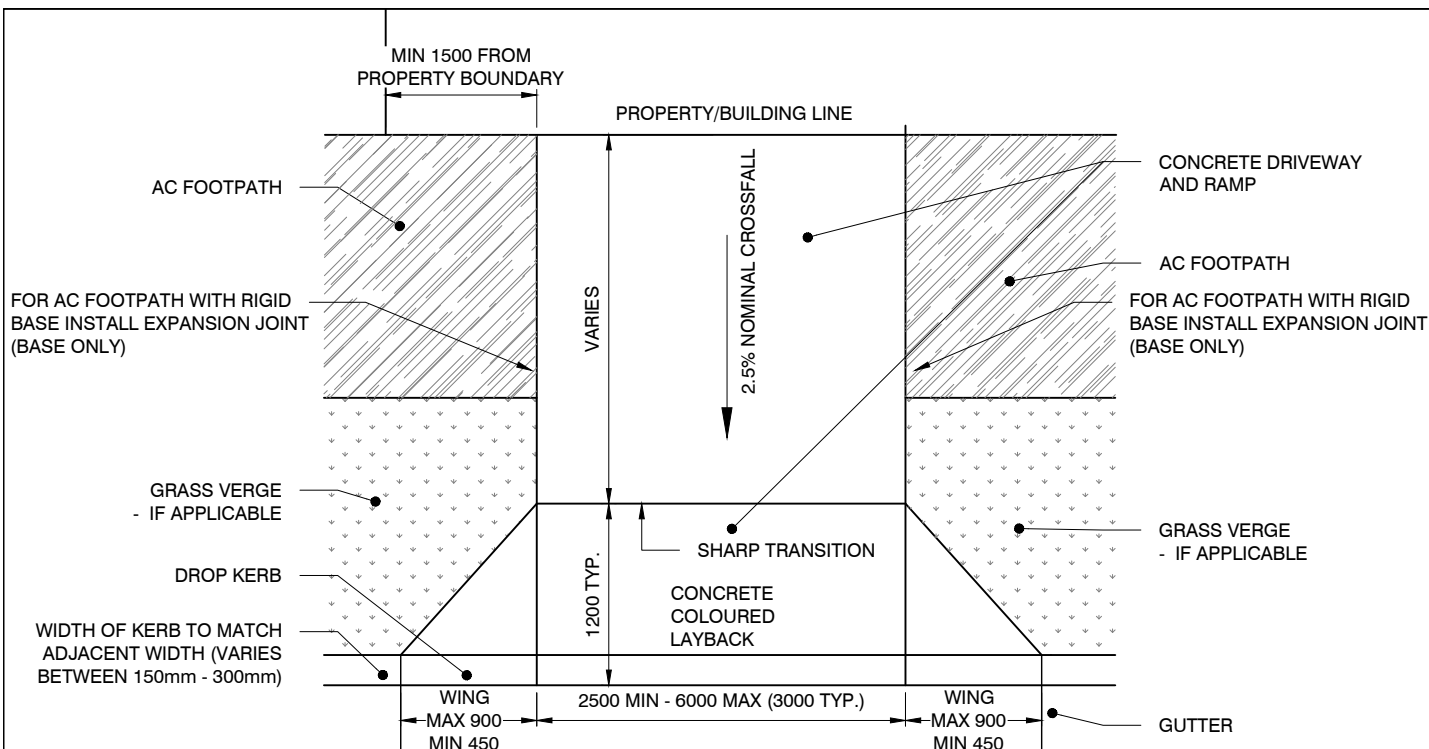

PLAN
1:50

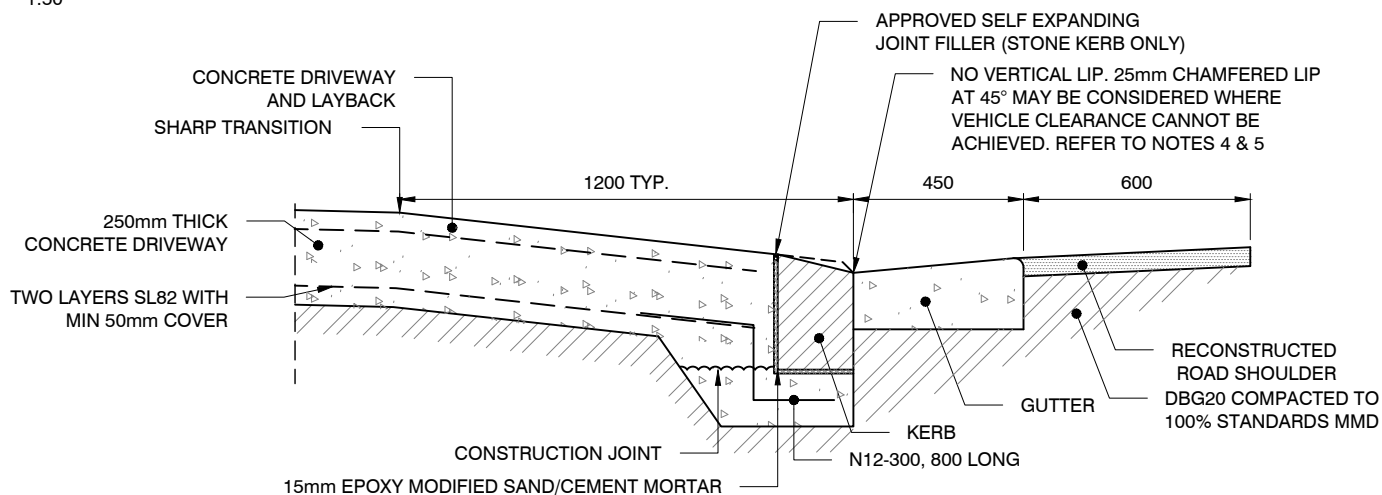

SECTION (WITH STONE KERB)
1:20

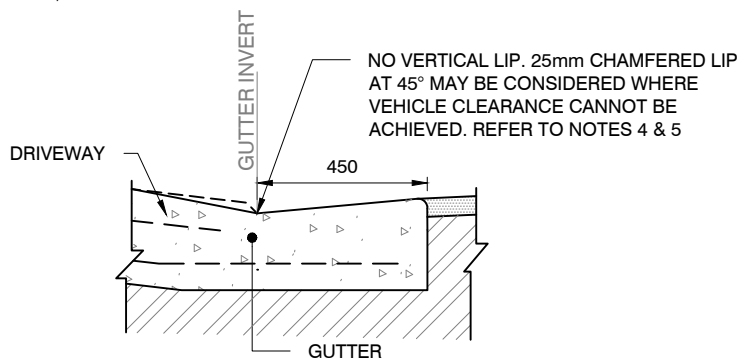

SECTION (WITH CONCRETE KERB)
1:20

NOTES:

1. THIS DRIVEWAY SUIT COMMERCIAL VEHICULAR CROSSINGS SUBJECTED TO AXLE LOADING OF 10 TONNES OR LIGHTER.
2. DRIVEWAY TO BE GENERALLY PERPENDICULAR TO KERB LINE, UNLESS APPROVED OTHERWISE.
3. ALL DRIVEWAY CROSSINGS TO INCLUDE REINFORCED CONCRETE SLAB.
4. VERTICAL AND HORIZONTAL CLEARANCE SHALL BE CHECKED BY THE DESIGNER IN ACCORDANCE WITH AS2890.1
5. VERTICAL LIP ADJACENT TO CYCLEWAY MUST BE APPROVED BY CITY'S REPRESENTATIVE
6. FOR NARROW FOOTPATHS, LENGTH OF RAMP TO BE REDUCED TO 900mm, SUBJECT TO VEHICLE CLEARANCE OR LAYBACK ONLY TO BE USED IN APPROVED APPLICATIONS.
7. FOR DRIVEWAYS WIDER THAN 6.0m A TOOL JOINT SHALL BE PROVIDED ALONG THE CENTRE OF THE CONCRETE DRIVEWAY.
8. CONCRETE TO BE MINIMUM 32MPa.
9. SUB-BASE SHALL BE 100mm THICK DGB20.
10. ALL DIMENSIONS IN MILLIMETRES UNLESS OTHERWISE STATED.

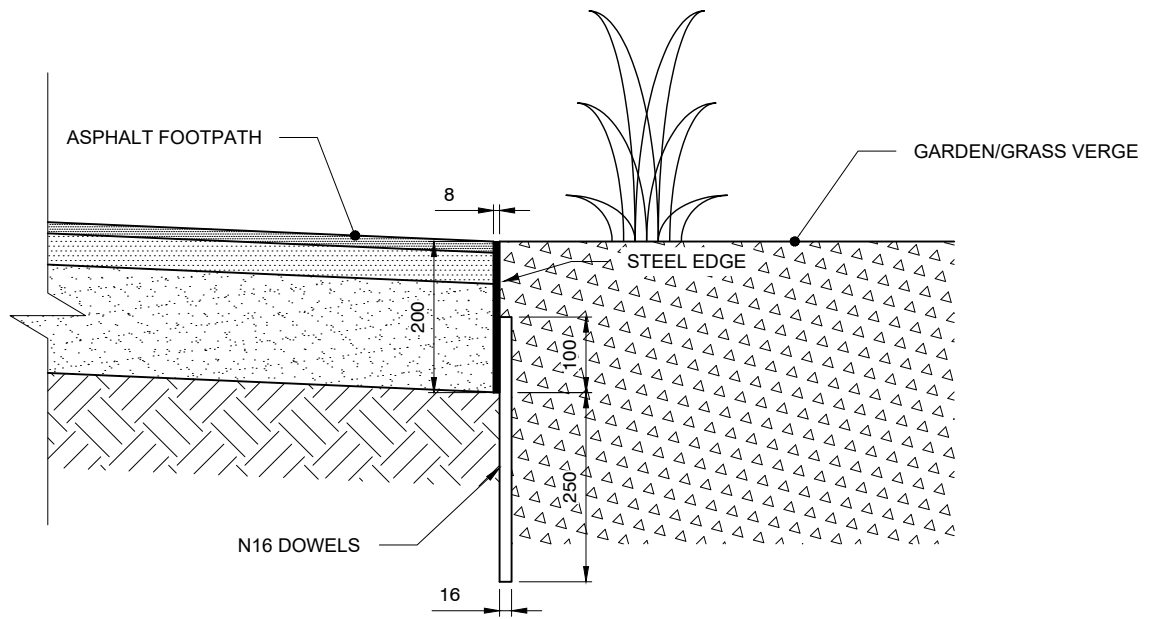

SECTION 1:10

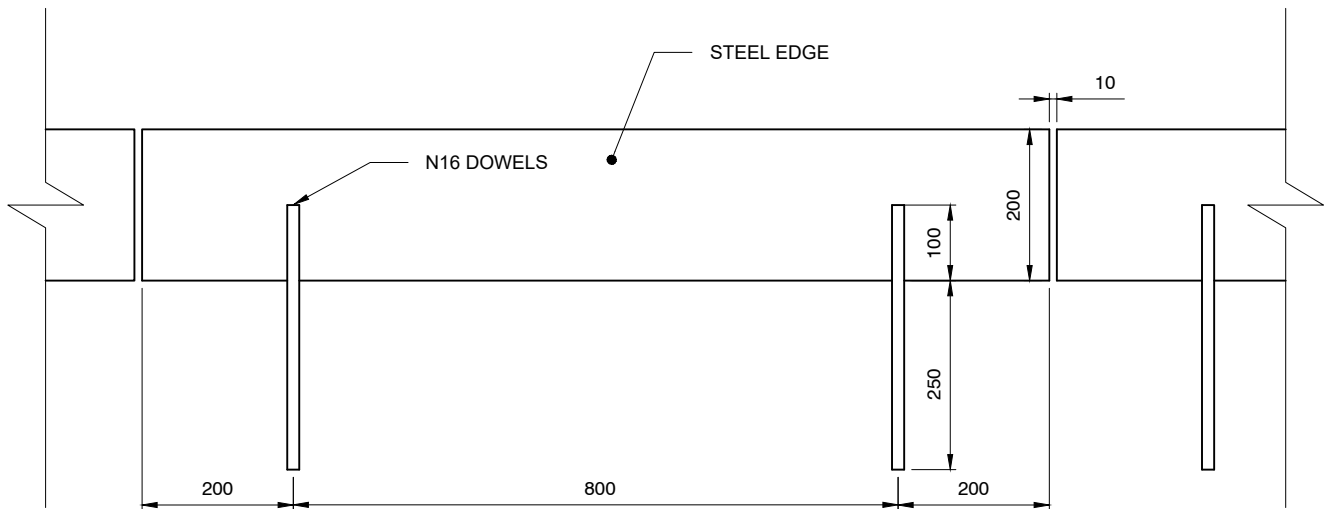

ELEVATION 1:10

NOTES:

1. ALL STEELWORK TO BE HOT DIPPED GALVANISED.
2. ALL STEELWORK BELOW GROUND LEVEL TO BE PAINTED WITH TWO COATS OF BITUMINOUS PAINT.
3. ALL DIMENSIONS IN MILLIMETRES UNLESS OTHERWISE STATED.

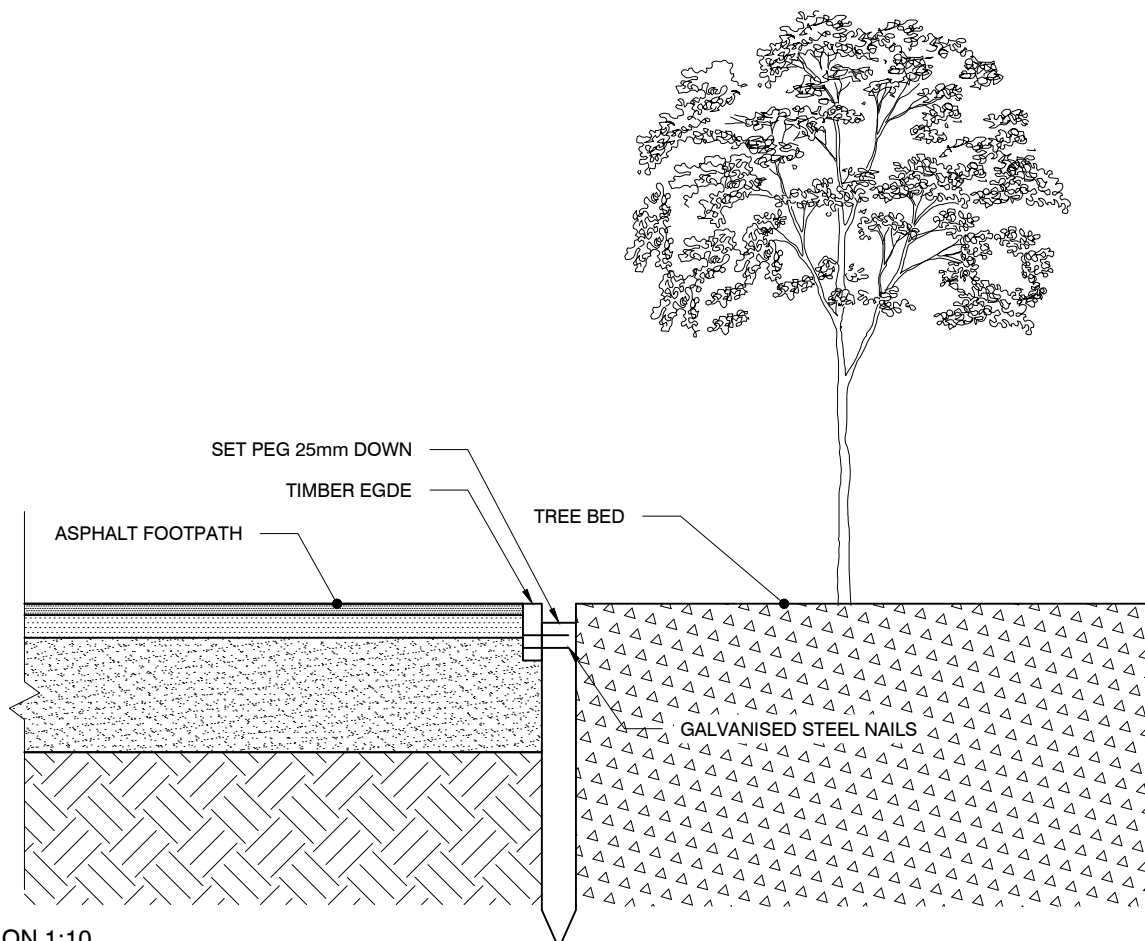

SECTION 1:10

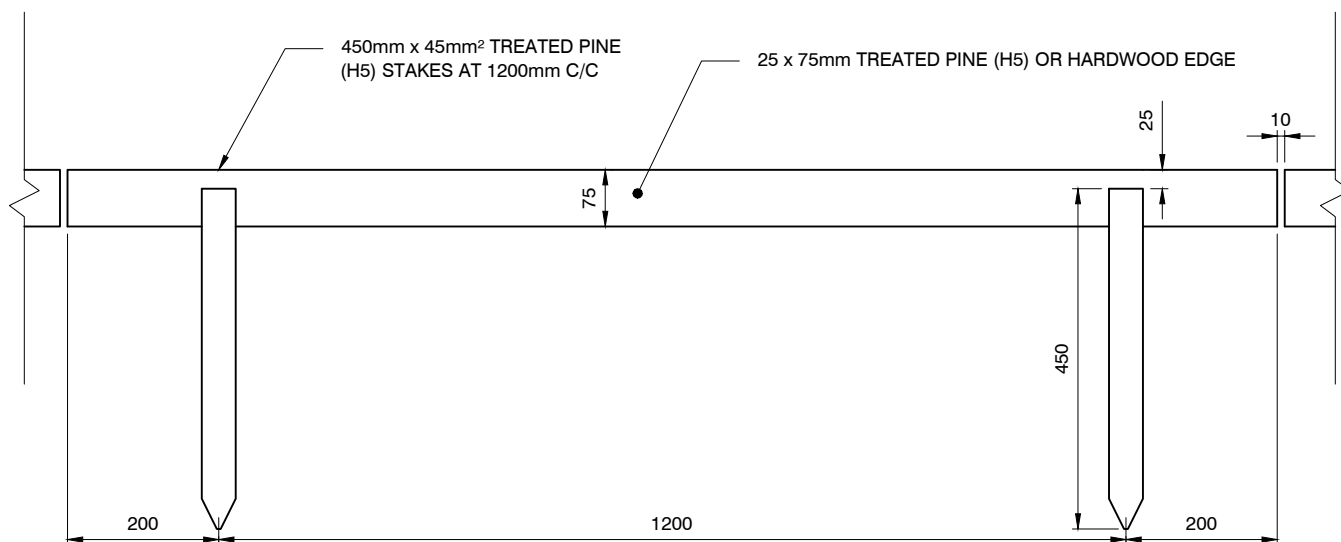

ELEVATION 1:10

NOTE: ALL DIMENSIONS IN MILLIMETRES UNLESS OTHERWISE STATED