

**TYPICAL FOOTPATH SECTION - FLEXIBLE BASE**

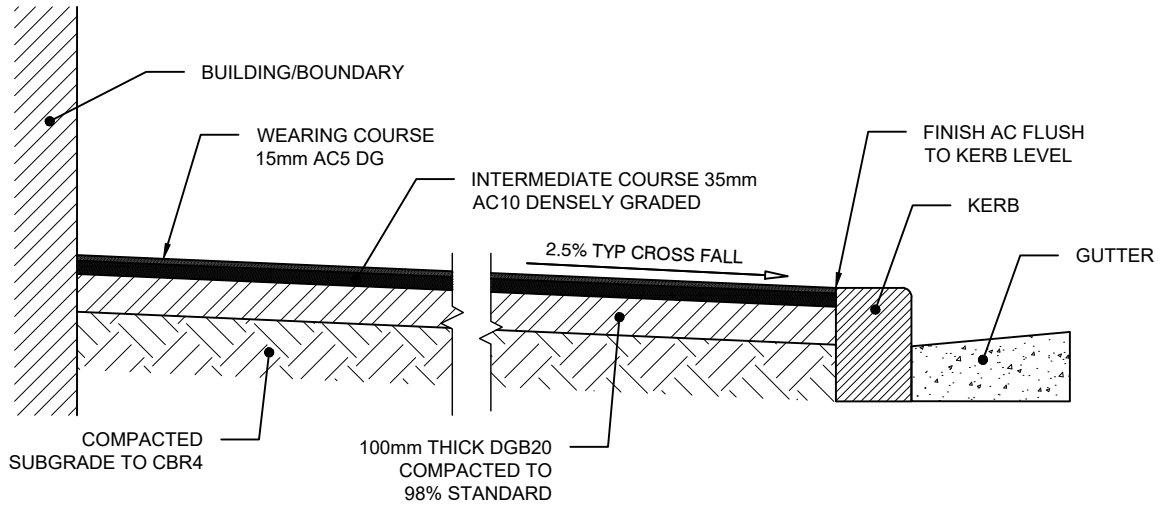

**TYPICAL FOOTPATH SECTION - RIGID BASE**

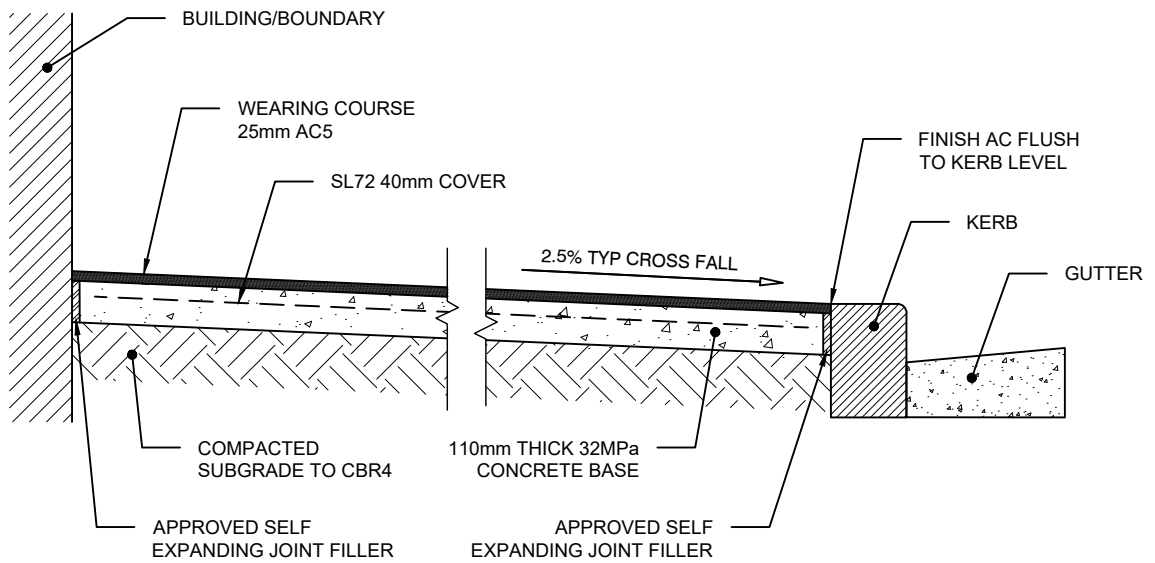

**NOTE:**

1. MODIFIED ASPHALTIC CONCRETE WITH POLYMER ADDITIVE TO INCREASE SOFTENING POINT TO BE USED IN LOCATIONS WITH EXISTING OR PROPOSED OUTDOOR DINING (FULL FRONTAGE).

SCALE 1:20

NOTE: ALL DIMENSIONS IN MILLIMETRES UNLESS OTHERWISE STATED