

PLAN 1:100

NOTE: ALL DIMENSIONS IN MILLIMETRES UNLESS OTHERWISE STATED

TYPICAL FOOTPATH SECTION - FLEXIBLE BASE

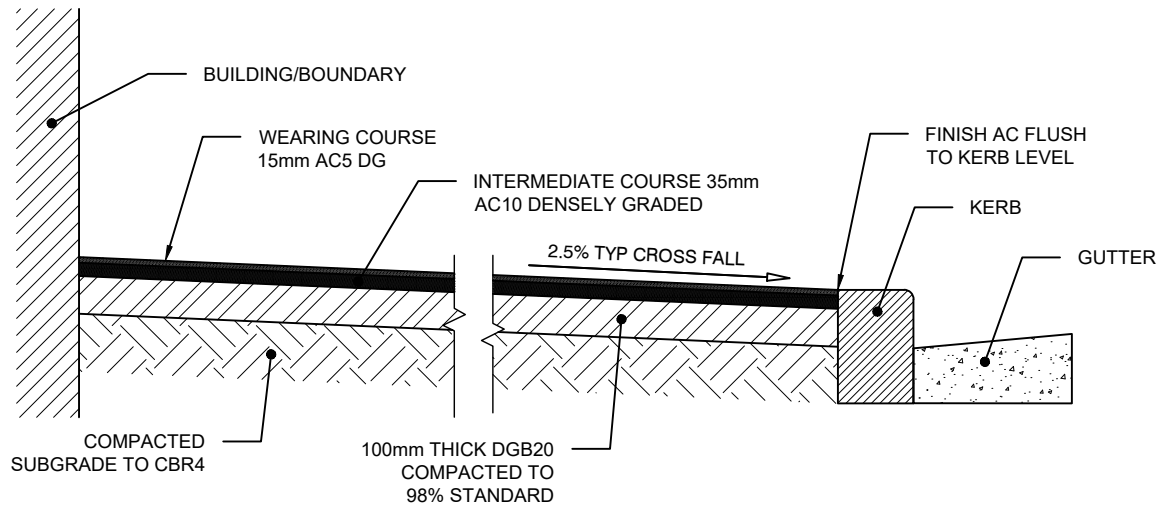

TYPICAL FOOTPATH SECTION - RIGID BASE

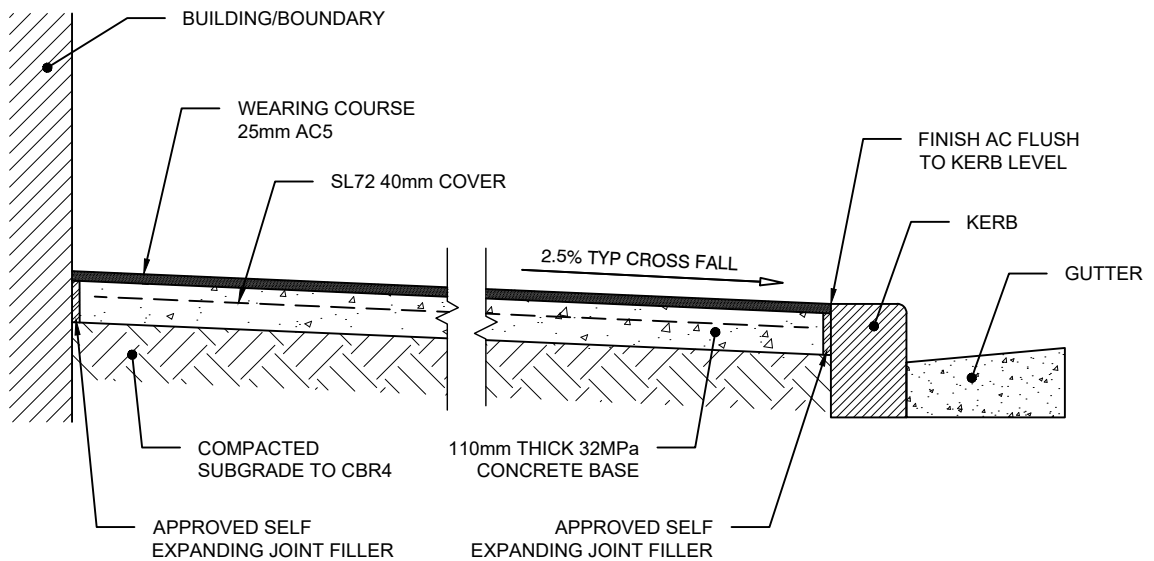

NOTE:

1. MODIFIED ASPHALTIC CONCRETE WITH POLYMER ADDITIVE TO INCREASE SOFTENING POINT TO BE USED IN LOCATIONS WITH EXISTING OR PROPOSED OUTDOOR DINING (FULL FRONTAGE).

SCALE 1:20

NOTE: ALL DIMENSIONS IN MILLIMETRES UNLESS OTHERWISE STATED

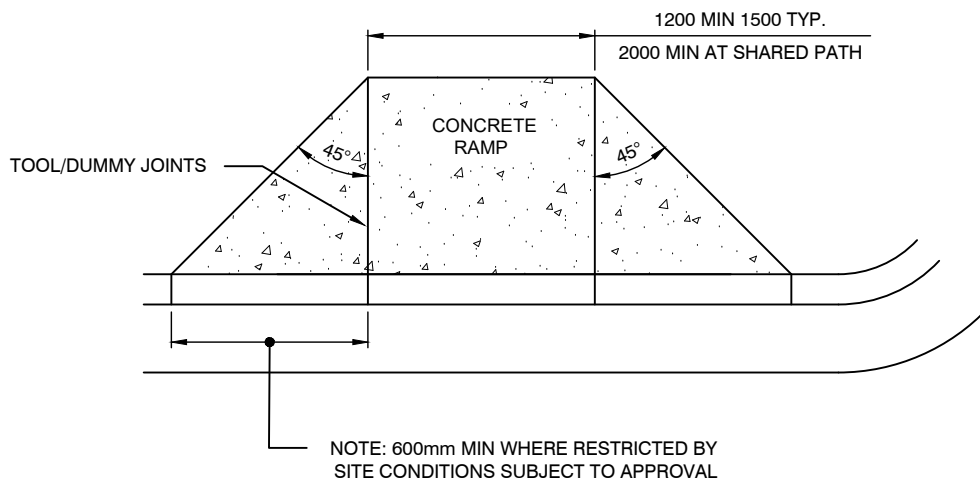

PLAN 1:50

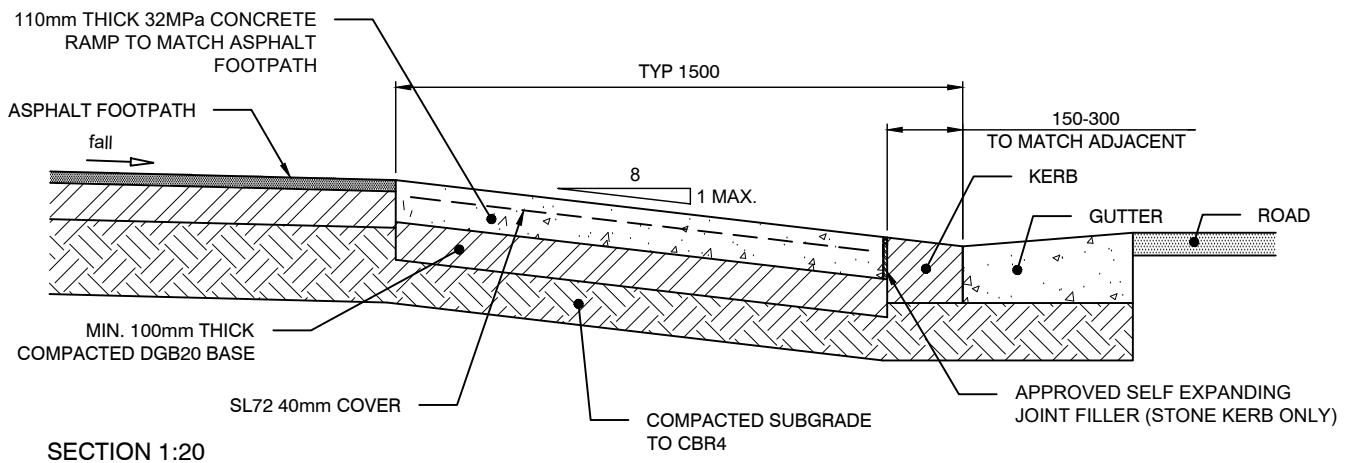

NOTE: ALL DIMENSIONS IN MILLIMETRES UNLESS OTHERWISE STATED

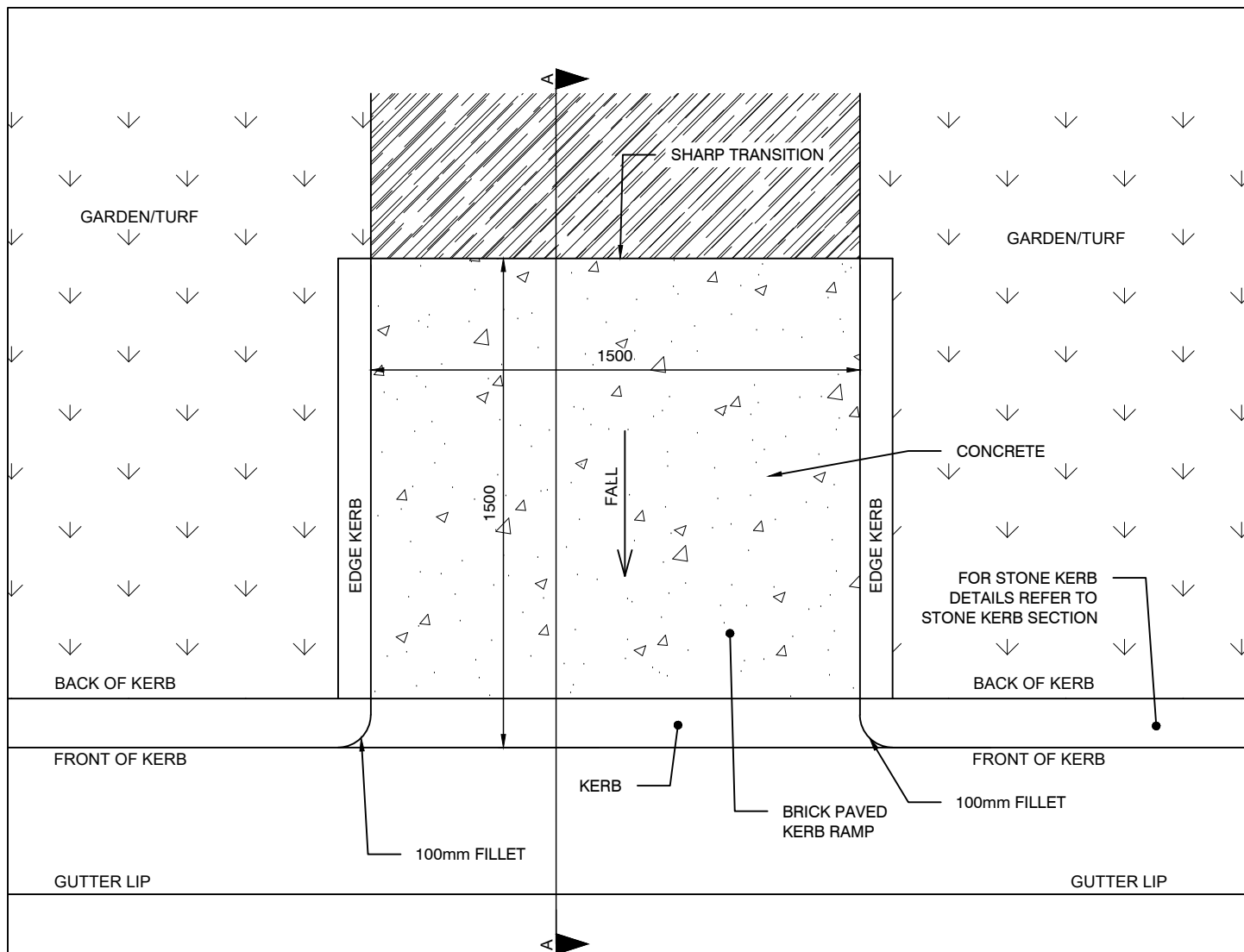

PLAN 1:20

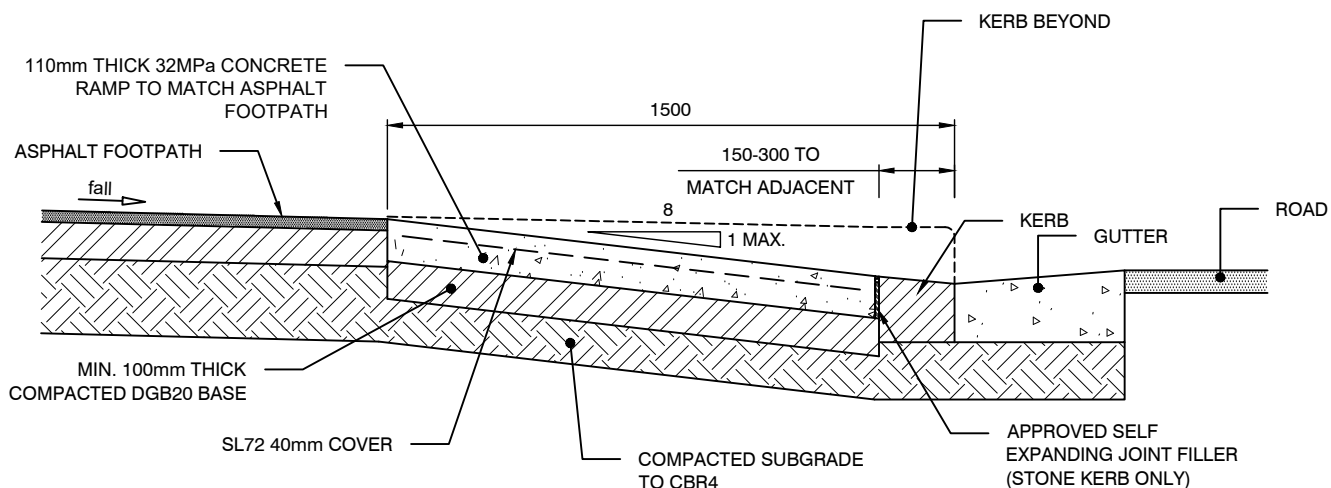

SECTION A-A 1:20

NOTE: ALL DIMENSIONS IN MILLIMETRES UNLESS OTHERWISE STATED

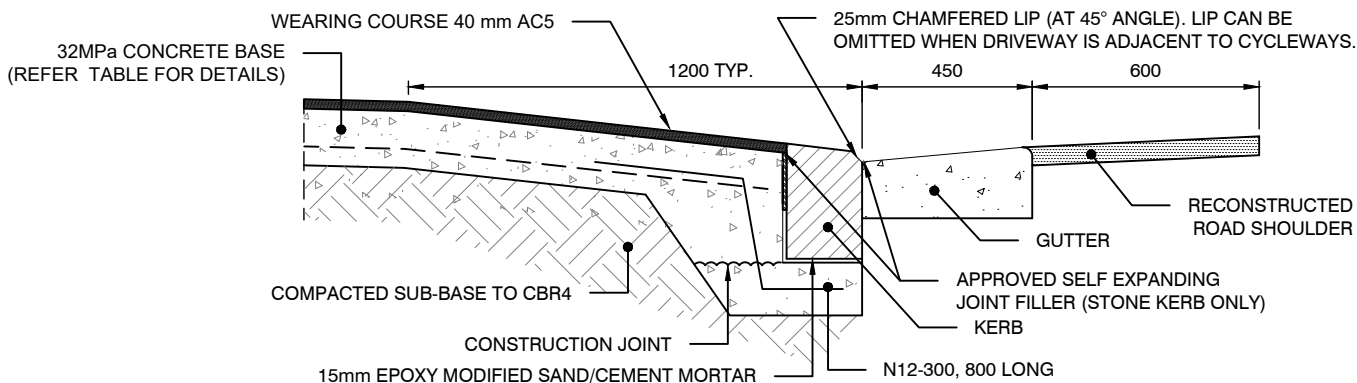
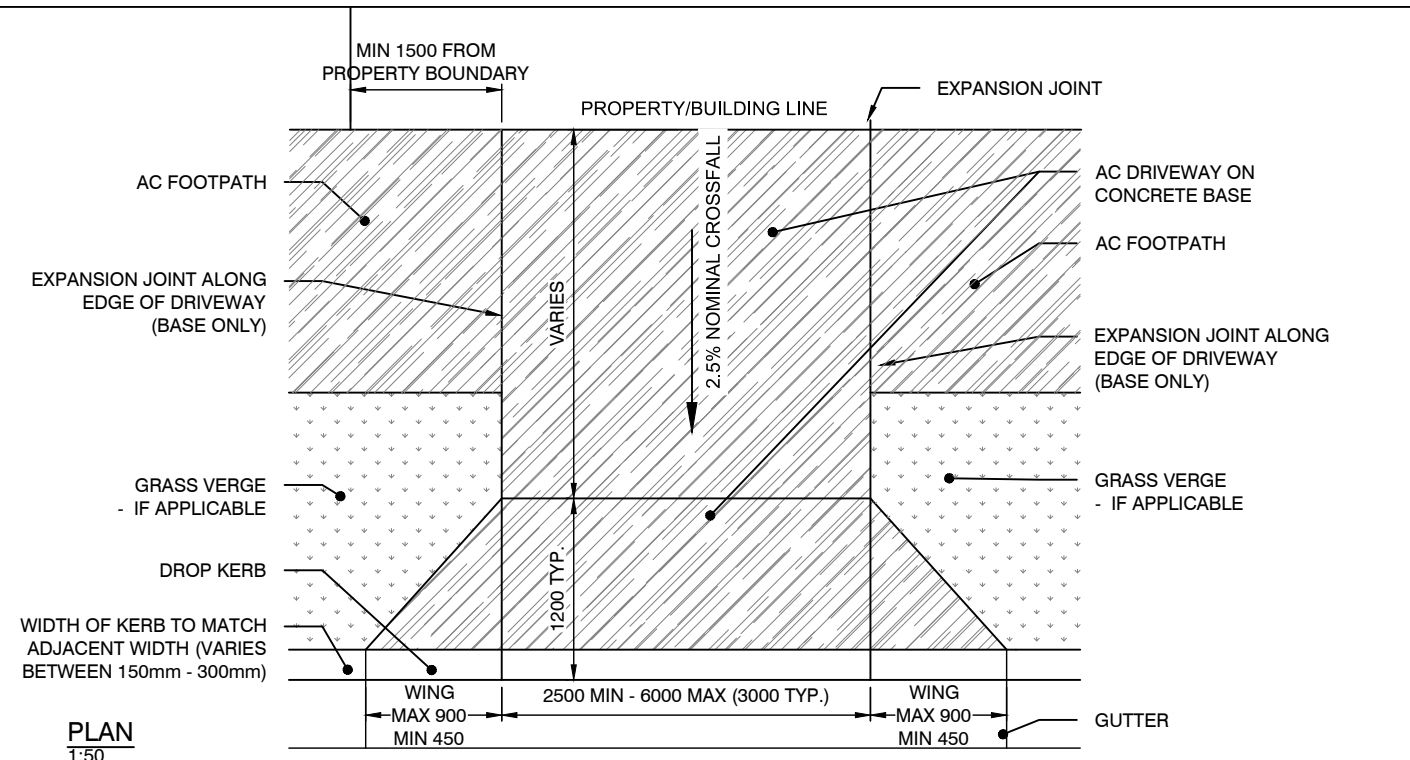

DRIVEWAY SPECIFICATIONS			
DRIVEWAY USE	CONCRETE STRENGTH	THICKNESS	REINFORCEMENT
SINGLE RESIDENTIAL	32MPa	150mm	SL82 CENTRALLY LOCATED
MULTI RESIDENTIAL	32MPa	200mm	SL82 CENTRALLY LOCATED

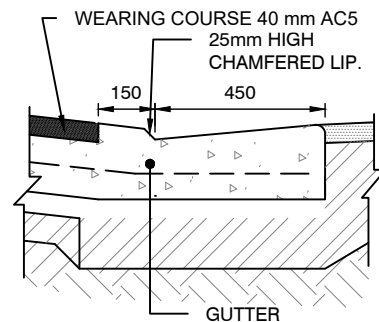

NOTES:

1. DRIVEWAY TO BE GENERALLY PERPENDICULAR TO KERB LINE, UNLESS APPROVED OTHERWISE.
2. FOR NARROW FOOTPATHS, LENGTH OF RAMP TO BE REDUCED TO 900mm, OR LAYBACK ONLY TO BE USED IN APPROVED APPLI
3. DRIVEWAY TO BE GENERALLY PERPENDICULAR TO KERB LINE, UNLESS APPROVED OTHERWISE.
4. VERTICAL AND HORIZONTAL CLEARANCE SHALL BE CHECKED BY THE DESIGNER IN ACCORDANCE WITH AS2890.1.
5. CONCRETE TO BE MINIMUM 32MPa

SECTION 1:20

NOTE: ALL DIMENSIONS IN MILLIMETRES UNLESS OTHERWISE STATED

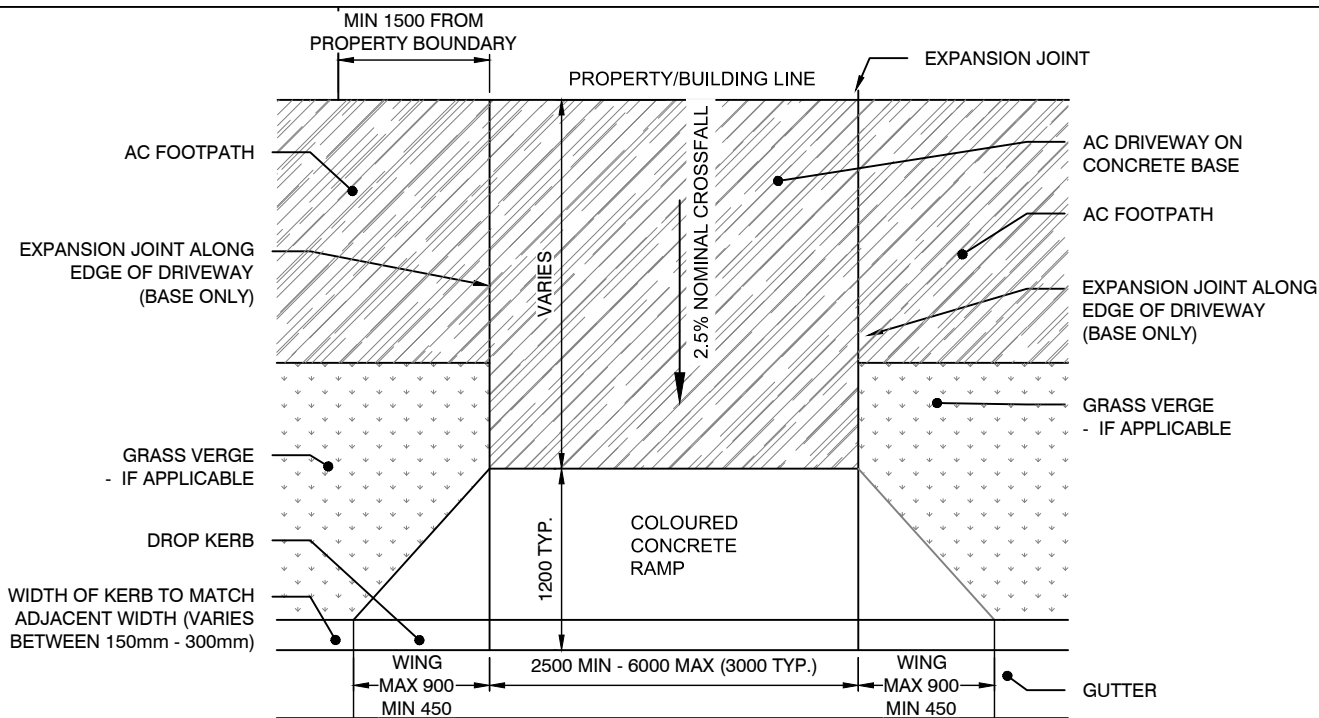

PLAN
1:50

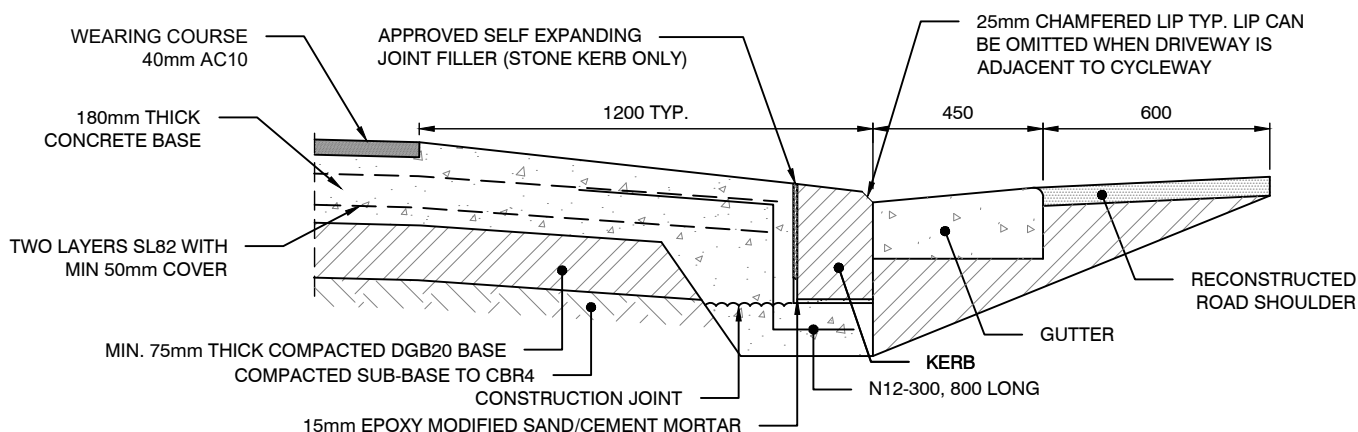

SECTION (WITH STONE KERB)
1:20

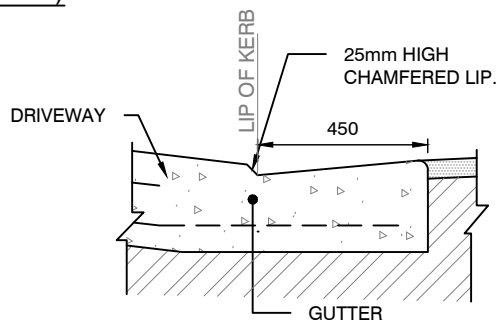

SECTION (WITH CONCRETE KERB)
1:20

NOTES:

1. THIS DRIVEWAY SUIT COMMERCIAL VEHICULAR CROSSINGS SUBJECTED TO AXLE LOADING OF 10 TONNES OR LIGHTER.
2. DRIVEWAY TO BE GENERALLY PERPENDICULAR TO KERB LINE, UNLESS APPROVED OTHERWISE.
3. VERTICAL AND HORIZONTAL CLEARANCE SHALL BE CHECKED BY THE DESIGNER IN ACCORDANCE WITH AS2890.1.
4. FOR NARROW FOOTPATHS, LENGTH OF RAMP TO BE REDUCED TO 900mm, OR LAYBACK ONLY TO BE USED IN APPROVED APPLICATIONS.
5. FOR DRIVEWAYS WIDER THAN 6.0m A TOOL JOINT SHALL BE PROVIDED ALONG THE CENTRE OF THE CONCRETE DRIVEWAY.
6. CONCRETE TO BE MINIMUM 32MPa.
7. TYPE OF KERB TO SUIT SYDNEY STREET CODE.

NOTE: ALL DIMENSIONS IN MILLIMETRES UNLESS OTHERWISE STATED

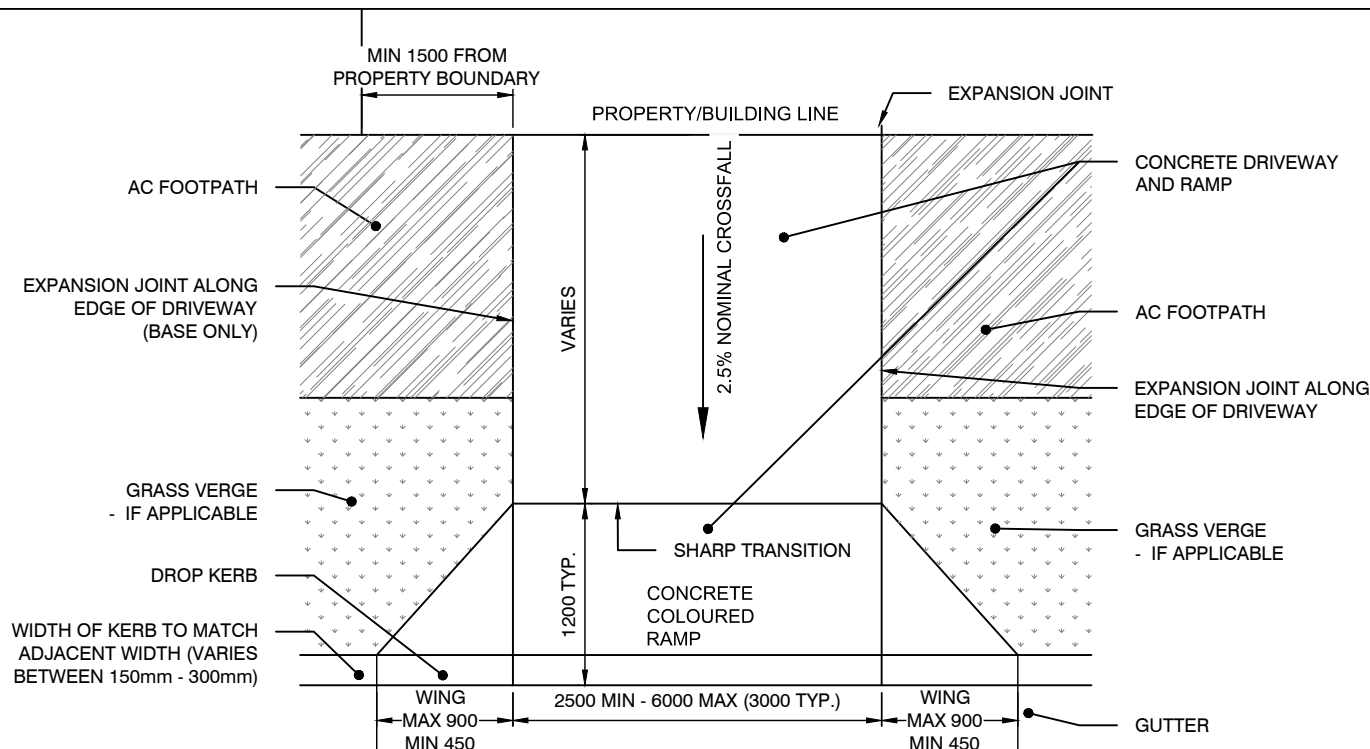

PLAN

1:50

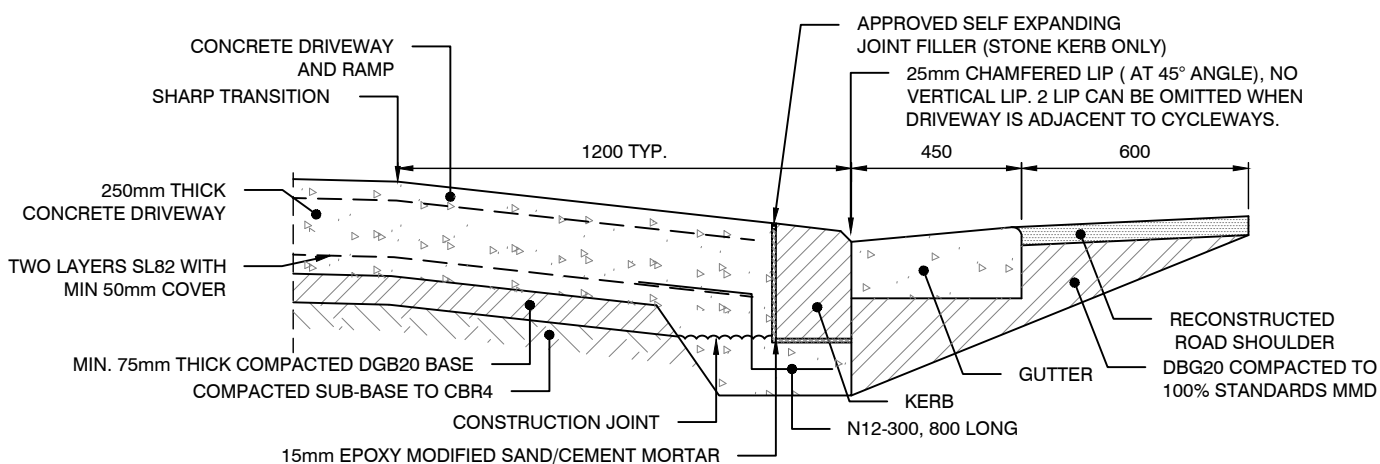

SECTION (WITH STONE KERB)

1:20

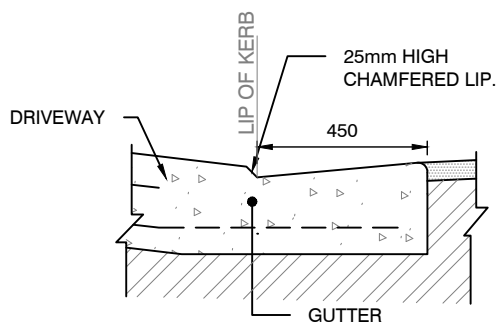

SECTION (WITH CONCRETE KERB)

1:20

1. THIS DRIVEWAY SUIT COMMERCIAL VEHICULAR CROSSINGS SUBJECTED TO AXLE LOADING HEAVIER THAN 10 TONNES.
2. DRIVEWAY TO BE GENERALLY PERPENDICULAR TO KERB LINE, UNLESS APPROVED OTHERWISE.
3. VERTICAL AND HORIZONTAL CLEARANCE SHALL BE CHECKED BY THE DESIGNER AS PER AS2890.1.
4. FOR NARROW FOOTPATHS, LENGTH OF RAMP TO BE REDUCED TO 900mm, OR LAYBACK ONLY TO BE USED IN APPROVED APPLICATIONS.
5. FOR DRIVEWAYS WIDER THAN 6.0m A TOOL JOINT SHALL BE PROVIDED ALONG THE CENTRE OF THE CONCRETE DRIVEWAY.
6. CONCRETE TO BE MINIMUM 32MPa.
7. TYPE OF KERB TO SUIT SYDNEY STREET CODE.

NOTE: ALL DIMENSIONS IN MILLIMETRES UNLESS OTHERWISE STATED

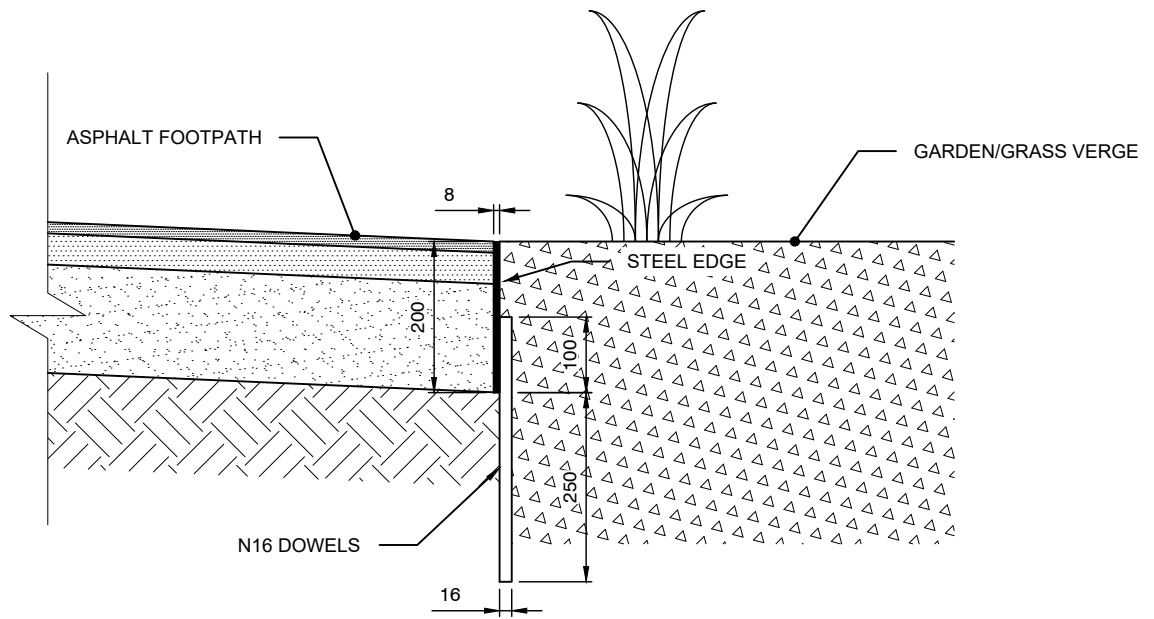

SECTION 1:10

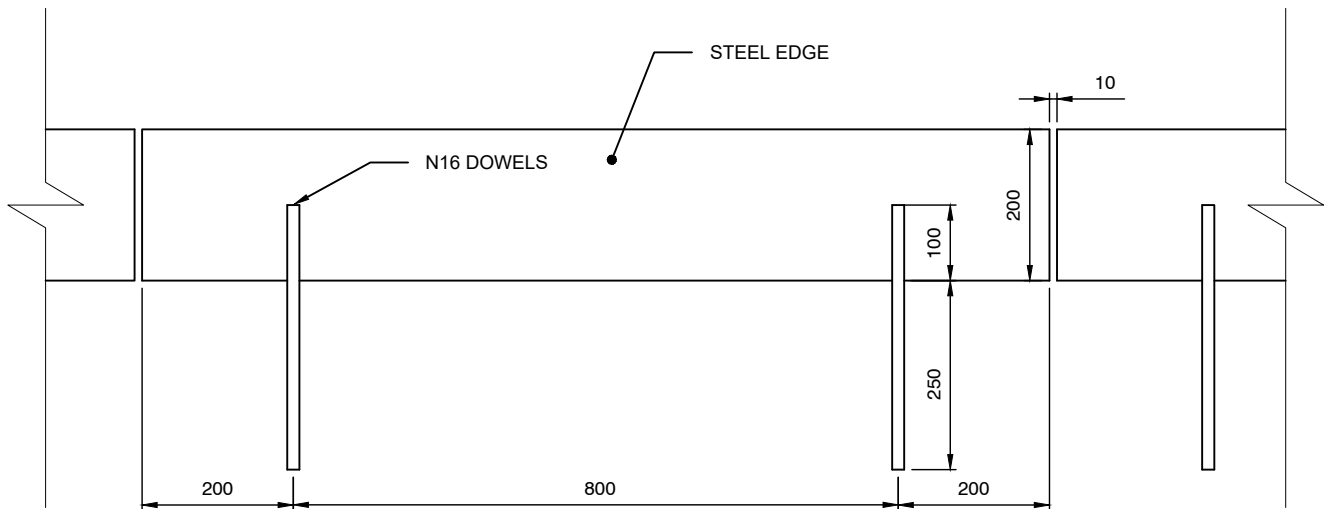

ELEVATION 1:10

NOTES:

1. ALL STEELWORK TO BE HOT DIPPED GALVANISED.
2. ALL STEELWORK BELOW GROUND LEVEL TO BE PAINTED WITH TWO COATS OF BITUMINOUS PAINT.

NOTE: ALL DIMENSIONS IN MILLIMETRES UNLESS OTHERWISE STATED

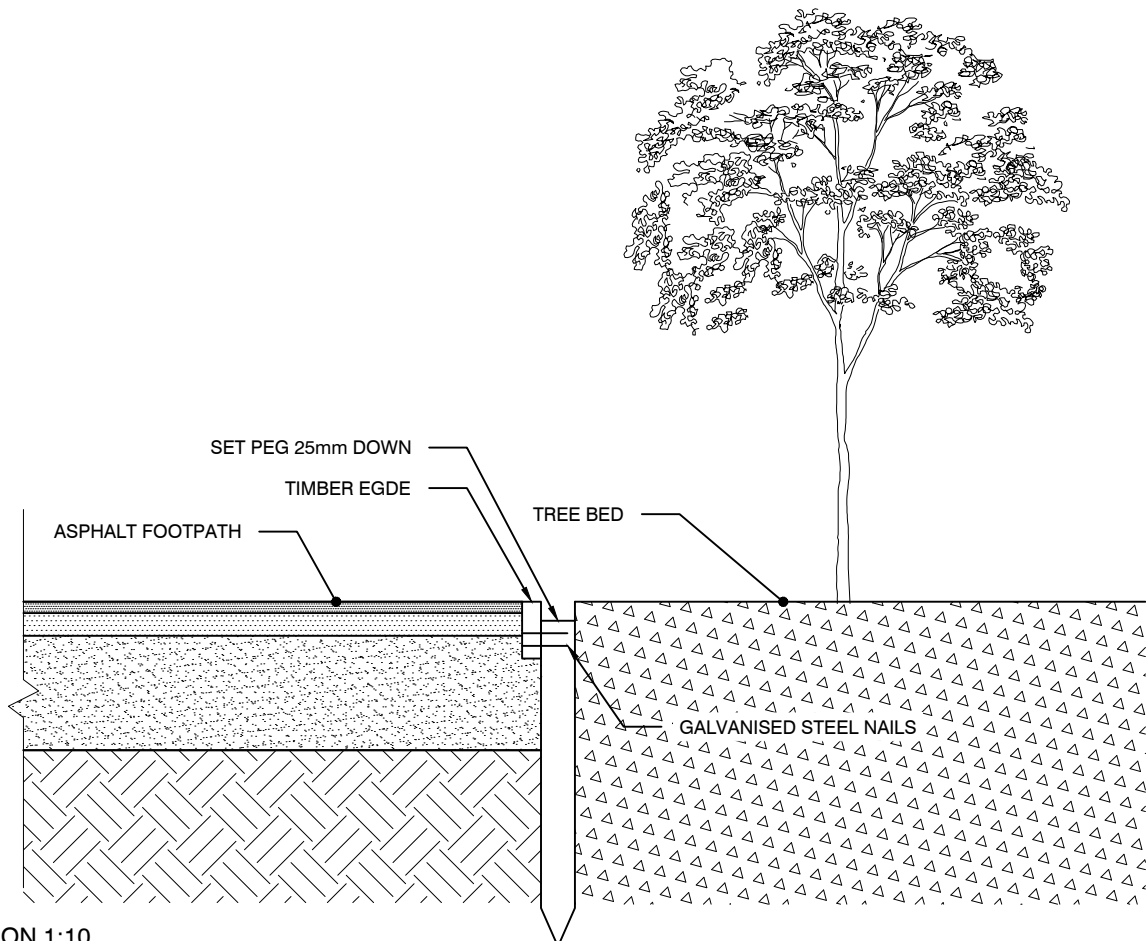

SECTION 1:10

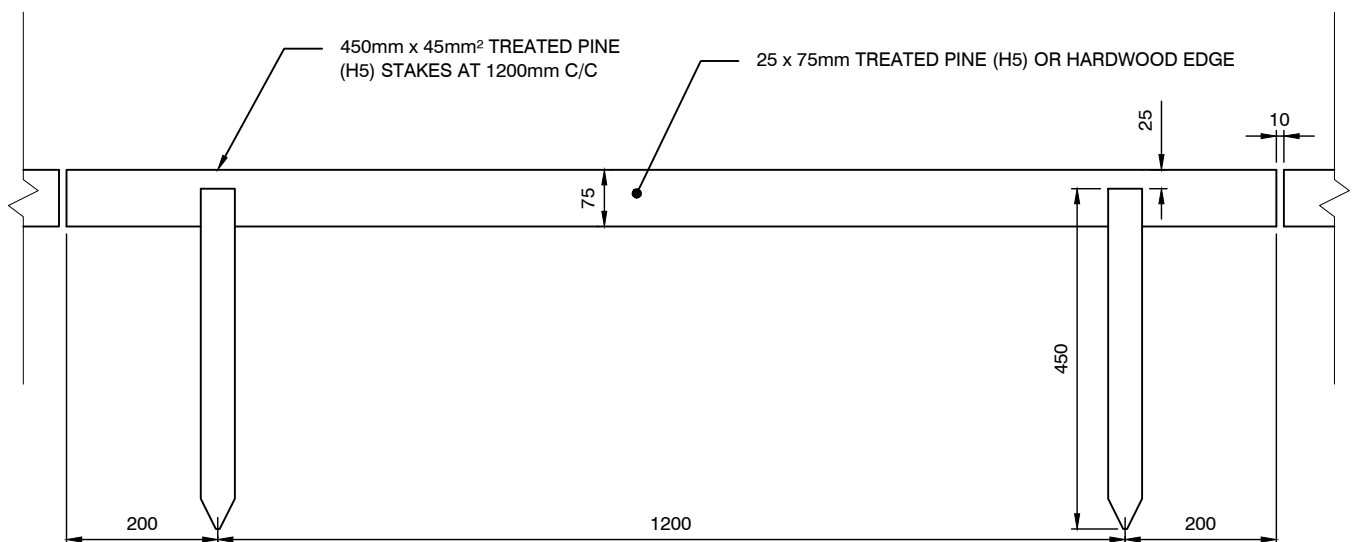

ELEVATION 1:10

NOTE: ALL DIMENSIONS IN MILLIMETRES UNLESS OTHERWISE STATED