

RIGID ROAD PAVEMENT (ASPHALT SURFACE OPTIONAL)

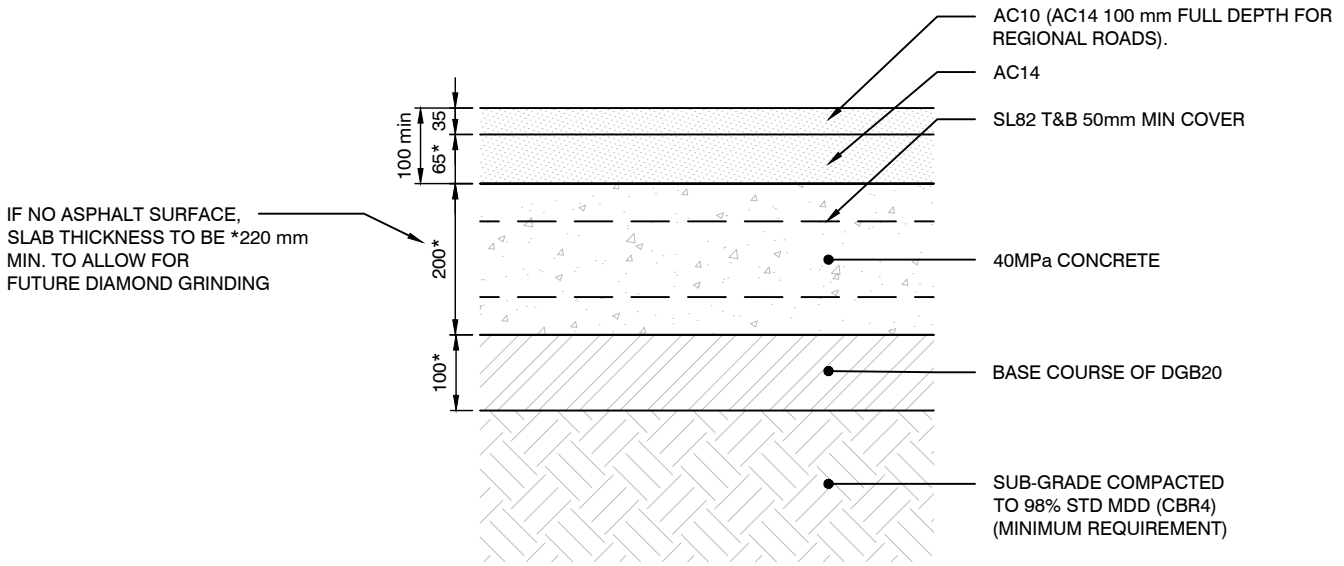

FLEXIBLE ROAD PAVEMENT

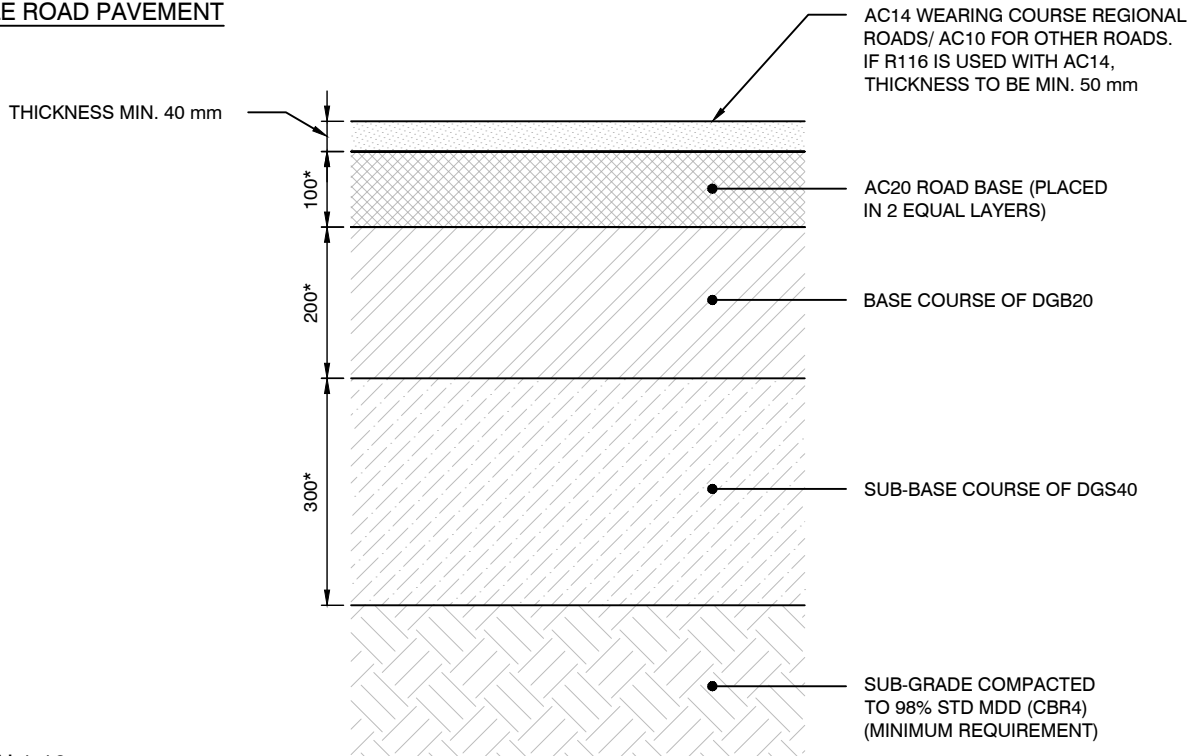

SECTION 1:10

NOTES:

1. THESE ARE TYPICAL DRAWINGS ONLY.
- *2. FOR NEW ROADS, PAVEMENT THICKNESSES SHALL BE DETERMINED BY DESIGN BASED ON SUBGRADE CBR, MATERIAL TYPE AND PROPERTIES, AND ESAS (EQUIVALENT STANDARD AXLES). ALL PAVEMENT DESIGN REQUIREMENTS AND PROCEDURES SET IN SECTION "A3 ROADS, STREET AND STRUCTURES DESIGN" SHALL BE MET IN DESIGN AND JUSTIFIED IN DESIGN REPORT.
3. ALL DIMENSIONS IN MILLIMETRES UNLESS OTHERWISE STATED.

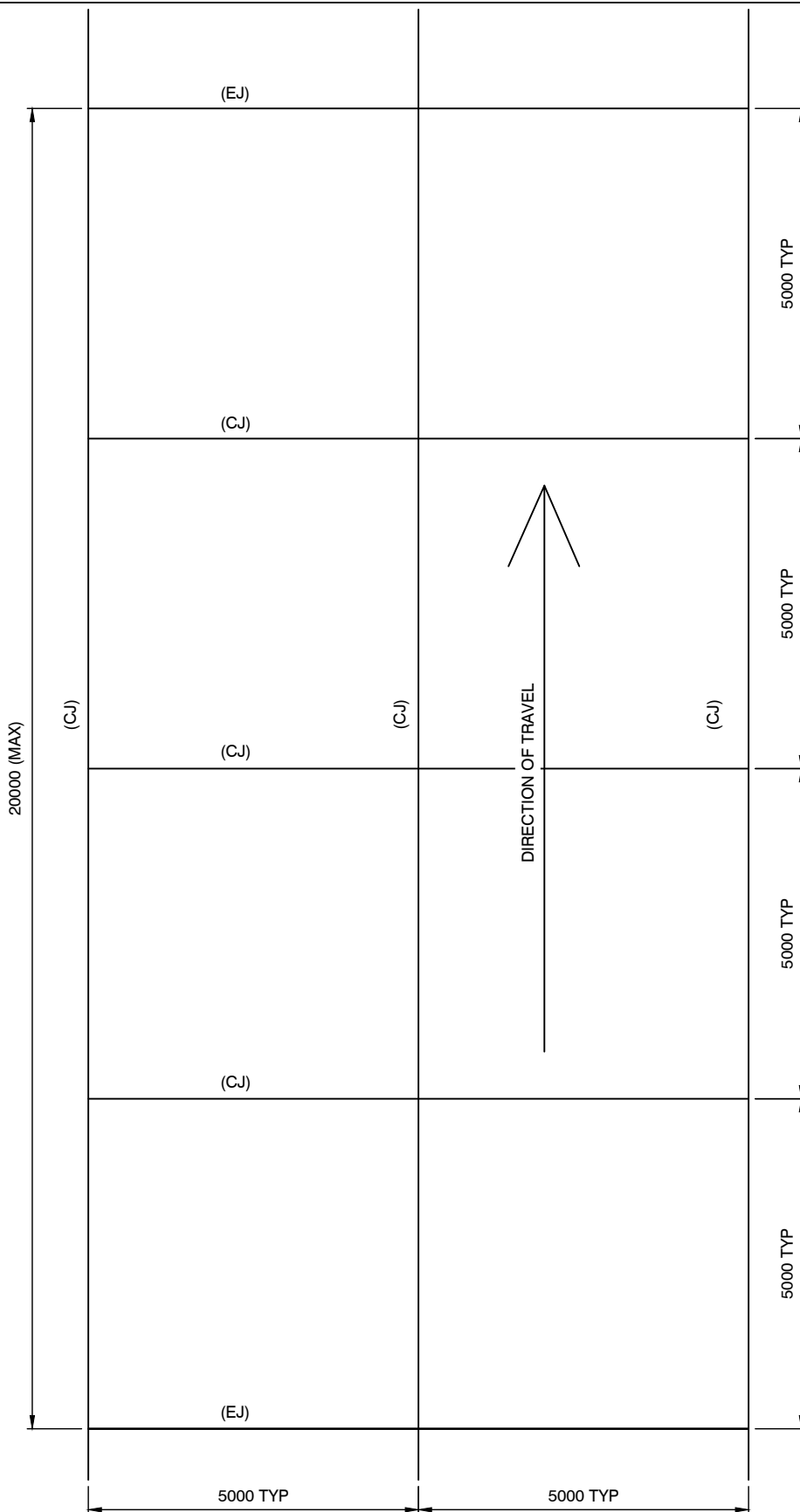

NOTES

1. TRANSVERSE EXPANSION JOINTS SHALL BE PLACED AT 20m MAXIMUM SPACING ON CONTINUOUS PAVEMENT.
2. TRANSVERSE CONTRACTION JOINTS TO BE PLACED AT 5m MAXIMUM SPACING ON CONTINUOUS PAVEMENT.
3. CONSTRUCTION JOINTS SHALL BE PLACED AT WORK EXTENTS WHEN JOINING ONTO ADJACENT RIGID PAVEMENTS.

SCALE 1:100

NOTE: ALL DIMENSIONS IN MILLIMETRES UNLESS OTHERWISE STATED

EXPANSION JOINT (EJ)

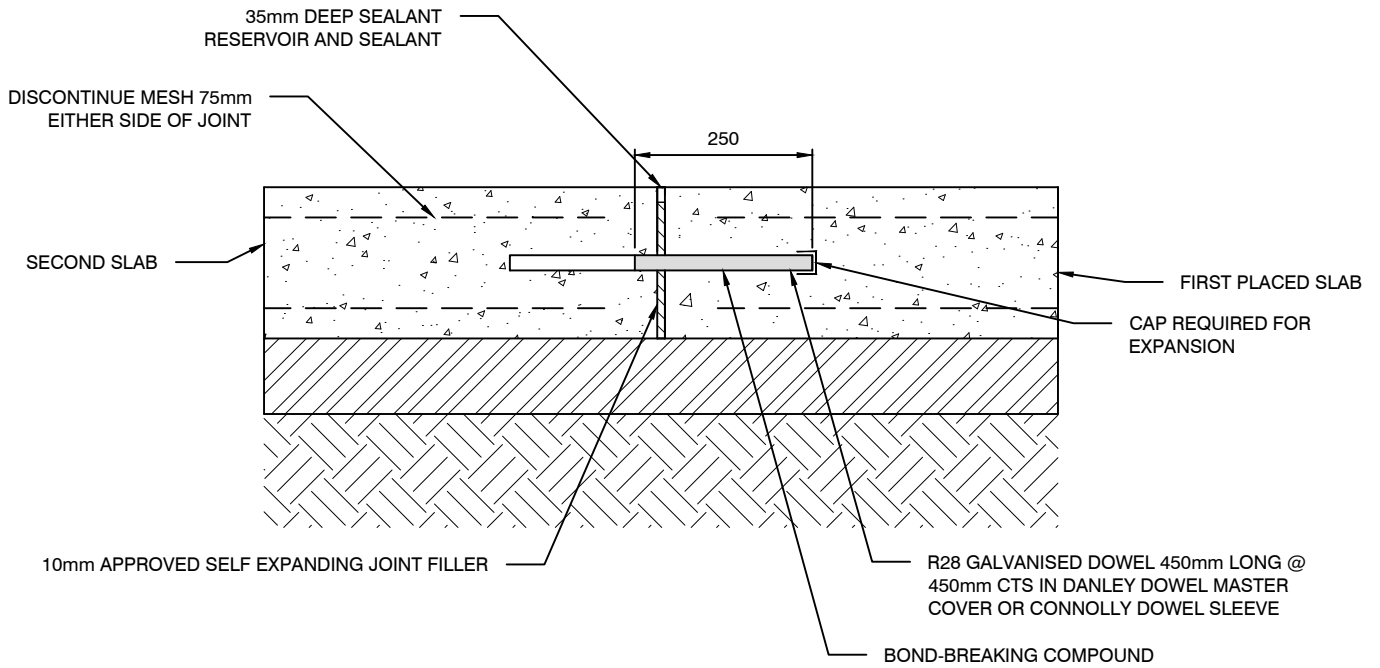

CONTRACTION JOINT/CONTROL JOINT (CJ)

10mm WIDE SAW CUT. DEPTH TO EQUAL $\frac{1}{3}$ TO $\frac{1}{4}$ THE DEPTH OF THE SLAB. CUT TO BE SEALED WITH FLEXIBLE SEALANT AND BACKING ROD

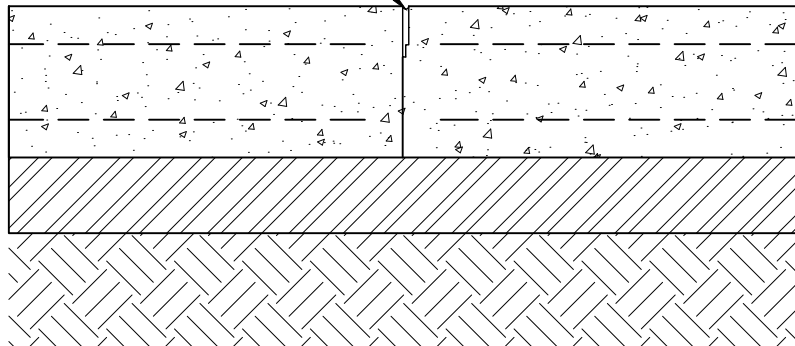

NOTES:

1. TRANSVERSE EXPANSION JOINTS SHALL BE PLACED AT 20m MAXIMUM SPACING.
2. TRANSVERSE CONTRACTION JOINTS TO BE PLACED AT 5m MAXIMUM SPACING.
3. BOND-BREAKING COMPONENT AND END CAP MAY BE REPLACED WITH A PURPOSE-MADE DOWEL SLEEVE.

SECTION 1:10

NOTE: ALL DIMENSIONS IN MILLIMETRES UNLESS OTHERWISE STATED

CONSTRUCTION JOINT (DCJ)

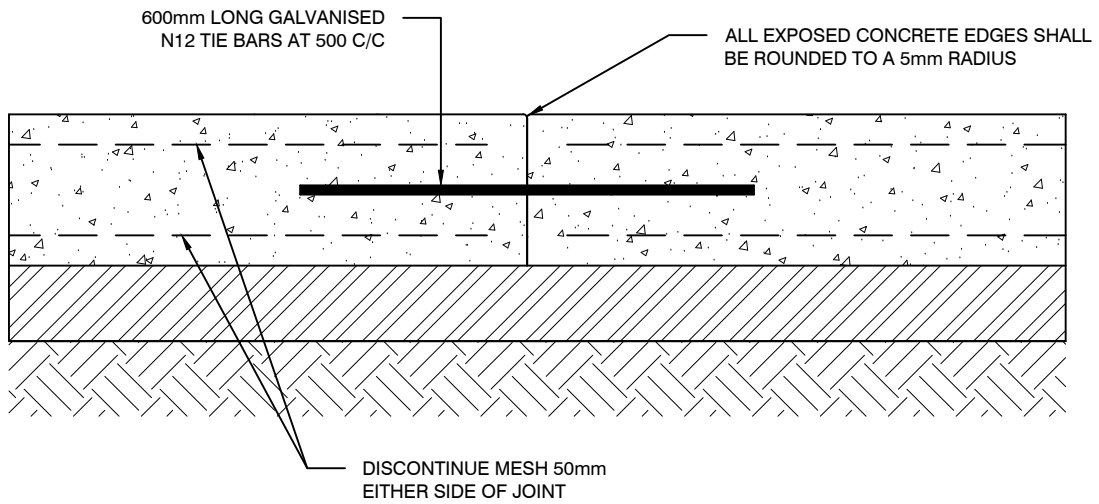

NOTE:

ALL TIE BARS TO BE DEFORMED BARS.

SECTION 1:10

ISOLATION JOINT

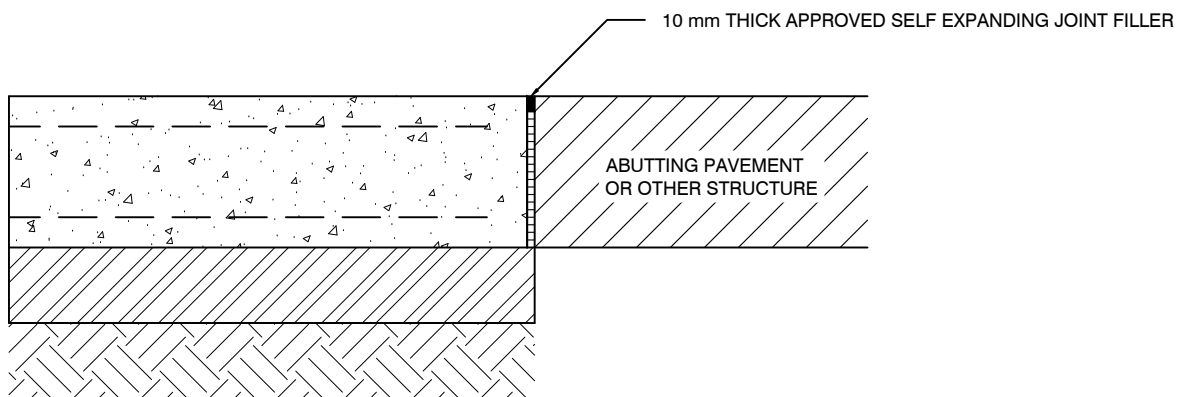

NOTE: ALL DIMENSIONS IN MILLIMETRES UNLESS OTHERWISE STATED

CONCRETE ROAD

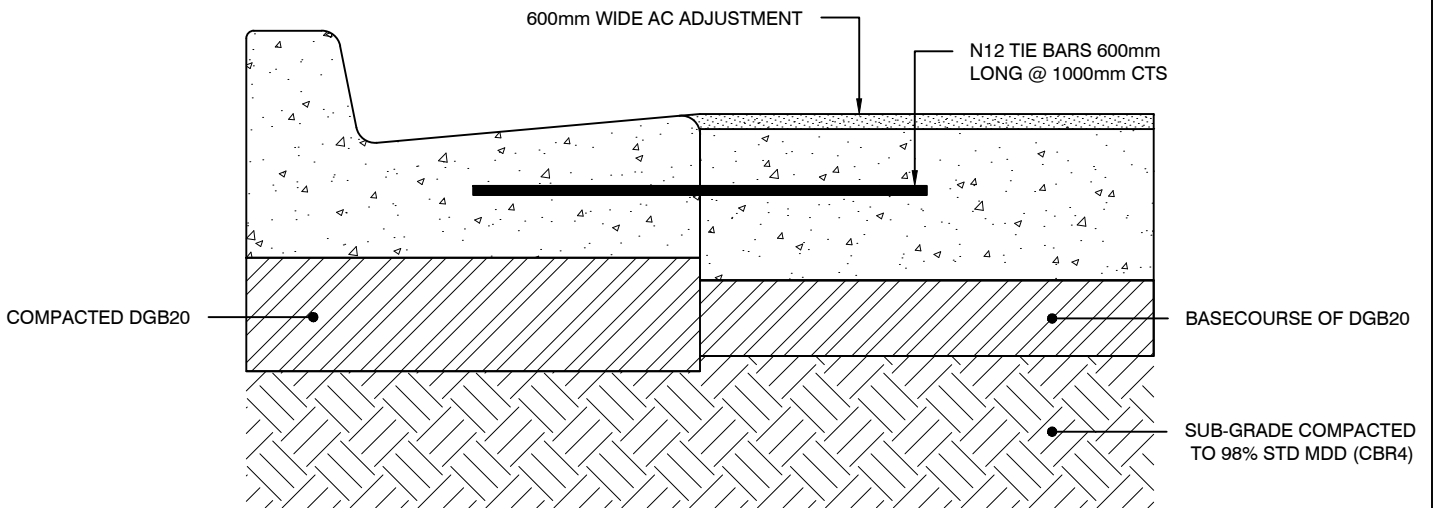

SECTION 1:10

NOTE: ALL DIMENSIONS IN MILLIMETRES UNLESS OTHERWISE STATED

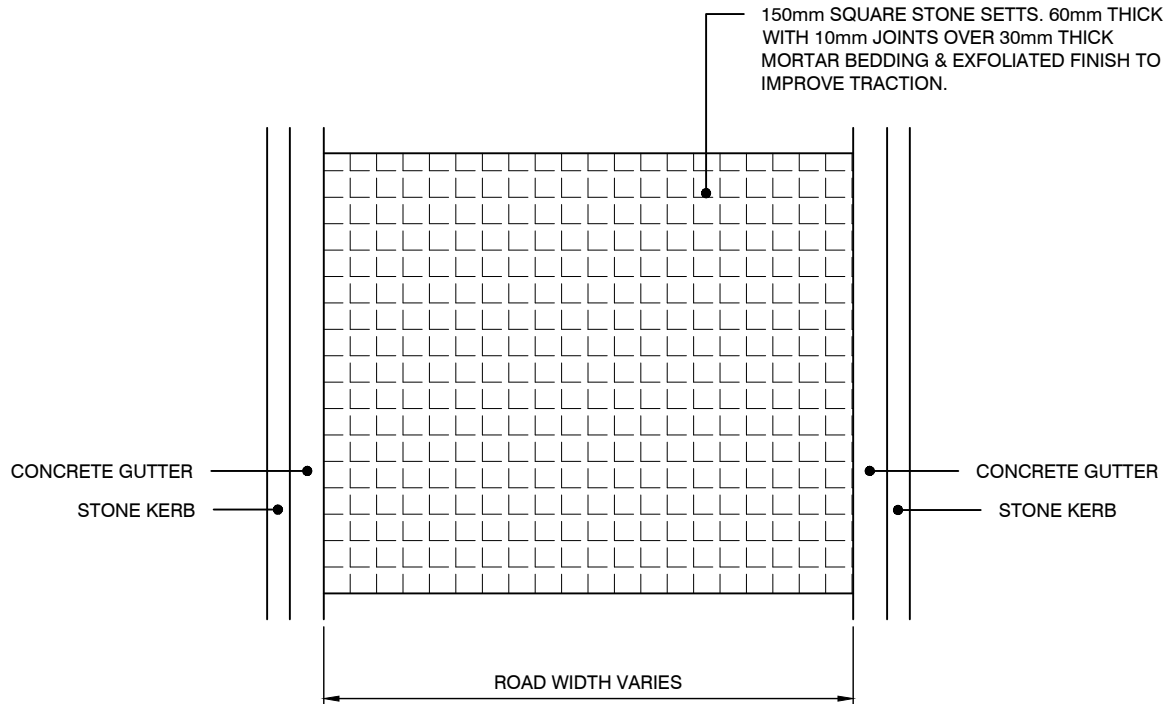

PLAN 1:100

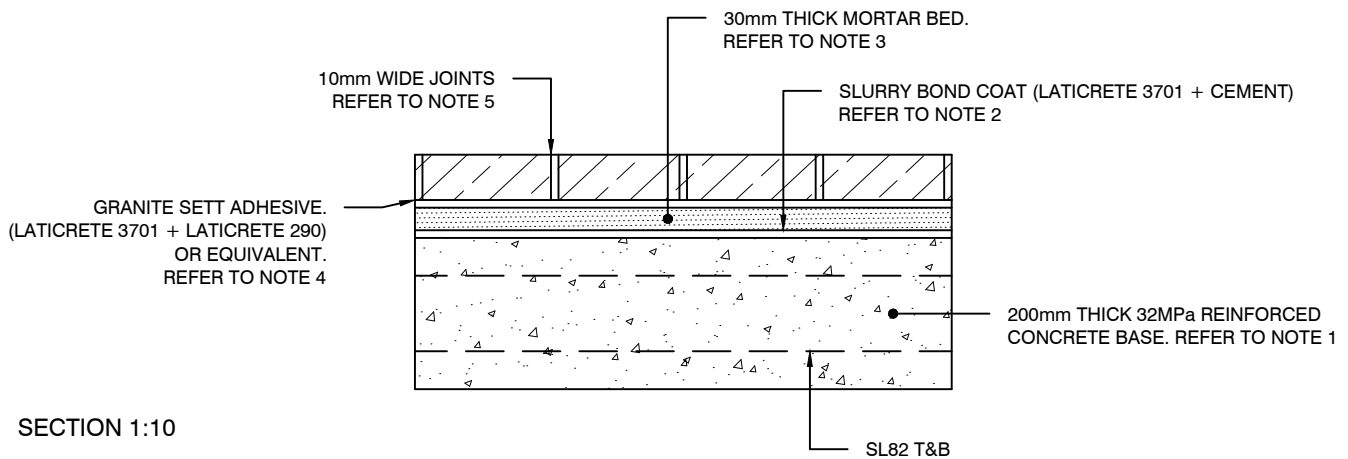

SECTION 1:10

NOTES:

1. SURFACE SHALL BE MADE PLUMB & TRUE WITHIN 3mm AND SHALL HAVE A WOODEN FLOAT FINISH.
2. MORTAR BED SHALL BE LAID WHILE THE SLURRY BOND COAT IS STILL WET & TACKY.
3. 30mm THICK MORTAR BEDDING FINISHED TO A WOOD FLOAT QUALITY. THE BEDDING SHALL BE OF MODIFIED MORTAR (3:1 SAND:CEMENT) MIXED WITH LATICRETE 3701 MORTAR ADMIX & LATICRETE 226 OR EQUIVALENT THICK BED MORTAR AS PER THE MANUFACTURER'S SPECIFICATIONS.
4. THE GRANITE SETTS SHALL BE ADHERED TO THE CURED BEDDING USING A MIX OF LATICRETE 290 PREMIUM MORTAR & LATICRETE 3701 MORTAR ADMIX AS PER THE MANUFACTURER'S SPECIFICATIONS.
5. USE MODIFIED MORTAR (3:1 SAND:CEMENT) MIXED WITH LATICRETE 3701 OR EQUIVALENT MORTAR ADMIX, LATICRETE 226 OR EQUIVALENT THICK BED MORTAR TO MATCH SETTS COLOUR.

NOTE: ALL DIMENSIONS IN MILLIMETRES UNLESS OTHERWISE STATED

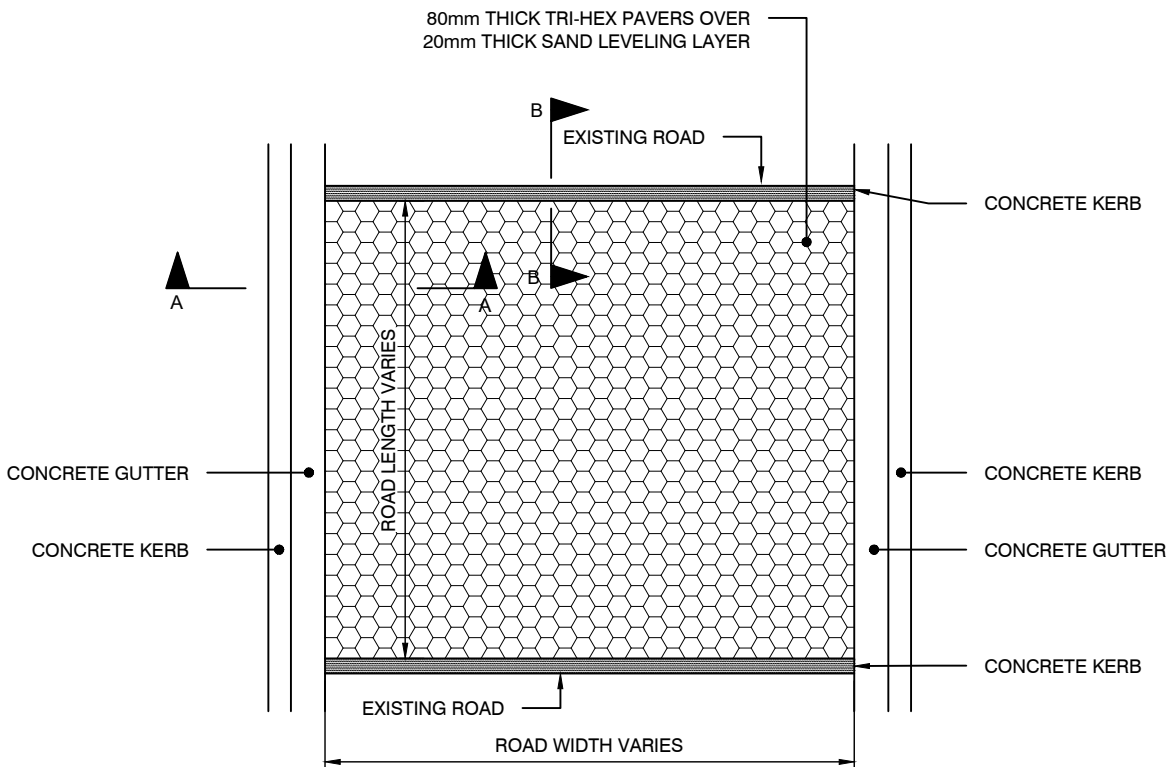

PLAN 1:100

SECTION A-A

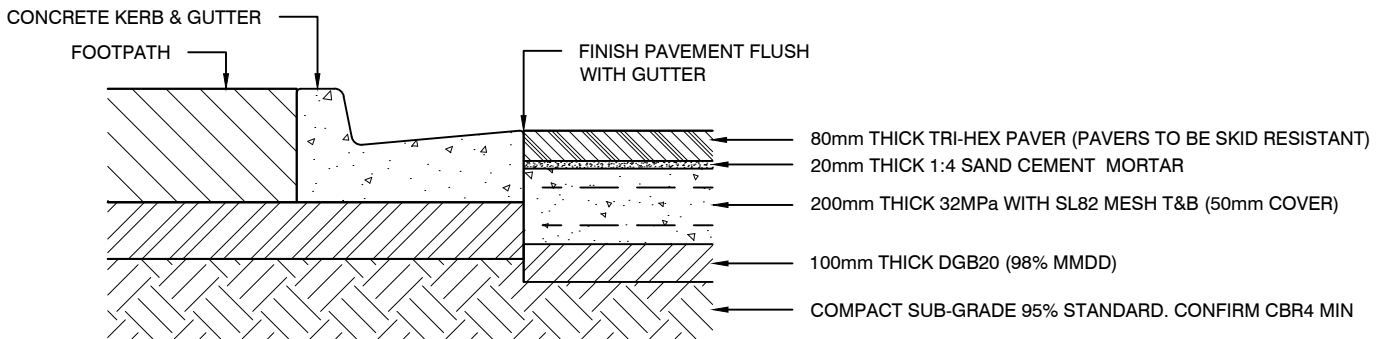

SECTION B-B

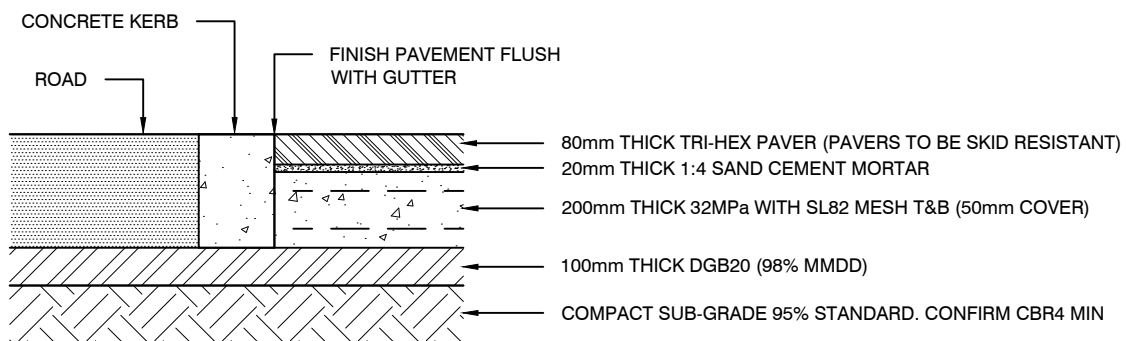

SECTION 1:20

NOTE: ALL DIMENSIONS IN MILLIMETRES UNLESS OTHERWISE STATED

NOTE:
THE USE OF THIS TREATMENT IS
SUBJECT TO RMS' APPROVAL

FLUSH CONCRETE KERB

150mm SQUARE STONE SETTS. 60mm THICK
WITH 10mm JOINTS OVER 30mm THICK
MORTAR BEDDING & EXFOLIATED FINISH TO
IMPROVE TRACTION.

STONE KERB

CONCRETE GUTTER

KERB RAMP

FOOTPATH

1500

FOOTPATH

KERB RAMP

CONCRETE GUTTER

STONE KERB

FLUSH CONCRETE KERB

ROAD WIDTH VARIES

PLAN 1:100

SLURRY BOND COAT (LATICRETE 3701 + CEMENT)
REFER TO NOTE 2

30mm THICK MORTAR BED.
REFER TO NOTE 3

10mm WIDE JOINTS
REFER TO NOTE 5

150mm WIDE FLUSH
CONCRETE KERB

ROAD

GRANITE SETT ADHESIVE.
LATICRETE 3701 + LATICRETE 290.
REFER TO NOTE 4

200mm THICK 32MPa REINFORCED
CONCRETE BASE. REFER TO NOTE 1

SL82 T&B

100mm THICK DGB20 (98% MMDD)

SECTION 1:10

COMPACTED SUB-GRADE 95%
STANDARD. CONFIRM CBR4 MIN

NOTES:

1. SURFACE SHALL BE MADE PLUMB & TRUE WITHIN 3mm AND SHALL HAVE A WOODEN FLOAT FINISH.
2. MORTAR BED SHALL BE LAID WHILE THE SLURRY BOND COAT IS STILL WET & TACKY.
3. 30mm THICK MORTAR BEDDING FINISHED TO A WOOD FLOAT QUALITY. THE BEDDING SHALL BE OF MODIFIED MORTAR (3:1 SAND:CEMENT) MIXED WITH LATICRETE 3701 MORTAR ADMIX & LATICRETE 226 THICK BED MORTAR AS PER THE MANUFACTURERS'S SPECIFICATIONS.
4. THE GRANITE SETTS SHALL BE ADHERED TO THE CURED BEDDING USING A MIX OF LATICRETE 290 PREMIUM MORTAR & LATICRETE 3701 MORTAR ADMIX AS PER THE MANUFACTURER'S SPECIFICATIONS.
5. USE MODIFIED MORTAR (3:1 SAND:CEMENT) MIXED WITH LATICRETE 3701 MORTAR ADMIX, LATICRETE 226 THICK BED MORTAR TO MATCH SETTS COLOUR.

NOTE: ALL DIMENSIONS IN MILLIMETRES UNLESS OTHERWISE STATED

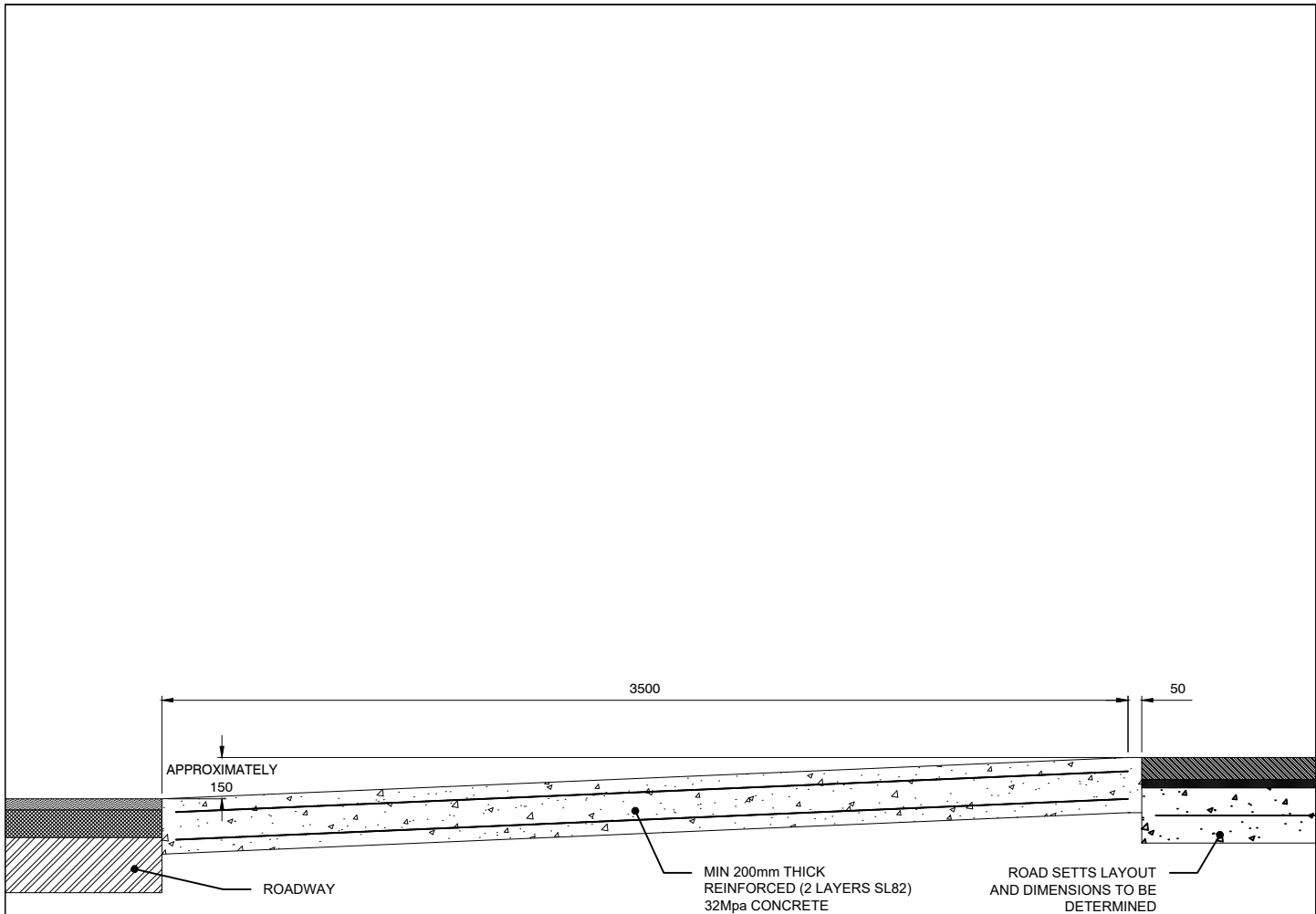

NOTE:

1. RAMP CONCRETE TO BE COLOURED BLACK WITH OXIDE
2. PIANO KEY LINE MARKING TO BE IN ACCORDANCE WITH AS1742

SECTION 1:25

NOTE: ALL DIMENSIONS IN MILLIMETRES UNLESS OTHERWISE STATED

	ROAD PAVEMENTS	ROADWAYS
	ROAD INTERSECTION RAMPS (GEORGE ST PEDESTRIAN ZONE)	Rev D Date 01.12.19 Approved P S