

Right Of Way

Code: 177533

Site

Code: 177533

Name: Right Of Way

Suburb: Surry Hills

Address: 610B Crown Street, SURRY HILLS, 2010

Detail

Owner: City Of Sydney

Property Type: Right of Way

LGA 1993 Classification: Community Land

Total Land Area: 94 square metres

City of Sydney Interest: Freehold

Condition and Heritage

Condition: 3 - Average

☐ LEP Heritage Items

Available Park Facilities

☐ Playground

☐ Basketball Or Netball Structures

☐ Swimming Pool

☐ Car Park

☐ Turf Wicket

☐ Skate Ramp

☐ Changerooms Other Type Facility

☐ Sports Fields

☐ Concrete Wicket

☐ Tennis Courts

Categorisation s.36(4)

☒ General Community

☐ Natural Area

☐ Park

☐ Area of Cultural Significance

☐ Sportsground

Real Property Description

Lot 9 DP 11379

Supporting Occupations

Locality Map

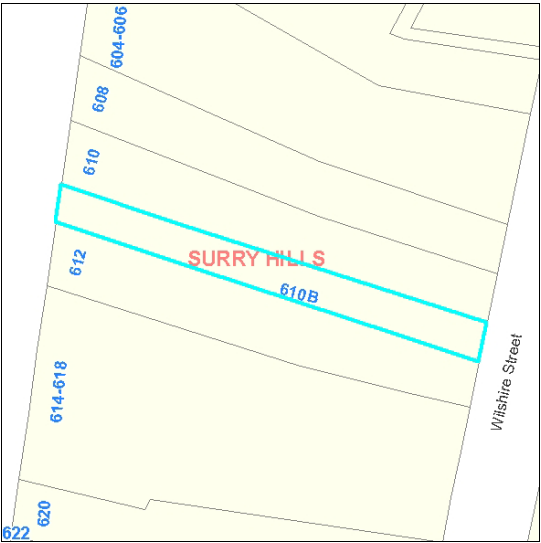

Site

Code: 181376

Name: Reserve

Address: 1B Mort Street, SURRY HILLS, 2010

Suburb: Surry Hills

Detail

Owner: City Of Sydney

LGA 1993 Classification: Community Land

City of Sydney Interest: Freehold

Property Type: Reserve

Total Land Area: 15 square metres

Condition and Heritage

Condition: 3 - Average

☐ LEP Heritage Items

Available Park Facilities

- ☐ Playground
- ☐ Basketball Or Netball Structures
- ☐ Swimming Pool
- ☐ Car Park
- ☐ Turf Wicket
- ☐ Skate Ramp
- ☐ Changerooms Other Type Facility
- ☐ Sports Fields
- ☐ Concrete Wicket
- ☐ Tennis Courts

Categorisation s.36(4)

- ☒ General Community
- ☐ Natural Area
- ☐ Park
- ☐ Area of Cultural Significance
- ☐ Sportsground

Real Property Description

Lot 67 DP 314

Supporting Occupations

Locality Map

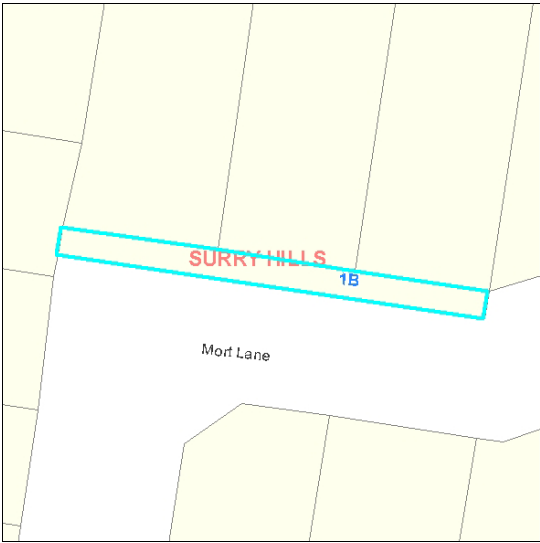

## Old Air Raid Shelter

**185477**

## Site

**Code: 185477**

**Name:** Old Air Raid Shelter **Suburb:** Erskineville

**Address:** Old Air Raid Shelter, 17A Albert Street, ERSKINEVILLE, 2043

### Detail

**Owner:** City Of Sydney **Property Type:** Community Building

**LGA 1993 Classification:** Community Land **Total Land Area:** 69 square metres

**City of Sydney Interest:** Freehold

## Condition and Heritage

**Condition:** 3 - Average ☐ LEP Heritage Items **No of Buildings:** 1

### Available Park Facilities

☐ Playground    ☐ Basketball Or Netball Structures    ☐ Swimming Pool    ☐ Car Park    ☐ Turf Wicket  
☐ Skate Ramp    ☐ Changerooms Other Type Facility    ☐ Sports Fields    ☐ Concrete Wicket    ☐ Tennis Courts

### Categorisation s.36(4)

☒ General Community ☐ Natural Area ☐ Park ☐ Area of Cultural Significance ☐ Sportsground

## Real Property Description

Current title Vol 9273 Fol 240

## Supporting Occupations

### Locality Map



Site

Code: 188866

Name: Drainage Reserve

Suburb: Rosebery

Address: 86A Gardeners Road, ROSEBERY, 2018

Detail

Owner: City Of Sydney

Property Type: Drainage Reserve

LGA 1993 Classification: Community Land

Total Land Area: 296 square metres

City of Sydney Interest: Freehold

Condition and Heritage

Condition: 3 - Average

☐ LEP Heritage Items

Available Park Facilities

- ☐ Playground
- ☐ Basketball Or Netball Structures
- ☐ Swimming Pool
- ☐ Car Park
- ☐ Turf Wicket
- ☐ Skate Ramp
- ☐ Changerooms Other Type Facility
- ☐ Sports Fields
- ☐ Concrete Wicket
- ☐ Tennis Courts

Categorisation s.36(4)

- ☒ General Community
- ☐ Natural Area
- ☐ Park
- ☐ Area of Cultural Significance
- ☐ Sportsground

Real Property Description

Lot 753 DP 7534

Supporting Occupations

Locality Map

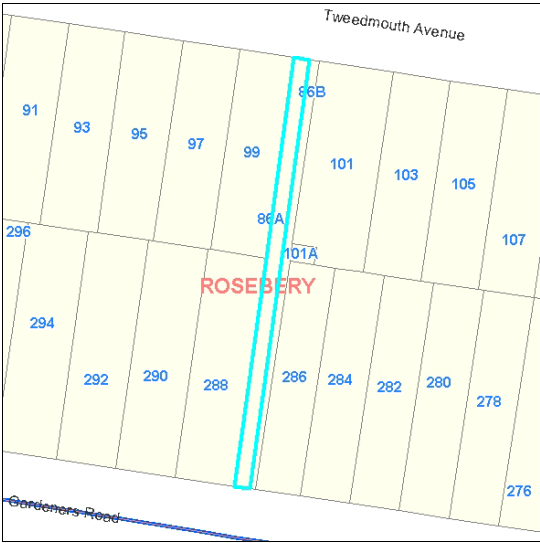

Site

Code: 188867

Name: Pathway

Suburb: Rosebery

Address: 86B Gardeners Road, ROSEBERY, 2018

Detail

Owner: City Of Sydney

Property Type: Pathway

LGA 1993 Classification: Community Land

Total Land Area: 156 square metres

City of Sydney Interest: Freehold

Condition and Heritage

Condition: 3 - Average

☐ LEP Heritage Items

Available Park Facilities

- ☐ Playground
- ☐ Basketball Or Netball Structures
- ☐ Swimming Pool
- ☐ Car Park
- ☐ Turf Wicket
- ☐ Skate Ramp
- ☐ Changerooms Other Type Facility
- ☐ Sports Fields
- ☐ Concrete Wicket
- ☐ Tennis Courts

Categorisation s.36(4)

- ☒ General Community
- ☐ Natural Area
- ☐ Park
- ☐ Area of Cultural Significance
- ☐ Sportsground

Real Property Description

Lot 751 DP 7534

Supporting Occupations

Locality Map

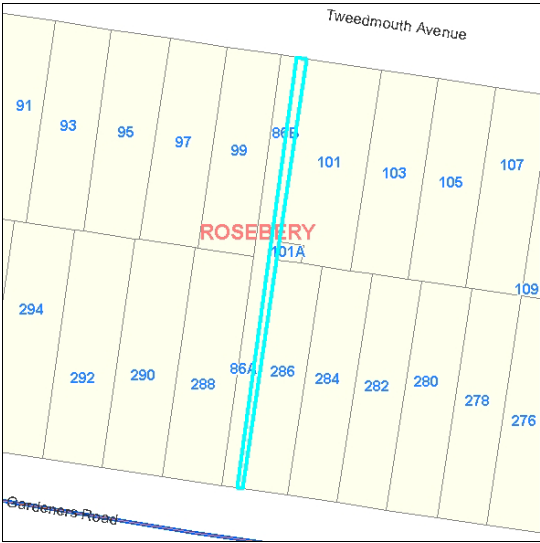

Site

Code: 189646

Name: Drainage Reserve

Suburb: Rosebery

Address: 100A Harcourt Parade, ROSEBERY, 2018

Detail

Owner: City Of Sydney

Property Type: Drainage Reserve

LGA 1993 Classification: Community Land

Total Land Area: 554 square metres

City of Sydney Interest: Freehold

Condition and Heritage

Condition: 3 - Average

☐ LEP Heritage Items

Available Park Facilities

- ☐ Playground
- ☐ Basketball Or Netball Structures
- ☐ Swimming Pool
- ☐ Car Park
- ☐ Turf Wicket
- ☐ Skate Ramp
- ☐ Changerooms Other Type Facility
- ☐ Sports Fields
- ☐ Concrete Wicket
- ☐ Tennis Courts

Categorisation s.36(4)

- ☒ General Community
- ☐ Natural Area
- ☐ Park
- ☐ Area of Cultural Significance
- ☐ Sportsground

Real Property Description

Lot 902 DP 10848

Supporting Occupations

Locality Map

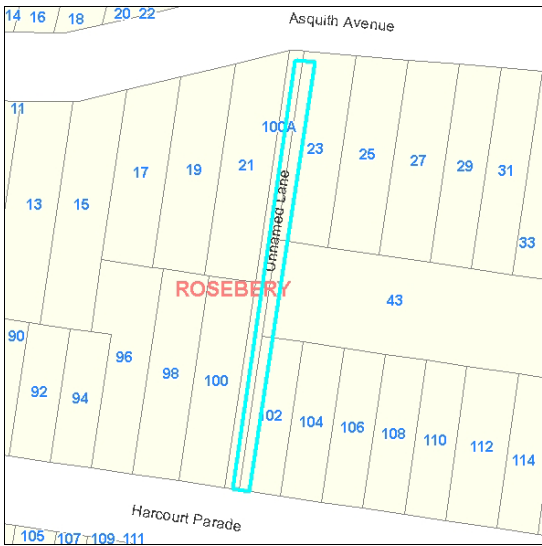

Site

Code: 189649

Name: Drainage Reserve

Suburb: Rosebery

Address: 113B Harcourt Parade, ROSEBERY, 2018

Detail

Owner: City Of Sydney

Property Type: Drainage Reserve

LGA 1993 Classification: Community Land

Total Land Area: 301 square metres

City of Sydney Interest: Freehold

Condition and Heritage

Condition: 3 - Average

☐ LEP Heritage Items

Available Park Facilities

- ☐ Playground
- ☐ Basketball Or Netball Structures
- ☐ Swimming Pool
- ☐ Car Park
- ☐ Turf Wicket
- ☐ Skate Ramp
- ☐ Changerooms Other Type Facility
- ☐ Sports Fields
- ☐ Concrete Wicket
- ☐ Tennis Courts

Categorisation s.36(4)

- ☒ General Community
- ☐ Natural Area
- ☐ Park
- ☐ Area of Cultural Significance
- ☐ Sportsground

Real Property Description

Lot 752 DP 7534

Supporting Occupations

Locality Map

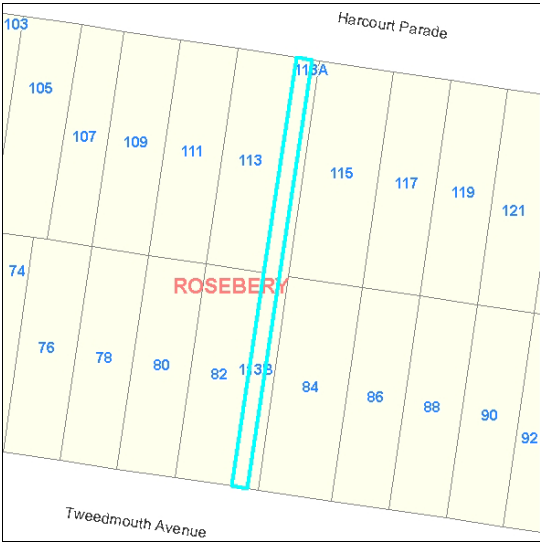

Site

Code: 189959

Name: Right of Way

Suburb: Newtown

Address: 29A Iredale Street, NEWTOWN, 2042

Detail

Owner: City Of Sydney

Property Type: Right of Way

LGA 1993 Classification: Community Land

Total Land Area: 38 square metres

City of Sydney Interest: Freehold

Condition and Heritage

Condition: 3 - Average

☐ LEP Heritage Items

Available Park Facilities

- ☐ Playground
- ☐ Basketball Or Netball Structures
- ☐ Swimming Pool
- ☐ Car Park
- ☐ Turf Wicket
- ☐ Skate Ramp
- ☐ Changerooms Other Type Facility
- ☐ Sports Fields
- ☐ Concrete Wicket
- ☐ Tennis Courts

Categorisation s.36(4)

- ☒ General Community
- ☐ Natural Area
- ☐ Park
- ☐ Area of Cultural Significance
- ☐ Sportsground

Real Property Description

Lot 6 DP 33148

Supporting Occupations

Locality Map

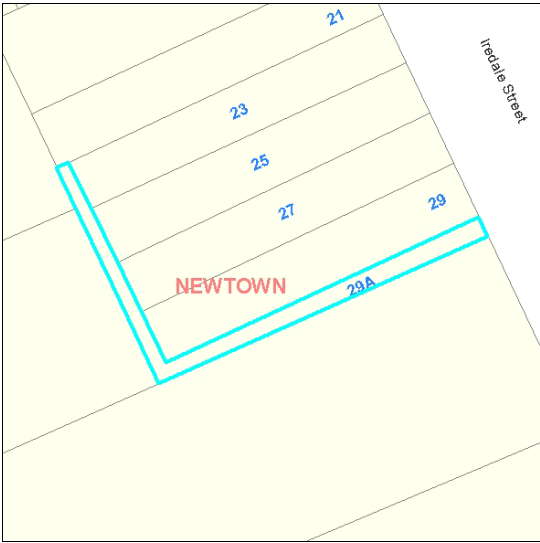



Site

Code: 192568

Name: Joe Sargeant Community Centre Suburb: Erskineville

Address: Joe Sargeant Community Centre, 60 Prospect Street, ERSKINEVILLE, 2043

Detail

Owner: City Of Sydney Property Type: Community Building - Community Centre

LGA 1993 Classification: Community Land Total Land Area: 794 square metres

City of Sydney Interest: Freehold

Condition and Heritage

Condition: 3 - Average ☐ LEP Heritage Items No of Buildings: 1

Available Park Facilities

☐ Playground ☐ Basketball Or Netball Structures ☐ Swimming Pool ☐ Car Park ☐ Turf Wicket

☐ Skate Ramp ☐ Changerooms Other Type Facility ☐ Sports Fields ☐ Concrete Wicket ☐ Tennis Courts

Categorisation s.36(4)

☒ General Community ☐ Natural Area ☐ Park ☐ Area of Cultural Significance ☐ Sportsground

Real Property Description

Lot 1 DP 109055

Supporting Occupations

Locality Map

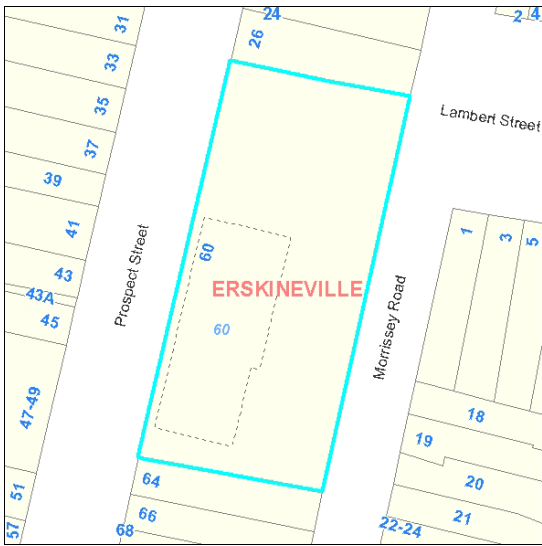

Site

Code: 193958

Name: Right Of Way

Suburb: Redfern

Address: 72-90 Telopea Street, REDFERN, 2016

Detail

Owner: City Of Sydney

Property Type: Right of Way

LGA 1993 Classification: Community Land

Total Land Area: 37 square metres

City of Sydney Interest: Freehold

Condition and Heritage

Condition: 3 - Average

☐ LEP Heritage Items

Available Park Facilities

☐ Playground

☐ Basketball Or Netball Structures

☐ Swimming Pool

☐ Car Park

☐ Turf Wicket

☐ Skate Ramp

☐ Changerooms Other Type Facility

☐ Sports Fields

☐ Concrete Wicket

☐ Tennis Courts

Categorisation s.36(4)

☒ General Community

☐ Natural Area

☐ Park

☐ Area of Cultural Significance

☐ Sportsground

Real Property Description

Lot 22 DP 33786

Supporting Occupations

Locality Map



## Rosebery Child Care Centre

**Code:** **201400**

## Site

Code: 201400

**Name:** Rosebery Child Care Centre

**Suburb:** Rosebery

**Address:** Rosebery Child Care Centre, 1 Harcourt Parade, ROSEBERY, 2018

### Detail

**Owner:** Crown

**Property Type:** Community Building - Child Care

**LGA 1993 Classification:** N/A

**Total Land Area:** 1906 square metres

**City of Sydney Interest:** Leasehold

## Condition and Heritage

Condition: 3 - Average

☐ LEP Heritage Items

**No of Buildings: 1**

### Available Park Facilities

☐ Playground    ☐ Basketball Or Netball Structures    ☐ Swimming Pool    ☐ Car Park    ☐ Turf Wicket

☐ Skate Ramp    ☐ Changerooms Other Type Facility    ☐ Sports Fields    ☐ Concrete Wicket    ☐ Tennis Courts

### Categorisation s.36(4)

☐ General Community   ☐ Natural Area   ☐ Park   ☐ Area of Cultural Significance   ☐ Sportsground

## Real Property Description

Lot 10 DP 813585

## Supporting Occupations

## Locality Map

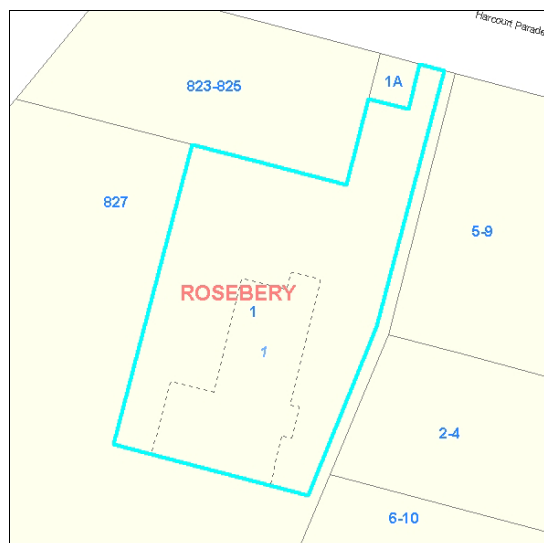

Alexandria Child Care Centre

Code: 202393

Site

Code: 202393

Name: Alexandria Child Care Centre

Suburb: Everleigh

Address: Alexandria Child Care Centre, 41 Henderson Road, EVELEIGH, 2015

Detail

Owner: City Of Sydney

Property Type: Community Building - Child Care

LGA 1993 Classification: Community Land

Total Land Area: 3459 square metres

City of Sydney Interest: Freehold

Condition and Heritage

Condition: 2 - Good

☐ LEP Heritage Items

No of Buildings: 1

Available Park Facilities

☐ Playground

☐ Basketball Or Netball Structures

☐ Swimming Pool

☐ Car Park

☐ Turf Wicket

☐ Skate Ramp

☐ Changerooms Other Type Facility

☐ Sports Fields

☐ Concrete Wicket

☐ Tennis Courts

Categorisation s.36(4)

☒ General Community

☐ Natural Area

☐ Park

☐ Area of Cultural Significance

☐ Sportsground

Real Property Description

Lot 51 DP 859192

Supporting Occupations

Locality Map

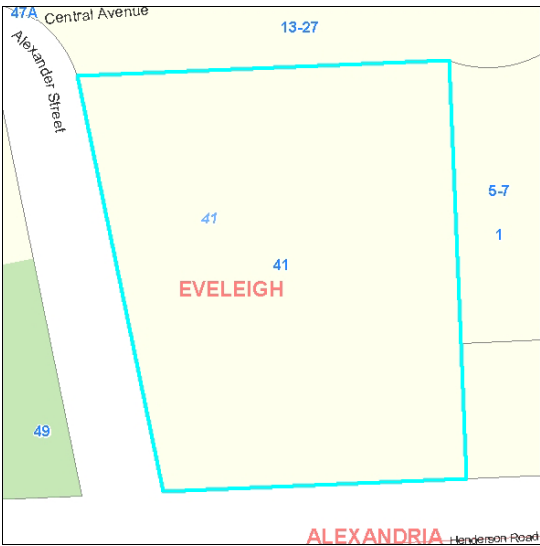

## Paddington Town Hall

**202773**

## Site

Code: 202773

**Suburb:** Paddington

**Address:** Paddington Town Hall, 247 Oxford Street, PADDINGTON, 2021

### Detail

**Property Type:** Multipurpose Facility

**Total Land Area:** 1985 square metres

## Condition and Heritage

☒ LEP Heritage Items

**No of Buildings: 1**

### Available Park Facilities

☐ Playground    ☐ Basketball Or Netball Structures    ☐ Swimming Pool    ☐ Car Park    ☐ Turf Wicket  
☐ Skate Ramp    ☐ Changerooms Other Type Facility    ☐ Sports Fields    ☐ Concrete Wicket    ☐ Tennis Courts

### Categorisation s.36(4)

☒ General Community ☐ Natural Area ☐ Park ☐ Area of Cultural Significance ☐ Sportsground

## Real Property Description

Lot 10 DP 867184

## Supporting Occupations

| Lease | Tenant | Tenant Name                 | Lease Description                             |
|-------|--------|-----------------------------|---|
| 1186  | 06320  | Woollahra Municipal Council | Ground Floor & Library, Paddington Town Hall  |
| 1523  | 05163  | Palace Cinema Nominees Pt   | Part Level 1 & 2, Paddington Town Hall        |
| 1712  | 04659  | Metro Screen Limited        | Part Grd floor, Paddington Town Hall          |
| 1713  | 04816  | Radio Eastern Sydney        | Ground & Basement Level, Paddington Town Hall |

## Locality Map



Site

Code: 202912

Name: Newtown Library Suburb: Newtown

Address: Newtown Library, 8-10 Brown Street, NEWTOWN, 2042

Detail

Owner: City Of Sydney Property Type: Community Building - Library

LGA 1993 Classification: Community Land Total Land Area: 770 square metres

City of Sydney Interest: Freehold

Condition and Heritage

Condition: 3 - Average ☒ LEP Heritage Items No of Buildings: 1

Available Park Facilities

- ☐ Playground
- ☐ Basketball Or Netball Structures
- ☐ Swimming Pool
- ☐ Car Park
- ☐ Turf Wicket
- ☐ Skate Ramp
- ☐ Changerooms Other Type Facility
- ☐ Sports Fields
- ☐ Concrete Wicket
- ☐ Tennis Courts

Categorisation s.36(4)

- ☒ General Community
- ☐ Natural Area
- ☐ Park
- ☐ Area of Cultural Significance
- ☐ Sportsground

Real Property Description

Lot 10 DP 871134

Supporting Occupations

| Lease | Tenant | Tenant Name         | Lease Description                       |
|-------|--------|---------------------|---|
| 1711  | 04750  | Women's Library Inc | Part of Newtown Library & Womens Centre |

Locality Map

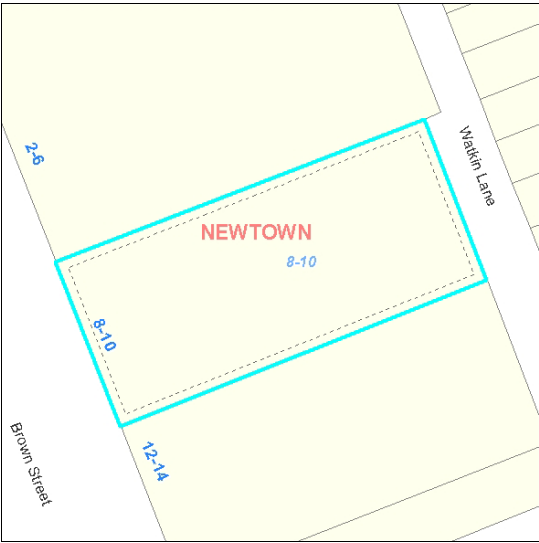

## Drainage Reserve

|                         |              |               |
|-------------------------|--------------|---------------|
| <b>Drainage Reserve</b> | <b>Code:</b> | <b>203142</b> |
|-------------------------|--------------|---------------|

## Site

Code: 203142

**Name:** Drainage Reserve **Suburb:** Surry Hills

**Address:** 727A Bourke Street, SURRY HILLS, 2010

### Detail

**Owner:** City Of Sydney **Property Type:** Drainage Reserve

**LGA 1993 Classification:** Community Land **Total Land Area:** 30 square metres

**City of Sydney Interest:** Freehold

## Condition and Heritage

**Condition:** 3 - Average ☐ LEP Heritage Items

### Available Park Facilities

☐ Playground    ☐ Basketball Or Netball Structures    ☐ Swimming Pool    ☐ Car Park    ☐ Turf Wicket  
☐ Skate Ramp    ☐ Changerooms Other Type Facility    ☐ Sports Fields    ☐ Concrete Wicket    ☐ Tennis Courts

### Categorisation s.36(4)

☒ General Community ☐ Natural Area ☐ Park ☐ Area of Cultural Significance ☐ Sportsground

## Real Property Description

Lot 1 DP 135583

## Supporting Occupations

## Locality Map



## Drainage Reserve

203383

## Site

### Detail

## Condition and Heritage

### Available Park Facilities

### Categorisation s.36(4)

## Real Property Description

## Supporting Occupations

## Locality Map

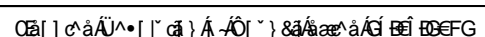



## Reserve

Code:

**203505**

### Site

Code: 203505

Name: Reserve

Suburb: Surry Hills

Address: 16B Parkham Street, SURRY HILLS, 2010

### Detail

Owner: City Of Sydney

Property Type: Reserve

LGA 1993 Classification: Community Land

Total Land Area: 12 square metres

City of Sydney Interest: Freehold

### Condition and Heritage

Condition: 3 - Average

☐ LEP Heritage Items

### Available Park Facilities

- ☐ Playground ☐ Basketball Or Netball Structures ☐ Swimming Pool ☐ Car Park ☐ Turf Wicket  
☐ Skate Ramp ☐ Changerooms Other Type Facility ☐ Sports Fields ☐ Concrete Wicket ☐ Tennis Courts

### Categorisation s.36(4)

- ☒ General Community ☐ Natural Area ☐ Park ☐ Area of Cultural Significance ☐ Sportsground

### Real Property Description

Part of C/T 2828 Folio 160

### Supporting Occupations

### Locality Map

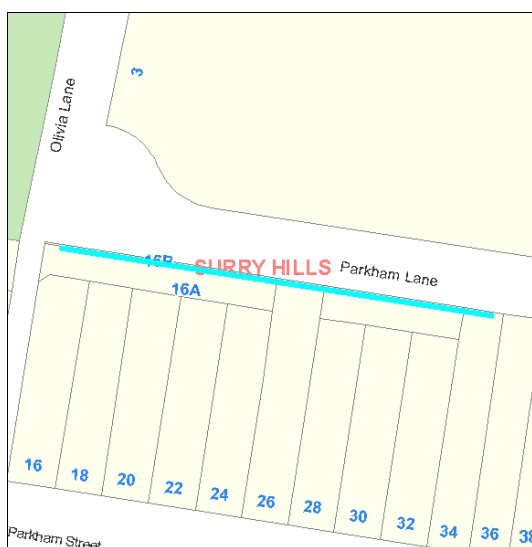

## Reserve

Code:

**203506**

### Site

Code: 203506

Name: Reserve

Suburb: Surry Hills

Address: 62B Parkham Street, SURRY HILLS, 2010

### Detail

Owner: City Of Sydney

Property Type: Reserve

LGA 1993 Classification: Community Land

Total Land Area: 2 square metres

City of Sydney Interest: Freehold

### Condition and Heritage

Condition: 3 - Average

☐ LEP Heritage Items

### Available Park Facilities

- ☐ Playground ☐ Basketball Or Netball Structures ☐ Swimming Pool ☐ Car Park ☐ Turf Wicket  
☐ Skate Ramp ☐ Changerooms Other Type Facility ☐ Sports Fields ☐ Concrete Wicket ☐ Tennis Courts

### Categorisation s.36(4)

- ☒ General Community ☐ Natural Area ☐ Park ☐ Area of Cultural Significance ☐ Sportsground

### Real Property Description

Part of C/T 2828 Folio 160

### Supporting Occupations

### Locality Map

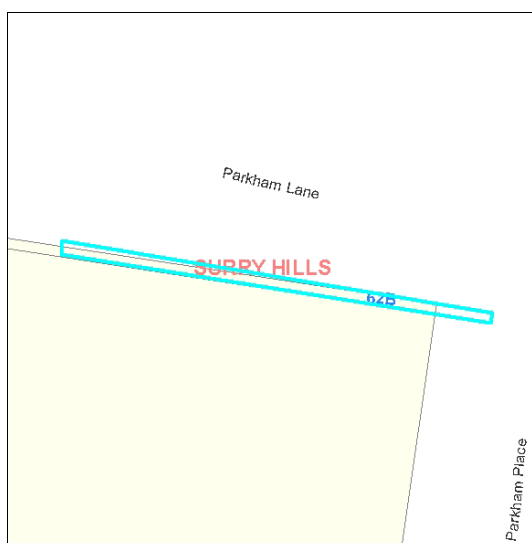

## South Link Park

Code: **255876**

### Site

Code: 255876

Name: South Link Park

Suburb: Waterloo

Address: 28A Crystal Street, WATERLOO, 2017

### Detail

Owner: City Of Sydney

Property Type: Pocket Park

LGA 1993 Classification: Community Land

Total Land Area: 721 square metres

City of Sydney Interest: Freehold

### Condition and Heritage

Condition: 3 - Average

☐ LEP Heritage Items

### Available Park Facilities

- ☐ Playground ☐ Basketball Or Netball Structures ☐ Swimming Pool ☐ Car Park ☐ Turf Wicket  
☐ Skate Ramp ☐ Changerooms Other Type Facility ☐ Sports Fields ☐ Concrete Wicket ☐ Tennis Courts

### Categorisation s.36(4)

- ☐ General Community ☐ Natural Area ☒ Park ☐ Area of Cultural Significance ☐ Sportsground

### Real Property Description

Lot 661 DP 1055716

### Supporting Occupations

### Locality Map



# Victoria Pk O'Dea Avenue Entrance Parks

Code: **255947**

## Site

Code: 255947

Name: Victoria Pk O'Dea Avenue Entrance Parks

Suburb: Zetland

Address: 98A Joynton Avenue, ZETLAND, 2017

## Detail

Owner: City Of Sydney

Property Type: Pocket Park

LGA 1993 Classification: Community Land

Total Land Area: 2786 square metres

City of Sydney Interest: Freehold

## Condition and Heritage

Condition: 3 - Average

☐ LEP Heritage Items

## Available Park Facilities

- ☐ Playground ☐ Basketball Or Netball Structures ☐ Swimming Pool ☐ Car Park ☐ Turf Wicket  
☐ Skate Ramp ☐ Changerooms Other Type Facility ☐ Sports Fields ☐ Concrete Wicket ☐ Tennis Courts

## Categorisation s.36(4)

- ☐ General Community ☐ Natural Area ☒ Park ☐ Area of Cultural Significance ☐ Sportsground

## Real Property Description

Lot 208 DP 1061965  
Lot 209 DP 1061965  
Lot 210 DP 1061965  
Lot 211 DP 1061965  
Lot 212 DP 1061965

Lot 207 DP 1061965

## Supporting Occupations

## Locality Map

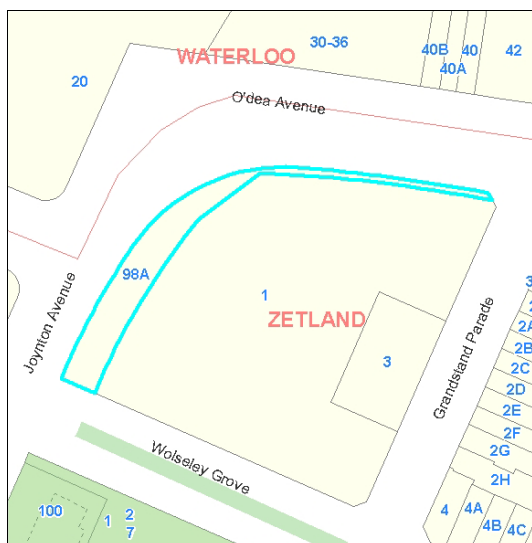

# North Link Park

Code: **257276**

## Site

Code: 257276

Name: North Link Park

Suburb: Waterloo

Address: 7A Broome Street, WATERLOO, 2017

## Detail

Owner: City Of Sydney

Property Type: Pocket Park

LGA 1993 Classification: Community Land

Total Land Area: 403 square metres

City of Sydney Interest: Freehold

## Condition and Heritage

Condition: 3 - Average

☐ LEP Heritage Items

## Available Park Facilities

- ☐ Playground ☐ Basketball Or Netball Structures ☐ Swimming Pool ☐ Car Park ☐ Turf Wicket  
☐ Skate Ramp ☐ Changerooms Other Type Facility ☐ Sports Fields ☐ Concrete Wicket ☐ Tennis Courts

## Categorisation s.36(4)

- ☐ General Community ☐ Natural Area ☒ Park ☐ Area of Cultural Significance ☐ Sportsground

## Real Property Description

Lot 542 DP 1069844

## Supporting Occupations

## Locality Map



# King George V Recreation Centre

Code: **512694**

## Site

Code: 512694

Name: King George V Recreation Centre

Suburb: The Rocks

Address: King George V Recreation Centre, 15 Cumberland Street, THE ROCKS, 2000

## Detail

Owner: Crown

Property Type: Community Building - Recreation Centre

LGA 1993 Classification: N/A

Total Land Area: 3417 square metres

City of Sydney Interest: Care and Control

## Condition and Heritage

Condition: 2 - Good

☐ LEP Heritage Items

No of Buildings: 1

## Available Park Facilities

- ☐ Playground ☐ Basketball Or Netball Structures ☐ Swimming Pool ☐ Car Park ☐ Turf Wicket  
☐ Skate Ramp ☐ Changerooms Other Type Facility ☐ Sports Fields ☐ Concrete Wicket ☐ Tennis Courts

## Categorisation s.36(4)

- ☐ General Community ☐ Natural Area ☐ Park ☐ Area of Cultural Significance ☐ Sportsground

## Real Property Description

Lot 2 DP 1164574

## Supporting Occupations

| Lease | Tenant | Tenant Name                  | Lease Description                       |
|-------|--------|------------------------------|---|
| 3045  | 06436  | Danielli's Fine Food Pty Ltd | Kiosk - King George V Recreation Centre |

## Locality Map

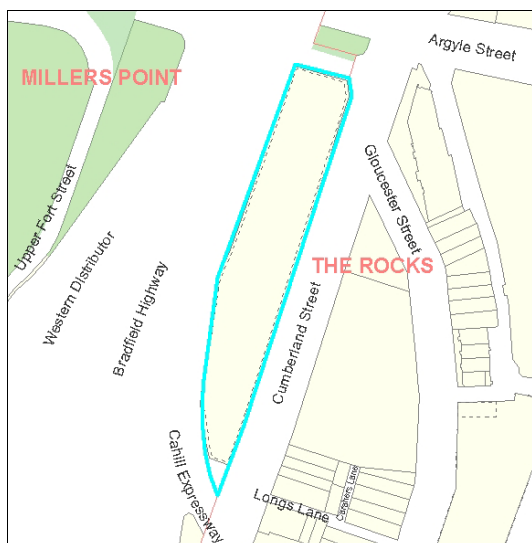

# Cumberland Street Depot

Code: **512698**

## Site

Code: 512698

Name: Cumberland Street Depot

Suburb: The Rocks

Address: Cumberland Street Depot, 9 Cumberland Street, THE ROCKS, 2000

## Detail

Owner: City Of Sydney

Property Type: Community Building - Depot

LGA 1993 Classification: Community Land

Total Land Area: 101 square metres

City of Sydney Interest: Freehold

## Condition and Heritage

Condition: 3 - Average

☐ LEP Heritage Items

## Available Park Facilities

- ☐ Playground ☐ Basketball Or Netball Structures ☐ Swimming Pool ☐ Car Park ☐ Turf Wicket  
☐ Skate Ramp ☐ Changerooms Other Type Facility ☐ Sports Fields ☐ Concrete Wicket ☐ Tennis Courts

## Categorisation s.36(4)

- ☐ General Community ☐ Natural Area ☒ Park ☐ Area of Cultural Significance ☐ Sportsground

## Real Property Description

Part Lot 108 DP 264104

## Supporting Occupations

## Locality Map

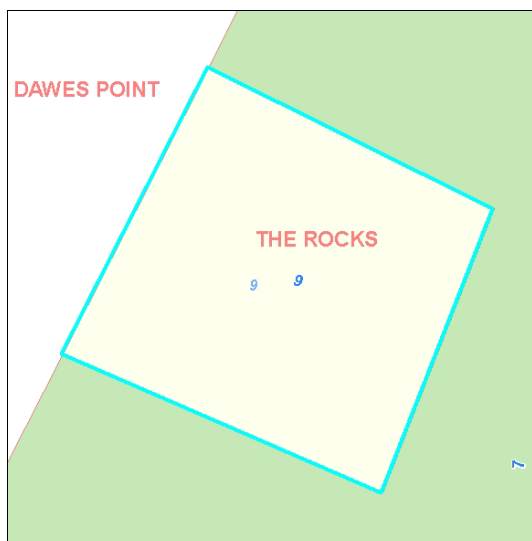

# Maybanke Recreation Centre

Code:

**513577**

## Site

**Code:** 513577

**Name:** Maybanke Recreation Centre

**Suburb:** Pyrmont

**Address:** Maybanke Recreation Centre, 87-97 Harris Street, PYRMONT, 2009

## Detail

**Owner:** City Of Sydney

**Property Type:** Community Building - Recreation Centre

**LGA 1993 Classification:** Community Land

**Total Land Area:** 2048 square metres

**City of Sydney Interest:** Freehold

## Condition and Heritage

**Condition:** 3 - Average

☒ LEP Heritage Items

**No of Buildings:** 1

## Available Park Facilities

- ☐ Playground ☐ Basketball Or Netball Structures ☐ Swimming Pool ☐ Car Park ☐ Turf Wicket  
☐ Skate Ramp ☐ Changerooms Other Type Facility ☐ Sports Fields ☐ Concrete Wicket ☐ Tennis Courts

## Categorisation s.36(4)

- ☒ General Community ☐ Natural Area ☐ Park ☐ Area of Cultural Significance ☐ Sportsground

## Real Property Description

Lot 5 DP 576037  
Lot 3 DP 576037  
Lot 6 DP 576037

## Supporting Occupations

## Locality Map

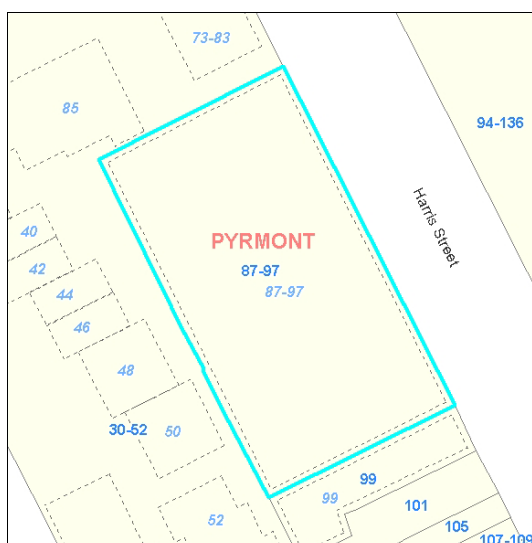



# Kent Street Tennis Centre

Code: **514266**

## Site

Code: 514266

Name: Kent Street Tennis Centre

Suburb: Millers Point

Address: Kent Street Tennis Centre, 96-108 Kent Street, MILLERS POINT, 2000

## Detail

Owner: Crown

Property Type: Community Building - Tennis Centre

LGA 1993 Classification: N/A

Total Land Area: 576 square metres

City of Sydney Interest: Reserve Trust Manager

## Condition and Heritage

Condition: 3 - Average

☐ LEP Heritage Items

No of Buildings: 1

## Available Park Facilities

- ☐ Playground ☐ Basketball Or Netball Structures ☐ Swimming Pool ☐ Car Park ☐ Turf Wicket  
☐ Skate Ramp ☐ Changerooms Other Type Facility ☐ Sports Fields ☐ Concrete Wicket ☒ Tennis Courts

## Categorisation s.36(4)

- ☐ General Community ☐ Natural Area ☐ Park ☐ Area of Cultural Significance ☐ Sportsground

## Real Property Description

Part Lot 7003 DP 1071940

## Supporting Occupations

| Lease | Tenant | Tenant Name                  | Lease Description                          |
|-------|--------|------------------------------|--|
| 998   | 23380  | The Observatory Hotel Pty Lt | Land - Kent St (aka Kent St Tennis Courts) |

## Locality Map

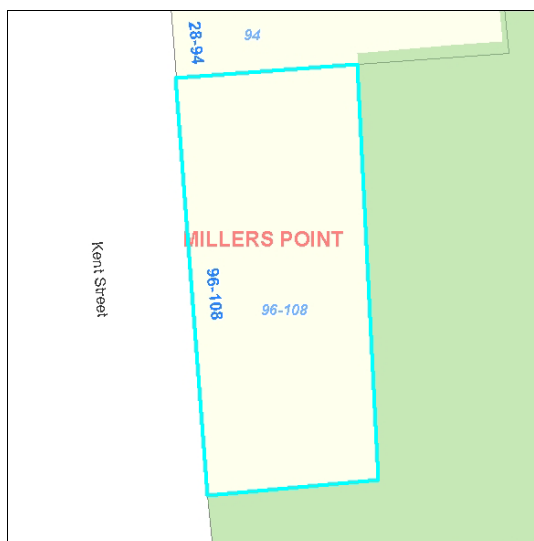

# Watson Road Public Toilets

Code: **515855**

## Site

Code: 515855

Name: Watson Road Public Toilets

Suburb: Millers Point

Address: Watson Road Public Toilets, 1 Watson Road, MILLERS POINT, 2000

## Detail

Owner: Crown

Property Type: Community Building - Public Toilet

LGA 1993 Classification: N/A

Total Land Area: 29 square metres

City of Sydney Interest: Reserve Trust Manager

## Condition and Heritage

Condition: 4 - Poor

☐ LEP Heritage Items

No of Buildings: 1

## Available Park Facilities

- ☐ Playground ☐ Basketball Or Netball Structures ☐ Swimming Pool ☐ Car Park ☐ Turf Wicket  
☐ Skate Ramp ☐ Changerooms Other Type Facility ☐ Sports Fields ☐ Concrete Wicket ☐ Tennis Courts

## Categorisation s.36(4)

- ☐ General Community ☐ Natural Area ☐ Park ☐ Area of Cultural Significance ☐ Sportsground

## Real Property Description

Lot 1 DP 1164047

## Supporting Occupations

## Locality Map

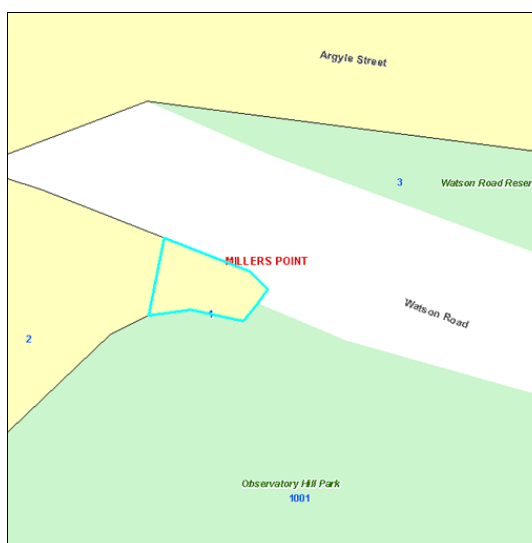

# Millers Point Activity Centre

Code:

**515856**

## Site

**Code:** 515856

**Name:** Millers Point Activity Centre

**Suburb:** Millers Point

**Address:** Millers Point Activity Centre, 2 Watson Road, MILLERS POINT, 2000

## Detail

**Owner:** Crown

**Property Type:** Community Building - Activity Centre

**LGA 1993 Classification:** N/A

**Total Land Area:** 2140 square metres

**City of Sydney Interest:** Reserve Trust Manager

## Condition and Heritage

**Condition:** 3 - Average

☐ LEP Heritage Items

**No of Buildings:** 3

## Available Park Facilities

- |                                     |   |  |  |  |
|-------------------------------------|---|--|--|--|
| <input type="checkbox"/> Playground | <input type="checkbox"/> Basketball Or Netball Structures | <input type="checkbox"/> Swimming Pool | <input type="checkbox"/> Car Park        | <input type="checkbox"/> Turf Wicket   |
| <input type="checkbox"/> Skate Ramp | <input type="checkbox"/> Changerooms Other Type Facility  | <input type="checkbox"/> Sports Fields | <input type="checkbox"/> Concrete Wicket | <input type="checkbox"/> Tennis Courts |

## Categorisation s.36(4)

- ☐ General Community ☐ Natural Area ☐ Park ☐ Area of Cultural Significance ☐ Sportsground

## Real Property Description

Lot 7301 DP 1163733

## Supporting Occupations

## Locality Map

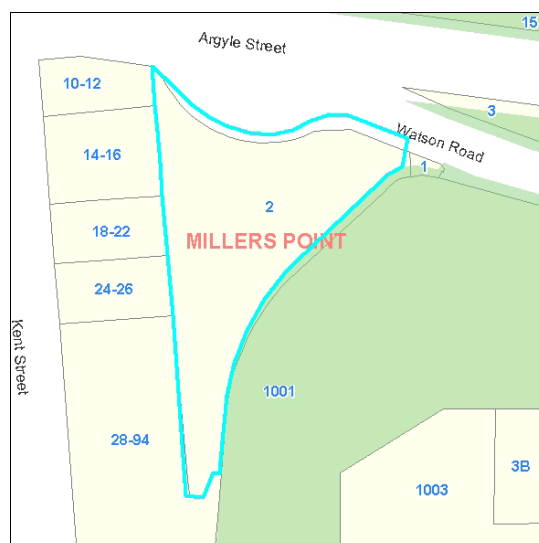

# Andrew Boy Charlton Pool

Code:

**516192**

## Site

Code: 516192

Name: Andrew Boy Charlton Pool

Suburb: Sydney

Address: Andrew Boy Charlton Pool, 1C Mrs Macquaries Road, SYDNEY, 2000

## Detail

Owner: Crown

Property Type: Community Building - Pool

LGA 1993 Classification: N/A

Total Land Area: 3676 square metres

City of Sydney Interest: Care and Control

## Condition and Heritage

Condition: 2 - Good

☐ LEP Heritage Items

No of Buildings: 1

## Available Park Facilities

- ☐ Playground ☐ Basketball Or Netball Structures ☒ Swimming Pool ☐ Car Park ☐ Turf Wicket  
☐ Skate Ramp ☐ Changerooms Other Type Facility ☐ Sports Fields ☐ Concrete Wicket ☐ Tennis Courts

## Categorisation s.36(4)

- ☐ General Community ☐ Natural Area ☐ Park ☐ Area of Cultural Significance ☐ Sportsground

## Real Property Description

part of land in CT Vol 5018 Folio 1

## Supporting Occupations

| Lease | Tenant | Tenant Name    | Lease Description        |
|-------|--------|----------------|--------------------------|
| 1082S | CoS    | City of Sydney | Andrew Boy Charlton Pool |

## Locality Map



# Stone Retaining Wall, 1B High Street

Code: **517170**

## Site

Code: 517170

Name: Stone Retaining Wall, 1B High Street

Suburb: Millers Point

Address: Stone Retaining Wall, 1B High Street , MILLERS POINT NSW 20001B High Street

## Detail

Owner: City Of Sydney

Property Type: Retaining Wall

LGA 1993 Classification: Community Land

Total Land Area: 176 square metres

City of Sydney Interest: Freehold

## Condition and Heritage

Condition: 3 - Average

☐ LEP Heritage Items

## Available Park Facilities

- ☐ Playground ☐ Basketball Or Netball Structures ☐ Swimming Pool ☐ Car Park ☐ Turf Wicket  
☐ Skate Ramp ☐ Changerooms Other Type Facility ☐ Sports Fields ☐ Concrete Wicket ☐ Tennis Courts

## Categorisation s.36(4)

- ☒ General Community ☐ Natural Area ☐ Park ☐ Area of Cultural Significance ☐ Sportsground

## Real Property Description

Lot 2 DP869022

## Supporting Occupations

## Locality Map



# Cathedral Street Car Park

Code: **517255**

## Site

Code: 517255

Name: Cathedral Street Car Park

Suburb: Sydney

Address: Cathedral Street Car Park, 1 Cathedral Street, SYDNEY, 2000

## Detail

Owner: Crown

Property Type: Community Building - Car Park

LGA 1993 Classification: N/A

Total Land Area: 2670 square metres

City of Sydney Interest: Leasehold

## Condition and Heritage

Condition: 3 - Average

☐ LEP Heritage Items

No of Buildings: 1

## Available Park Facilities

- ☐ Playground ☐ Basketball Or Netball Structures ☐ Swimming Pool ☒ Car Park ☐ Turf Wicket  
☐ Skate Ramp ☐ Changerooms Other Type Facility ☐ Sports Fields ☐ Concrete Wicket ☐ Tennis Courts

## Categorisation s.36(4)

- ☐ General Community ☐ Natural Area ☐ Park ☐ Area of Cultural Significance ☐ Sportsground

## Real Property Description

Lot 1 DP 873273

## Supporting Occupations

## Locality Map

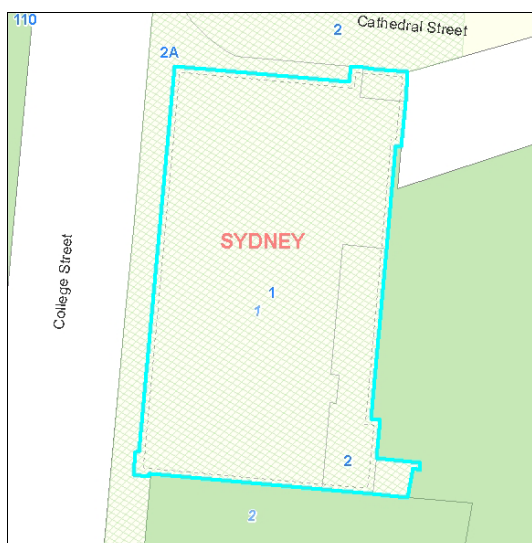

# Cook & Phillip Park Aquatic Centre

Code:

**517256**

## Site

Code: 517256

Name: Cook & Phillip Park Aquatic Centre

Suburb: Sydney

Address: Cook & Phillip Park Aquatic Centre, 2 College Street, SYDNEY, 2000

## Detail

Owner: Crown

Property Type: Community Building - Pool

LGA 1993 Classification: N/A

Total Land Area: 6427 square metres

City of Sydney Interest: Leasehold

## Condition and Heritage

Condition: 2 - Good

☐ LEP Heritage Items

No of Buildings: 1

## Available Park Facilities

- ☐ Playground ☐ Basketball Or Netball Structures ☒ Swimming Pool ☐ Car Park ☐ Turf Wicket  
☐ Skate Ramp ☐ Changerooms Other Type Facility ☐ Sports Fields ☐ Concrete Wicket ☐ Tennis Courts

## Categorisation s.36(4)

- ☐ General Community ☐ Natural Area ☐ Park ☐ Area of Cultural Significance ☐ Sportsground

## Real Property Description

Lot 21 DP 1082638

## Supporting Occupations

| Lease | Tenant | Tenant Name              | Lease Description                             |
|-------|--------|--------------------------|---|
| 991   | 69980  | Wynmore Services Pty Ltd | Cafe-Adjoining Cook & Phillip Park Aquatic Ce |

## Locality Map

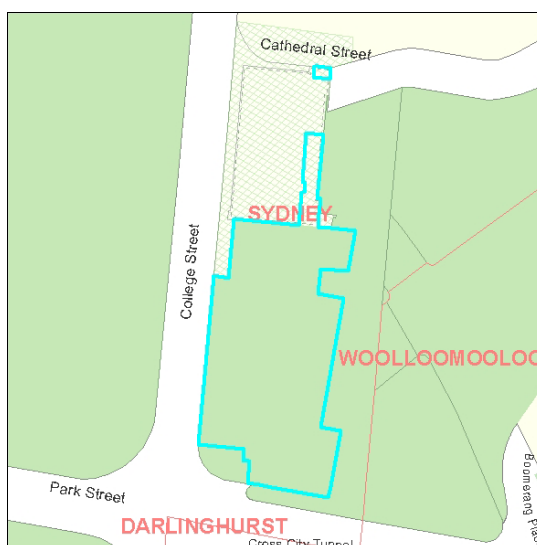

# St Helens Community Centre and Nurses Quarters

Code: **518652**

## Site

Code: 518652

Name: St Helens Community Centre and Nurses Quarters

Suburb: Glebe

Address: St Helens Community Centre and Nurses Quarters, 184 Glebe Point Road, GLEBE, 2037

## Detail

Owner: City Of Sydney

Property Type: Community Building - Community Centre

LGA 1993 Classification: Community Land

Total Land Area: 2002 square metres

City of Sydney Interest: Freehold

## Condition and Heritage

Condition: 3 - Average

☒ LEP Heritage Items

No of Buildings: 2

## Available Park Facilities

- ☐ Playground ☐ Basketball Or Netball Structures ☐ Swimming Pool ☐ Car Park ☐ Turf Wicket  
☐ Skate Ramp ☐ Changerooms Other Type Facility ☐ Sports Fields ☐ Concrete Wicket ☐ Tennis Courts

## Categorisation s.36(4)

- ☒ General Community ☐ Natural Area ☐ Park ☐ Area of Cultural Significance ☐ Sportsground

## Real Property Description

Lot 102 DP 852944

## Supporting Occupations

| Lease | Tenant | Tenant Name                    | Lease Description                            |
|-------|--------|--------------------------------|--|
| 1122  | 06111  | Sydney South West Area He      | Glebe Community Centre - St Helens Centre &  |
| 1199  | 02516  | Glebe Chamber Of Commere       | Rear of Glebe Community Centre - Nurses Qua  |
| 1709  | 02494  | Physical Disability Council of | Rm 6 - Glebe Comm Cntr - St Helens & Nurses  |
| 1710  | 04870  | Radio for the Print Handicapp  | Lvl 1 - Glebe Comm Cntr - St Helens & Nurses |
| 1895  | 02495  | Recreation And Peer Support    | Rm 4 - Glebe Comm Cntr - St Helens & Nurses  |

## Locality Map

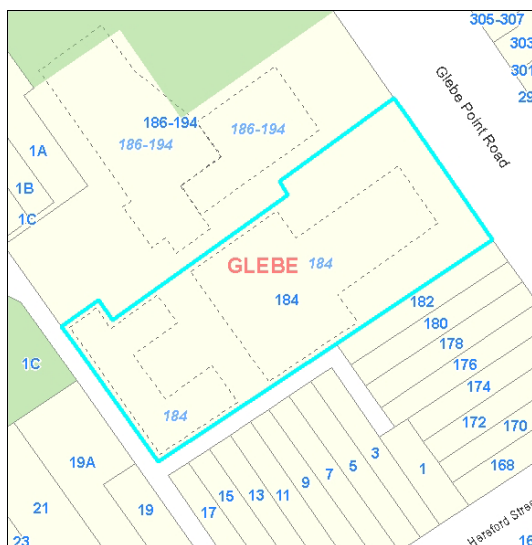



# Glebe Library and Benledi House

Code: **518655**

## Site

Code: 518655

Name: Glebe Library and Benledi House

Suburb: Glebe

Address: Glebe Library and Benledi House, 186-194 Glebe Point Road, GLEBE, 2037

## Detail

Owner: City Of Sydney

Property Type: Community Building - Library

LGA 1993 Classification: Community Land

Total Land Area: 3388 square metres

City of Sydney Interest: Freehold

## Condition and Heritage

Condition: 3 - Average

☒ LEP Heritage Items

No of Buildings: 2

## Available Park Facilities

- ☐ Playground ☐ Basketball Or Netball Structures ☐ Swimming Pool ☐ Car Park ☐ Turf Wicket  
☐ Skate Ramp ☐ Changerooms Other Type Facility ☐ Sports Fields ☐ Concrete Wicket ☐ Tennis Courts

## Categorisation s.36(4)

- ☒ General Community ☐ Natural Area ☒ Park ☐ Area of Cultural Significance ☐ Sportsground

## Real Property Description

Lot 101 DP 852944

## Supporting Occupations

## Locality Map

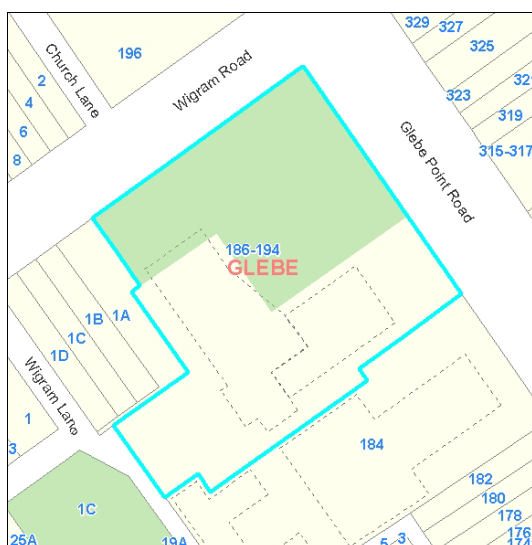

## Workshop

Code:

**522392**

### Site

Code: 522392

Name: Workshop

Suburb: Glebe

Address: Workshop, 50 Glebe Street, GLEBE, 2037

### Detail

Owner: Crown

Property Type: Community Building

LGA 1993 Classification: N/A

Total Land Area: 243 square metres

City of Sydney Interest: Care and Control

### Condition and Heritage

Condition: 5 - Very Poor

☐ LEP Heritage Items

No of Buildings: 1

### Available Park Facilities

- ☐ Playground ☐ Basketball Or Netball Structures ☐ Swimming Pool ☐ Car Park ☐ Turf Wicket  
☐ Skate Ramp ☐ Changerooms Other Type Facility ☐ Sports Fields ☐ Concrete Wicket ☐ Tennis Courts

### Categorisation s.36(4)

- ☐ General Community ☐ Natural Area ☐ Park ☐ Area of Cultural Significance ☐ Sportsground

### Real Property Description

Lot 101 DP 1086782

### Supporting Occupations

### Locality Map



## Reserve - 210 Barcom Ave Darlinghurst

Code:

**524357**

### Site

Code: 524357

Name: Reserve - 210 Barcom Ave Darlinghurst

Suburb: Darlinghurst

Address: 210 Barcom Avenue, DARLINGHURST, 2010

### Detail

Owner: City Of Sydney

Property Type: Reserve

LGA 1993 Classification: Community Land

Total Land Area: 131 square metres

City of Sydney Interest: Freehold

### Condition and Heritage

Condition: 3 - Average

☐ LEP Heritage Items

### Available Park Facilities

- |                                     |   |  |  |  |
|-------------------------------------|---|--|--|--|
| <input type="checkbox"/> Playground | <input type="checkbox"/> Basketball Or Netball Structures | <input type="checkbox"/> Swimming Pool | <input type="checkbox"/> Car Park        | <input type="checkbox"/> Turf Wicket   |
| <input type="checkbox"/> Skate Ramp | <input type="checkbox"/> Changerooms Other Type Facility  | <input type="checkbox"/> Sports Fields | <input type="checkbox"/> Concrete Wicket | <input type="checkbox"/> Tennis Courts |

### Categorisation s.36(4)

- ☐ General Community ☐ Natural Area ☒ Park ☐ Area of Cultural Significance ☐ Sportsground

### Real Property Description

Lot 1 DP 134778

### Supporting Occupations

### Locality Map

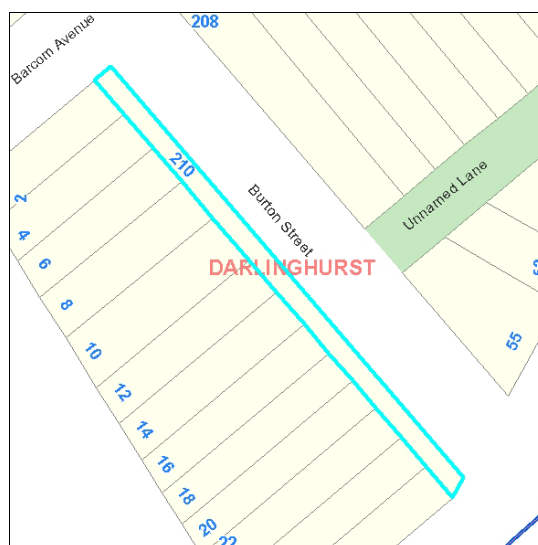

## Right of Way

Code:

**529314**

### Site

Code: 529314

Name: Right of Way

Suburb: Darlinghurst

Address: 317A Liverpool Street, DARLINGHURST, 2010

### Detail

Owner: City Of Sydney

Property Type: Right of Way

LGA 1993 Classification: Community Land

Total Land Area: 294 square metres

City of Sydney Interest: Freehold

### Condition and Heritage

Condition: 3 - Average

☐ LEP Heritage Items

### Available Park Facilities

- ☐ Playground ☐ Basketball Or Netball Structures ☐ Swimming Pool ☐ Car Park ☐ Turf Wicket  
☐ Skate Ramp ☐ Changerooms Other Type Facility ☐ Sports Fields ☐ Concrete Wicket ☐ Tennis Courts

### Categorisation s.36(4)

- ☒ General Community ☐ Natural Area ☐ Park ☐ Area of Cultural Significance ☐ Sportsground

### Real Property Description

Lot 45 DP 32355

### Supporting Occupations

### Locality Map

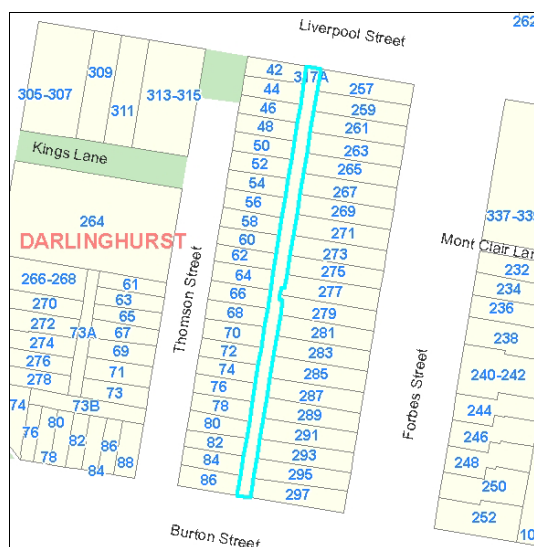

# 73A Thomson St Darlinghurst Lt2 DP1084991

Code: **531746**

## Site

Code: 531746

Name: 73A Thomson St Darlinghurst Lt2 DP1084991

Suburb: Darlinghurst

Address: 73A Thomson Street, DARLINGHURST, 2010

## Detail

Owner: Crown

Property Type:

LGA 1993 Classification: N/A

Total Land Area: square metres

City of Sydney Interest: None

## Condition and Heritage

Condition:

☐ LEP Heritage Items

## Available Park Facilities

- ☐ Playground ☐ Basketball Or Netball Structures ☐ Swimming Pool ☐ Car Park ☐ Turf Wicket  
☐ Skate Ramp ☐ Changerooms Other Type Facility ☐ Sports Fields ☐ Concrete Wicket ☐ Tennis Courts

## Categorisation s.36(4)

- ☐ General Community ☐ Natural Area ☐ Park ☐ Area of Cultural Significance ☐ Sportsground

## Real Property Description

Lot 10 DP 1002834

## Supporting Occupations

## Locality Map

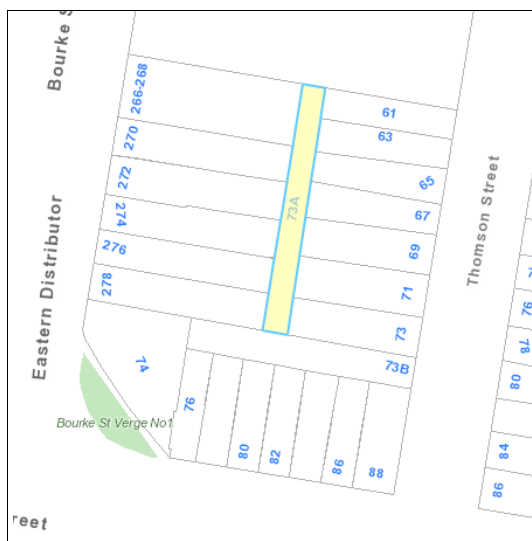

# High Street Park

Code:

**598199**

## Site

Code: 598199

Name: High Street Park

Suburb: Millers Point

Address: 1-1A High Street, MILLERS POINT, 2000

## Detail

Owner: City Of Sydney

Property Type: Pocket Park

LGA 1993 Classification: Community Land

Total Land Area: 144 square metres

City of Sydney Interest: Freehold

## Condition and Heritage

Condition: 3 - Average

☐ LEP Heritage Items

## Available Park Facilities

- ☐ Playground ☐ Basketball Or Netball Structures ☐ Swimming Pool ☐ Car Park ☐ Turf Wicket  
☐ Skate Ramp ☐ Changerooms Other Type Facility ☐ Sports Fields ☐ Concrete Wicket ☐ Tennis Courts

## Categorisation s.36(4)

- ☐ General Community ☐ Natural Area ☒ Park ☐ Area of Cultural Significance ☐ Sportsground

## Real Property Description

Lot 10 DP 1065410

## Supporting Occupations

## Locality Map



## Road widening

Code:

**599115**

### Site

Code: 599115

Name: Road widening

Suburb: Ultimo

Address: 111A Quarry Street, ULTIMO, 2007

### Detail

Owner: City Of Sydney

Property Type: Road Widening

LGA 1993 Classification: Community Land

Total Land Area: 21 square metres

City of Sydney Interest: Freehold

### Condition and Heritage

Condition: 3 - Average

☐ LEP Heritage Items

### Available Park Facilities

- ☐ Playground ☐ Basketball Or Netball Structures ☐ Swimming Pool ☐ Car Park ☐ Turf Wicket  
☐ Skate Ramp ☐ Changerooms Other Type Facility ☐ Sports Fields ☐ Concrete Wicket ☐ Tennis Courts

### Categorisation s.36(4)

- ☒ General Community ☐ Natural Area ☐ Park ☐ Area of Cultural Significance ☐ Sportsground

### Real Property Description

Lot 4 DP 1031381

### Supporting Occupations

### Locality Map

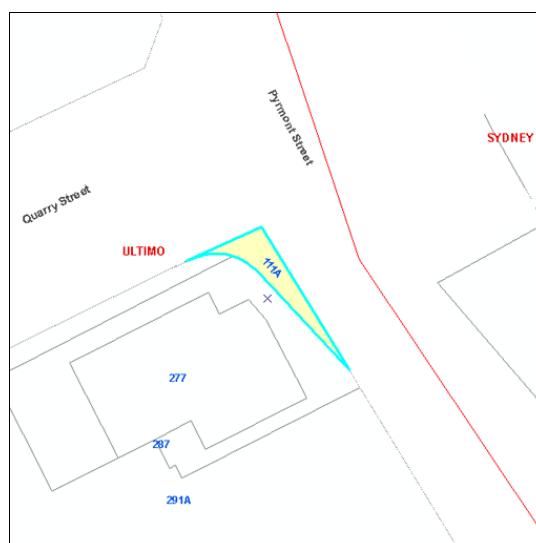

## Through site link

Code: **601137**

### Site

Code: 601137

Name: Through site link

Suburb: Ultimo

Address: 456B Harris Street, ULTIMO, 2007

### Detail

Owner: City Of Sydney

Property Type: Through Site Link

LGA 1993 Classification: Community Land

Total Land Area: 828 square metres

City of Sydney Interest: Freehold

### Condition and Heritage

Condition: 3 - Average

☐ LEP Heritage Items

### Available Park Facilities

- ☐ Playground ☐ Basketball Or Netball Structures ☐ Swimming Pool ☐ Car Park ☐ Turf Wicket  
☐ Skate Ramp ☐ Changerooms Other Type Facility ☐ Sports Fields ☐ Concrete Wicket ☐ Tennis Courts

### Categorisation s.36(4)

- ☒ General Community ☐ Natural Area ☐ Park ☐ Area of Cultural Significance ☐ Sportsground

### Real Property Description

Lot 9 DP 1067958

### Supporting Occupations

### Locality Map

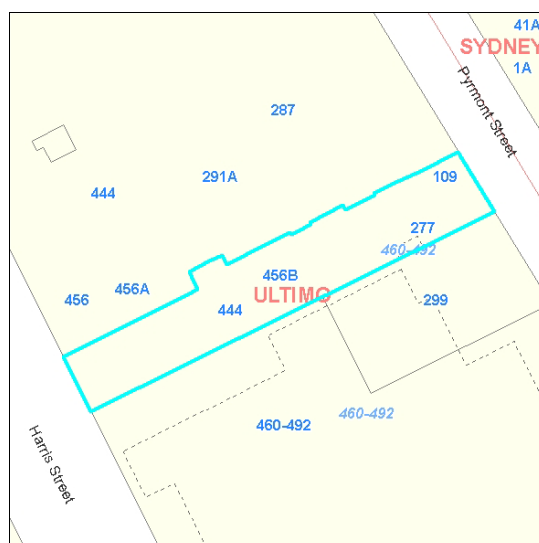



## Community Space (Heritage Strata Unit)

Code:

**606173**

### Site

**Code:** 606173

**Name:** Community Space (Heritage Strata Unit)

**Suburb:** Woolloomooloo

**Address:** Community Space (Heritage Strata Unit), Basement B1 70B William Street, WOOLLOOMOOLOO, 2011

### Detail

**Owner:** City Of Sydney

**Property Type:** Community Building

**LGA 1993 Classification:** Community Land

**Total Land Area:** 84 square metres

**City of Sydney Interest:** Stratum

### Condition and Heritage

**Condition:** 2 - Good

☒ LEP Heritage Items

**No of Buildings:** 1

### Available Park Facilities

- ☐ Playground ☐ Basketball Or Netball Structures ☐ Swimming Pool ☐ Car Park ☐ Turf Wicket  
☐ Skate Ramp ☐ Changerooms Other Type Facility ☐ Sports Fields ☐ Concrete Wicket ☐ Tennis Courts

### Categorisation s.36(4)

- ☒ General Community ☐ Natural Area ☐ Park ☐ Area of Cultural Significance ☐ Sportsground

### Real Property Description

Lot 3 DP 1084085

### Supporting Occupations

### Locality Map



# Fish Market Light Rail Lift

Code: **616466**

## Site

Code: 616466

Name: Fish Market Light Rail Lift

Suburb: Pyrmont

Address: Fish Market Light Rail Lift, 55A Miller Street, PYRMONT, 2009

## Detail

Owner: City Of Sydney

Property Type: Community Building - Lift

LGA 1993 Classification: Community Land

Total Land Area: 2131 square metres

City of Sydney Interest: Freehold

## Condition and Heritage

Condition: 1- Excellent

☐ LEP Heritage Items

No of Buildings: 1

## Available Park Facilities

- ☐ Playground ☐ Basketball Or Netball Structures ☐ Swimming Pool ☐ Car Park ☐ Turf Wicket  
☐ Skate Ramp ☐ Changerooms Other Type Facility ☐ Sports Fields ☐ Concrete Wicket ☐ Tennis Courts

## Categorisation s.36(4)

- ☒ General Community ☐ Natural Area ☐ Park ☐ Area of Cultural Significance ☐ Sportsground

## Real Property Description

Lot 1024 DP 1104364

## Supporting Occupations

## Locality Map

